

- NOTES:
- THIS PLAN HAS BEEN PREPARED FOR INFORMATION PURPOSES ONLY. NO DETAILED DESIGN SHOULD BE UNDERTAKEN UTILISING THIS DATA.
 - THIS PLAN DOES NOT SHOW ANY INFORMATION ABOUT INSTRUMENTS REGISTERED AGAINST THE EXISTING RECORDS OF TITLE OR ANY PROPOSED EASEMENTS, COVENANTS OR OTHER FUTURE INSTRUMENTS.
 - THIS PLAN IS ISSUED FOR A SPECIFIC PROJECT AND MAY NOT BE ALTERED OR USED FOR ANY OTHER PURPOSE WITHOUT THE PRIOR WRITTEN CONSENT OF ENVELOPE ENGINEERING.
 - EXISTING BOUNDARIES SHOWN ON THIS PLAN ARE FROM LAND INFORMATION DCDB (104/05/2022) AND HAVE NOT BEEN SURVEYED. A BOUNDARY DEFINITION SURVEY SHOULD BE CARRIED OUT TO ESTABLISH EXACT BOUNDARY POSITIONS ON SITE.
 - LEGAL DESCRIPTION:
LOT 2 DP 548977 (COMPRISED IN RT 942889) 55.3822 Ha.

LOT 1 DP 548977 (COMPRISED IN RT 942888) 4.4352 Ha.
SUBJECT TO:

TOTAL AREA BOTH TITLES: 59.8174 Ha.
 - THESE NOTES ARE AN INTEGRAL PART OF THIS PLAN.

- RESIDENTIAL DWELLINGS:
- OPTION 1:
 - 574 INDIVIDUAL DWELLINGS
 - OPTION 2:
 - 414 INDIVIDUAL DWELLINGS
 - COMBINED TOTAL AREA OF RESIDENTIAL LOTS: 10.7606 ha

OPEN SPACE AREA TABLE (DEFINITION OF THE PUBLIC/PRIVATE RESERVE AREAS TO BE CONFIRMED)		
TYPE	LOT NUMBERS	AREA
PARK	300 TO 305	5.8528 Ha
POCKET PARK	350 TO 356	0.4243 Ha
COMBINED AREA	300 TO 305 AND 350 TO 356	6.2771 Ha

This design and drawing shall only be used for the purpose for which it was supplied and shall not be altered or reproduced without the permission of Envelope Engineering Limited. No liability shall be accepted for unauthorised use of this design and drawing.

REVISIONS:		BY	DATE
REV	NOTES		
P1	PRELIMINARY ISSUE	JEG	26.07.2022
P2	LOT IDENTIFIERS CHANGED	JEG	11.08.2022
P3	LOT BOUNDARIES AMENDED	MJP	27-10-2022

PROJECT:
OTAKI REVISITED LIMITED
OTAKI MAORI RACECOURSE,
57 RAHUI ROAD, OTAKI.

TITLE:
DEVELOPMENT LOT OVERVIEW



DESIGNED: JEG	DRAWN: JEG	REVISION:
CHECKED: EFC	PLOT DATE: 27-10-2022	
SCALE A1: 1:2000	SCALE A3: 1:4000	
STATUS: PRELIMINARY		
PROJECT No: 1733-01	DRAWING No: SK004	P3

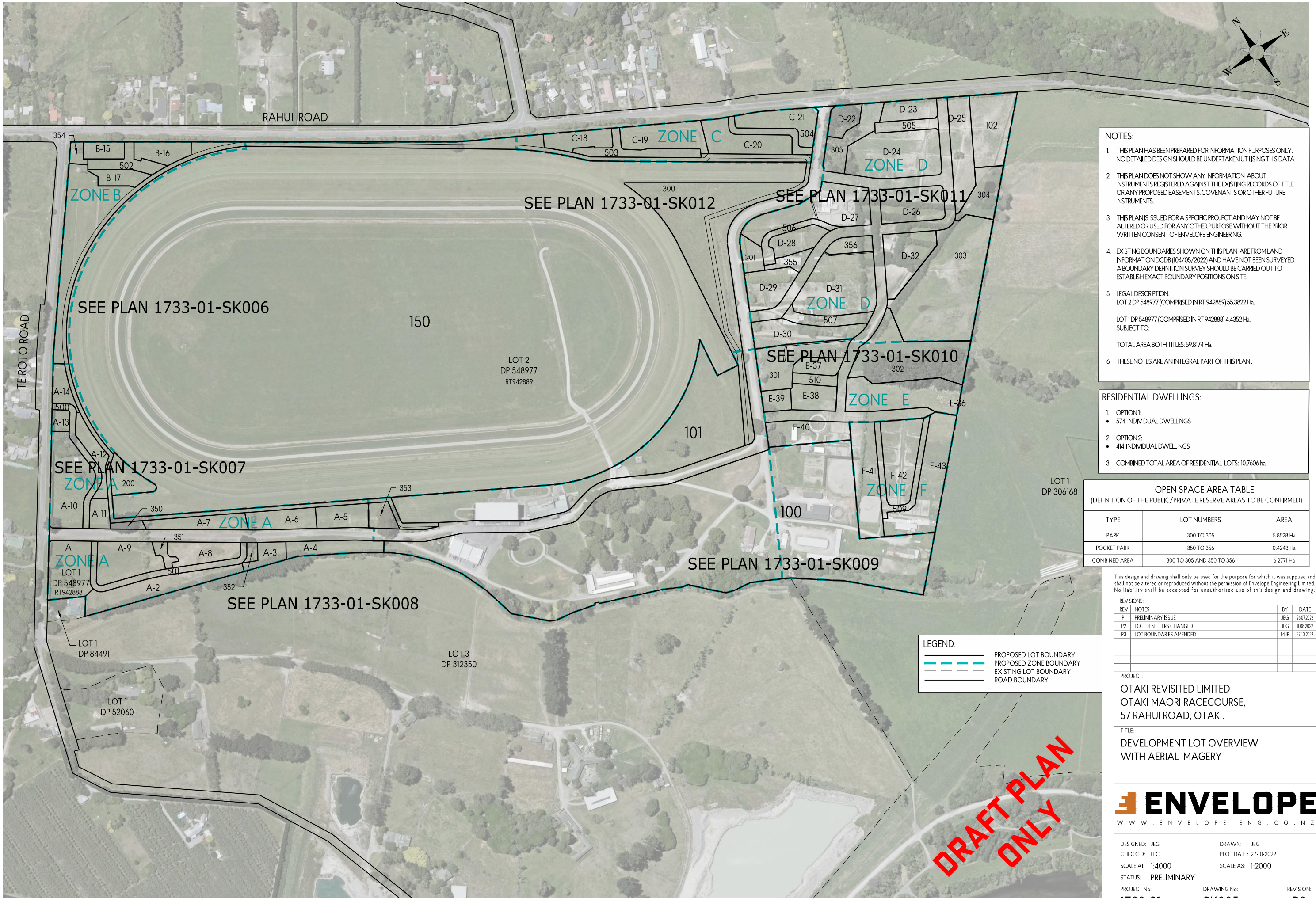

- NOTES:
1. THIS PLAN HAS BEEN PREPARED FOR INFORMATION PURPOSES ONLY. NO DETAILED DESIGN SHOULD BE UNDERTAKEN UTILISING THIS DATA.
 2. THIS PLAN DOES NOT SHOW ANY INFORMATION ABOUT INSTRUMENTS REGISTERED AGAINST THE EXISTING RECORDS OF TITLE OR ANY PROPOSED EASEMENTS, COVENANTS OR OTHER FUTURE INSTRUMENTS.
 3. THIS PLAN IS ISSUED FOR A SPECIFIC PROJECT AND MAY NOT BE ALTERED OR USED FOR ANY OTHER PURPOSE WITHOUT THE PRIOR WRITTEN CONSENT OF ENVELOPE ENGINEERING.
 4. EXISTING BOUNDARIES SHOWN ON THIS PLAN ARE FROM LAND INFORMATION DCDB (10/04/2022) AND HAVE NOT BEEN SURVEYED. A BOUNDARY DEFINITION SURVEY SHOULD BE CARRIED OUT TO ESTABLISH EXACT BOUNDARY POSITIONS ON SITE.
 5. LEGAL DESCRIPTION:
LOT 2 DP 548977 (COMPRISED IN RT 942889) 55.3822 Ha.
LOT 1 DP 548977 (COMPRISED IN RT 942888) 4.4352 Ha.
SUBJECT TO:
TOTAL AREA BOTH TITLES: 59.8174 Ha.
 6. THESE NOTES ARE AN INTEGRAL PART OF THIS PLAN.

- RESIDENTIAL DWELLINGS:
1. OPTION 1:
 - 574 INDIVIDUAL DWELLINGS
 2. OPTION 2:
 - 414 INDIVIDUAL DWELLINGS
 3. COMBINED TOTAL AREA OF RESIDENTIAL LOTS: 10.7606 ha

OPEN SPACE AREA TABLE (DEFINITION OF THE PUBLIC/PRIVATE RESERVE AREAS TO BE CONFIRMED)		
TYPE	LOT NUMBERS	AREA
PARK	300 TO 305	5.8528 Ha
POCKET PARK	350 TO 356	0.4243 Ha
COMBINED AREA	300 TO 305 AND 350 TO 356	6.2771 Ha

This design and drawing shall only be used for the purpose for which it was supplied and shall not be altered or reproduced without the permission of Envelope Engineering Limited. No liability shall be accepted for unauthorised use of this design and drawing.

REVISIONS:		BY:	DATE:
REV	NOTES		
P1	PRELIMINARY ISSUE	JEG	26.07.2022
P2	LOT IDENTIFIERS CHANGED	JEG	11.08.2022
P3	LOT BOUNDARIES AMENDED	MJP	27.10.2022

PROJECT:
OTAKI REVISITED LIMITED
OTAKI MAORI RACECOURSE,
57 RAHUI ROAD, OTAKI.

TITLE:
DEVELOPMENT LOT OVERVIEW
WITH AERIAL IMAGERY

ENVELOPE
W W W . E N V E L O P E - E N G . C O . N Z

DESIGNED: JEG	DRAWN: JEG	
CHECKED: EFC	PLOT DATE: 27-10-2022	
SCALE A1: 1:4000	SCALE A3: 1:2000	
STATUS: PRELIMINARY		
PROJECT No: 1733-01	DRAWING No: SK005	REVISION: P3

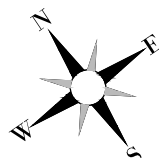

RAHUI ROAD

TE ROTO ROAD

354

B-15
OPTION 1
(3 UNITS)

502

B-16
OPTION 1
(8 UNITS)

B-17
OPTION 1
(5 UNITS)

- NOTES:
- THIS PLAN HAS BEEN PREPARED FOR INFORMATION PURPOSES ONLY. NO DETAILED DESIGN SHOULD BE UNDERTAKEN UTILISING THIS DATA.
 - THIS PLAN DOES NOT SHOW ANY INFORMATION ABOUT INSTRUMENTS REGISTERED AGAINST THE EXISTING RECORDS OF TITLE OR ANY PROPOSED EASEMENTS, COVENANTS OR OTHER FUTURE INSTRUMENTS.
 - THIS PLAN IS ISSUED FOR A SPECIFIC PROJECT AND MAY NOT BE ALTERED OR USED FOR ANY OTHER PURPOSE WITHOUT THE PRIOR WRITTEN CONSENT OF ENVELOPE ENGINEERING.
 - EXISTING BOUNDARIES SHOWN ON THIS PLAN ARE FROM LAND INFORMATION DCDB (104/05/2022) AND HAVE NOT BEEN SURVEYED. A BOUNDARY DEFINITION SURVEY SHOULD BE CARRIED OUT TO ESTABLISH EXACT BOUNDARY POSITIONS ON SITE.
 - LEGAL DESCRIPTION:
LOT 2 DP 548977 (COMPRISED IN RT 942889) 55.3822 Ha.
LOT 1 DP 548977 (COMPRISED IN RT 942888) 4.4352 Ha.
TOTAL AREA BOTH TITLES: 59.8174 Ha.
 - THESE NOTES ARE AN INTEGRAL PART OF THIS PLAN.

RESIDENTIAL DWELLINGS:

OPTION 1:
• 574 INDIVIDUAL DWELLINGS

OPTION 2:
• 414 INDIVIDUAL DWELLINGS

COMBINED TOTAL AREA OF RESIDENTIAL LOTS: 10.7606 ha

This design and drawing shall only be used for the purpose for which it was supplied and shall not be altered or reproduced without the permission of Envelope Engineering Limited. No liability shall be accepted for unauthorised use of this design and drawing.

REVISIONS:

REV	NOTES	BY	DATE
P1	PRELIMINARY ISSUE	JEG	26.07.2022
P2	NUMBERED BY ZONE	JEG	05.08.2022
P3	OPTION 2 ADDED	JEG	11.08.22
P4	LOT BOUNDARIES AMENDED	MJP	27-10-2022

PROJECT:

OTAKI REVISITED LIMITED
OTAKI MAORI RACECOURSE,
57 RAHUI ROAD, OTAKI.

TITLE:

DEVELOPMENT LOT
SHEET 1 OF 7



DESIGNED: JEG

DRAWN: JEG

CHECKED: EFC

PLOT DATE: 27-10-2022

SCALE A1: 1:500

SCALE A3: 1:1000

STATUS: PRELIMINARY

PROJECT No:
1733-01

DRAWING No:
SK006

REVISION:
P4

LEGEND:	
	PROPOSED LOT BOUNDARY
	PROPOSED ZONE BOUNDARY
	EXISTING LOT BOUNDARY
	ROAD BOUNDARY
	RESIDENTIAL LOT
	COMMERCIAL LOT
	CLUSTER HOUSING LOT
	RACE COURSE LOT
	RACE COURSE COMMERCIAL LOT
	PARK LOT
	POCKET PARK LOT
	ROAD TO VEST
	PRIVATE LANE (JOINTLY OWNED ACCESS LOT)
	PROPOSED BUILDING
	EXISTING BUILDING

DRAFT PLAN
ONLY

- NOTES:
1. THIS PLAN HAS BEEN PREPARED FOR INFORMATION PURPOSES ONLY. NO DETAILED DESIGN SHOULD BE UNDERTAKEN UTILISING THIS DATA.
 2. THIS PLAN DOES NOT SHOW ANY INFORMATION ABOUT INSTRUMENTS REGISTERED AGAINST THE EXISTING RECORDS OF TITLE OR ANY PROPOSED EASEMENTS, COVENANTS OR OTHER FUTURE INSTRUMENTS.
 3. THIS PLAN IS ISSUED FOR A SPECIFIC PROJECT AND MAY NOT BE ALTERED OR USED FOR ANY OTHER PURPOSE WITHOUT THE PRIOR WRITTEN CONSENT OF ENVELOPE ENGINEERING.
 4. EXISTING BOUNDARIES SHOWN ON THIS PLAN ARE FROM LAND INFORMATION DCDB (104/05/2022) AND HAVE NOT BEEN SURVEYED. A BOUNDARY DEFINITION SURVEY SHOULD BE CARRIED OUT TO ESTABLISH EXACT BOUNDARY POSITIONS ON SITE.
 5. LEGAL DESCRIPTION:
LOT 2 DP 548977 (COMPRISED IN RT 942889) 55.3822 Ha.

LOT 1 DP 548977 (COMPRISED IN RT 942888) 4.4352 Ha.

TOTAL AREA BOTH TITLES: 59.8174 Ha.
 6. THESE NOTES ARE AN INTEGRAL PART OF THIS PLAN.

RESIDENTIAL DWELLINGS:

OPTION 1:
• 574 INDIVIDUAL DWELLINGS

OPTION 2:
• 414 INDIVIDUAL DWELLINGS

COMBINED TOTAL AREA OF RESIDENTIAL LOTS: 10.7606 ha

LEGEND:

	PROPOSED LOT BOUNDARY
	PROPOSED ZONE BOUNDARY
	EXISTING LOT BOUNDARY
	ROAD BOUNDARY
	RESIDENTIAL LOT
	COMMERCIAL LOT
	CLUSTER HOUSING LOT
	RACE COURSE LOT
	RACE COURSE COMMERCIAL LOT
	PARK LOT
	POCKET PARK LOT
	ROAD TO VEST
	PRIVATE LANE (JOINTLY OWNED ACCESS LOT)
	PROPOSED BUILDING
	EXISTING BUILDING

DIAGRAM A
SCALE A1: 1:500
SCALE A3: 1:1000

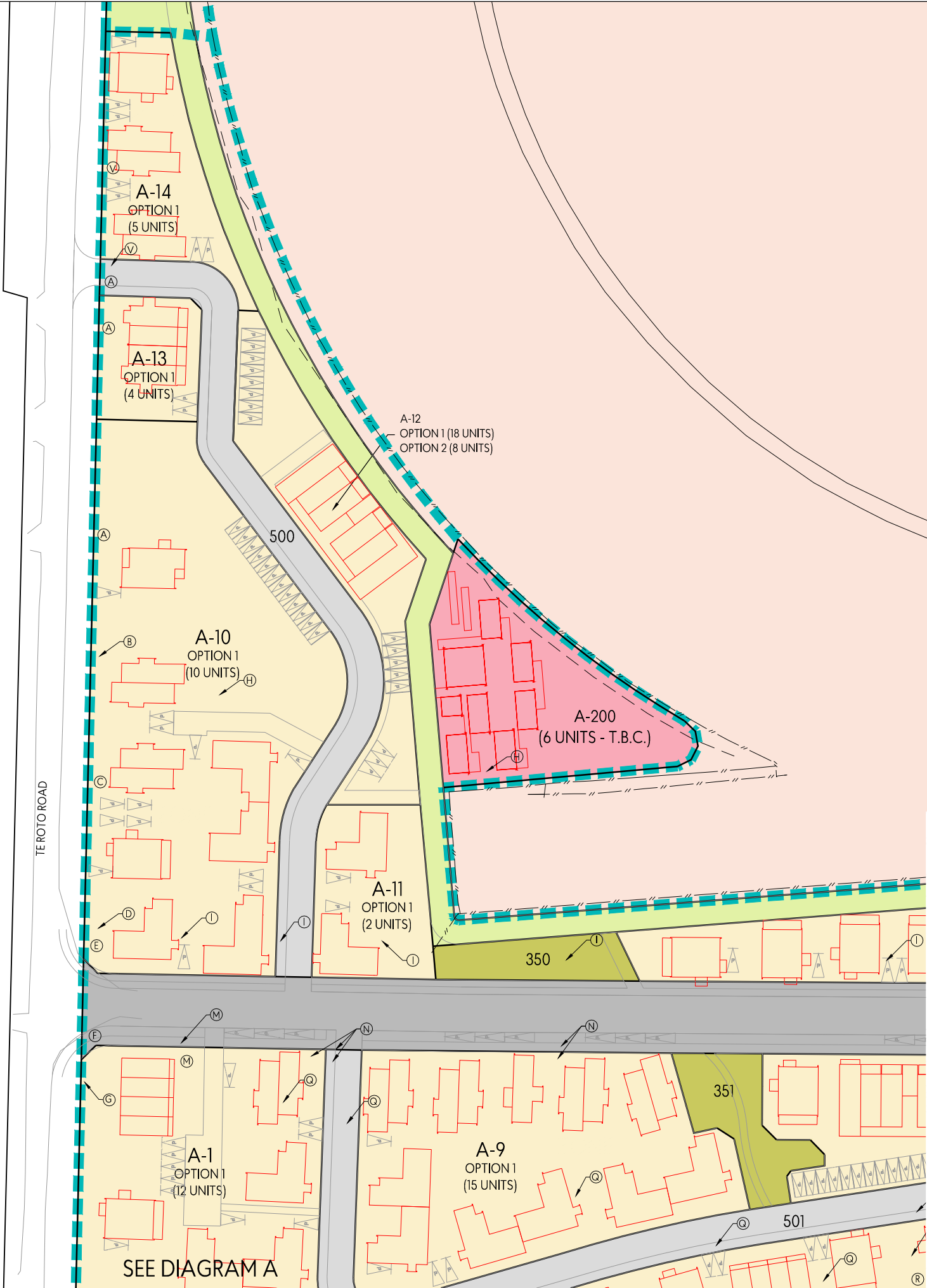
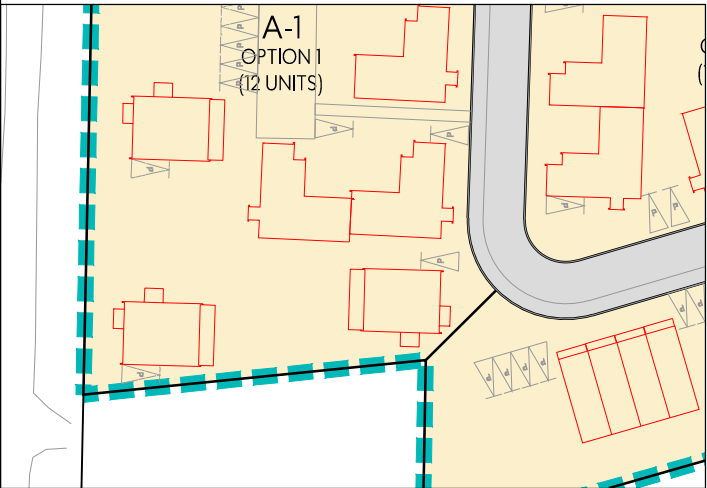

DRAFT PLAN
ONLY

This design and drawing shall only be used for the purpose for which it was supplied and shall not be altered or reproduced without the permission of Envelope Engineering Limited. No liability shall be accepted for unauthorised use of this design and drawing.

REVISIONS:		BY	DATE
REV	NOTES		
P1	PRELIMINARY ISSUE	JEG	26.07.2022
P2	NUMBERED BY ZONE	JEG	05.08.2022
P3	OPTION 2 ADDED	JEG	11.08.22
P4	LOT BOUNDARIES AMENDED	MJP	27-10-2022

PROJECT:
OTAKI REVISITED LIMITED
OTAKI MAORI RACECOURSE,
57 RAHUI ROAD, OTAKI.

TITLE:
DEVELOPMENT LOT
SHEET 2 OF 7

ENVELOPE
W W W . E N V E L O P E - E N G . C O . N Z

DESIGNED: JEG	DRAWN: JEG	
CHECKED: EFC	PLOT DATE: 27-10-2022	
SCALE A1: 1:500	SCALE A3: 1:1000	
STATUS: PRELIMINARY		
PROJECT No: 1733-01	DRAWING No: SK007	REVISION: P4

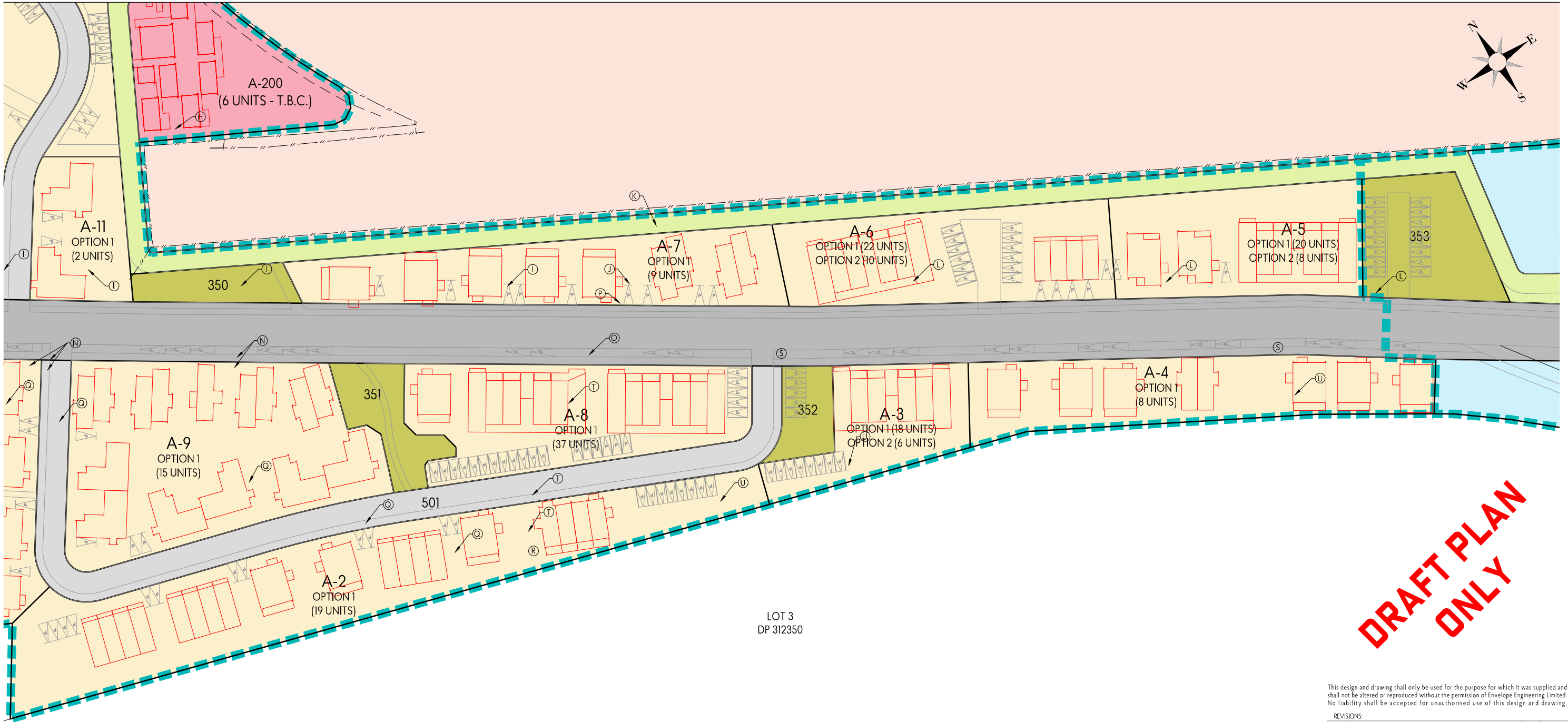

**DRAFT PLAN
ONLY**

This design and drawing shall only be used for the purpose for which it was supplied and shall not be altered or reproduced without the permission of Envelope Engineering Limited. No liability shall be accepted for unauthorised use of this design and drawing.

REVISIONS:			
REV	NOTES	BY	DATE
P1	PRELIMINARY ISSUE	JEG	26.07.2022
P2	NUMBERED BY ZONE	JEG	06.08.2022
P3	OPTION 2 ADDED	JEG	11.08.22
P4	LOT BOUNDARIES AMENDED	MJP	27-10-2022

PROJECT:
OTAKI REVISITED LIMITED
OTAKI MAORI RACECOURSE,
57 RAHUI ROAD, OTAKI.

TITLE:
DEVELOPMENT LOT
SHEET 3 OF 7



DESIGNED: JEG	DRAWN: JEG	REVISION:
CHECKED: EFC	PLOT DATE: 27-10-2022	
SCALE A1: 1:500	SCALE A3: 1:1000	
STATUS: PRELIMINARY		
PROJECT No: 1733-01	DRAWING No: SK008	P4

RESIDENTIAL DWELLINGS:
OPTION 1:
• 574 INDIVIDUAL DWELLINGS
OPTION 2:
• 414 INDIVIDUAL DWELLINGS
COMBINED TOTAL AREA OF RESIDENTIAL LOTS: 10.7606 ha

LEGEND:	
	PROPOSED LOT BOUNDARY
	PROPOSED ZONE BOUNDARY
	EXISTING LOT BOUNDARY
	ROAD BOUNDARY
	RESIDENTIAL LOT
	COMMERCIAL LOT
	CLUSTER HOUSING LOT
	RACE COURSE LOT
	RACE COURSE COMMERCIAL LOT
	PARK LOT
	POCKET PARK LOT
	ROAD TO VEST
	PRIVATE LANE (JOINTLY OWNED ACCESS LOT)
	PROPOSED BUILDING
	EXISTING BUILDING

- NOTES:
- THIS PLAN HAS BEEN PREPARED FOR INFORMATION PURPOSES ONLY. NO DETAILED DESIGN SHOULD BE UNDERTAKEN UTILISING THIS DATA.
 - THIS PLAN DOES NOT SHOW ANY INFORMATION ABOUT INSTRUMENTS REGISTERED AGAINST THE EXISTING RECORDS OF TITLE OR ANY PROPOSED EASEMENTS, COVENANTS OR OTHER FUTURE INSTRUMENTS.
 - THIS PLAN IS ISSUED FOR A SPECIFIC PROJECT AND MAY NOT BE ALTERED OR USED FOR ANY OTHER PURPOSE WITHOUT THE PRIOR WRITTEN CONSENT OF ENVELOPE ENGINEERING.
 - EXISTING BOUNDARIES SHOWN ON THIS PLAN ARE FROM LAND INFORMATION DCDB (10/05/2022) AND HAVE NOT BEEN SURVEYED. A BOUNDARY DEFINITION SURVEY SHOULD BE CARRIED OUT TO ESTABLISH EXACT BOUNDARY POSITIONS ON SITE.
 - LEGAL DESCRIPTION:
LOT 2 DP 548977 (COMPRISED IN RT 942889) 55.3822 Ha.
LOT 1 DP 548977 (COMPRISED IN RT 942888) 4.4352 Ha.
TOTAL AREA BOTH TITLES: 59.8174 Ha.
 - THESE NOTES ARE AN INTEGRAL PART OF THIS PLAN.

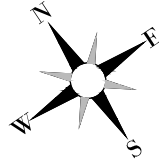
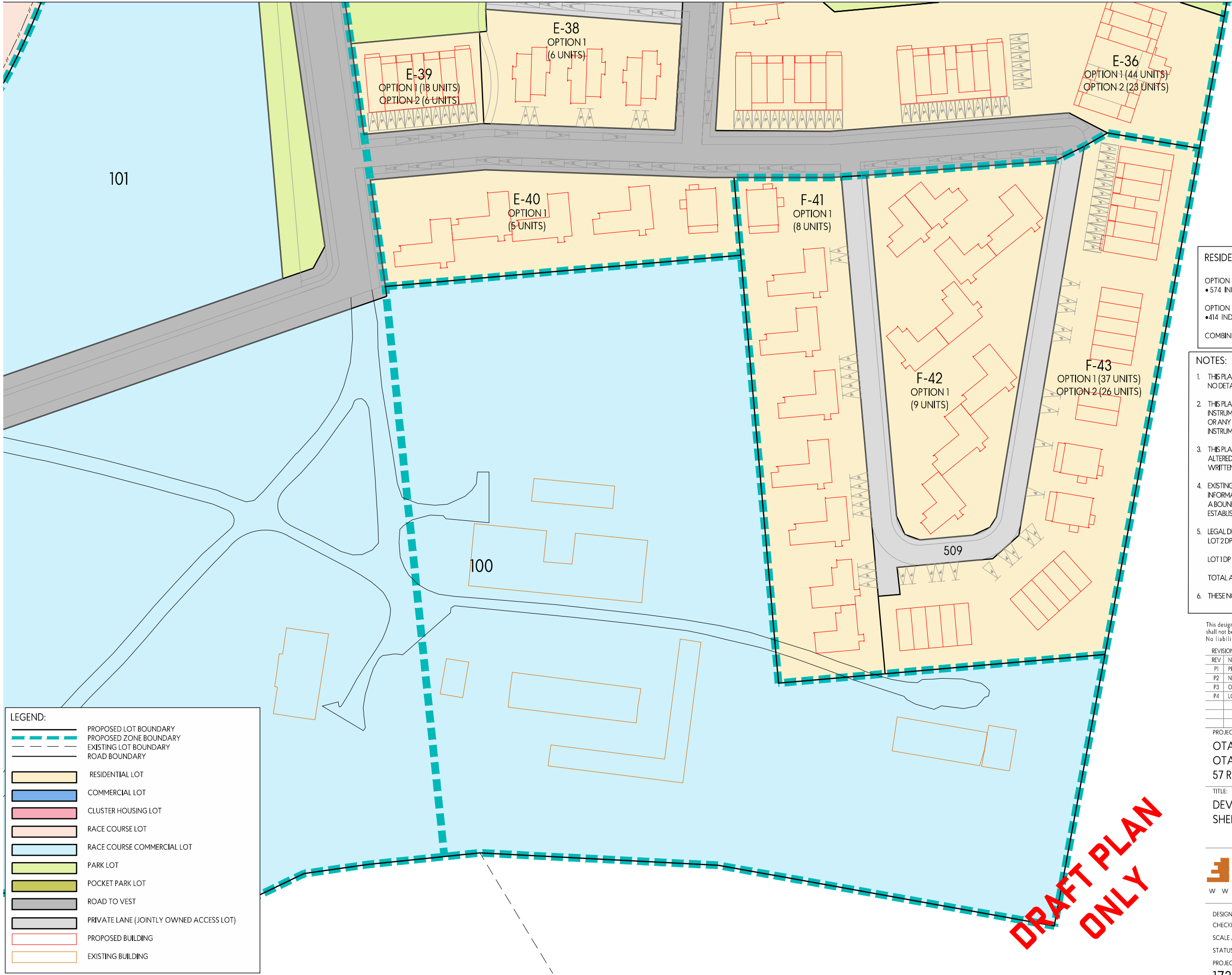

LOT 1
DP 306168

RESIDENTIAL DWELLINGS:

OPTION 1:
• 574 INDIVIDUAL DWELLINGS

OPTION 2:
• 414 INDIVIDUAL DWELLINGS

COMBINED TOTAL AREA OF RESIDENTIAL LOTS: 10,7606 ha

- NOTES:**
- THIS PLAN HAS BEEN PREPARED FOR INFORMATION PURPOSES ONLY. NO DETAILED DESIGN SHOULD BE UNDERTAKEN UTILISING THIS DATA.
 - THIS PLAN DOES NOT SHOW ANY INFORMATION ABOUT INSTRUMENTS REGISTERED AGAINST THE EXISTING RECORDS OF TITLE OR ANY PROPOSED EASEMENTS, COVENANTS OR OTHER FUTURE INSTRUMENTS.
 - THIS PLAN IS ISSUED FOR A SPECIFIC PROJECT AND MAY NOT BE ALTERED OR USED FOR ANY OTHER PURPOSE WITHOUT THE PRIOR WRITTEN CONSENT OF ENVELOPE ENGINEERING.
 - EXISTING BOUNDARIES SHOWN ON THIS PLAN ARE FROM LAND INFORMATION DCDB (10/04/2022) AND HAVE NOT BEEN SURVEYED. A BOUNDARY DEFINITION SURVEY SHOULD BE CARRIED OUT TO ESTABLISH EXACT BOUNDARY POSITIONS ON SITE.
 - LEGAL DESCRIPTION:
LOT 2 DP 548977 (COMPRISED IN RT 942889) 55.3822 Ha.

LOT 1 DP 548977 (COMPRISED IN RT 942888) 4.4352 Ha.

TOTAL AREA BOTH TITLES: 59.8174 Ha.
 - THESE NOTES ARE AN INTEGRAL PART OF THIS PLAN.

This design and drawing shall only be used for the purpose for which it was supplied and shall not be altered or reproduced without the permission of Envelope Engineering Limited. No liability shall be accepted for unauthorised use of this design and drawing.

REVISIONS:			
REV	NOTES	BY	DATE
P1	PRELIMINARY ISSUE	JEG	26.07.2022
P2	NUMBERED BY ZONE	JEG	05.08.2022
P3	OPTION 2 ADDED	JEG	11.08.2022
P4	LOT BOUNDARIES AMENDED	MJP	27.10.2022

PROJECT:
OTAKI REVISITED LIMITED
OTAKI MAORI RACECOURSE,
57 RAHUI ROAD, OTAKI.

TITLE:
DEVELOPMENT LOT
SHEET 4 OF 7



DESIGNED: JEG	DRAWN: JEG	REVISION:
CHECKED: EFC	PLOT DATE: 27-10-2022	
SCALE A1: 1:500	SCALE A3: 1:1000	P4
STATUS: PRELIMINARY		
PROJECT No: 1733-01	DRAWING No: SK009	

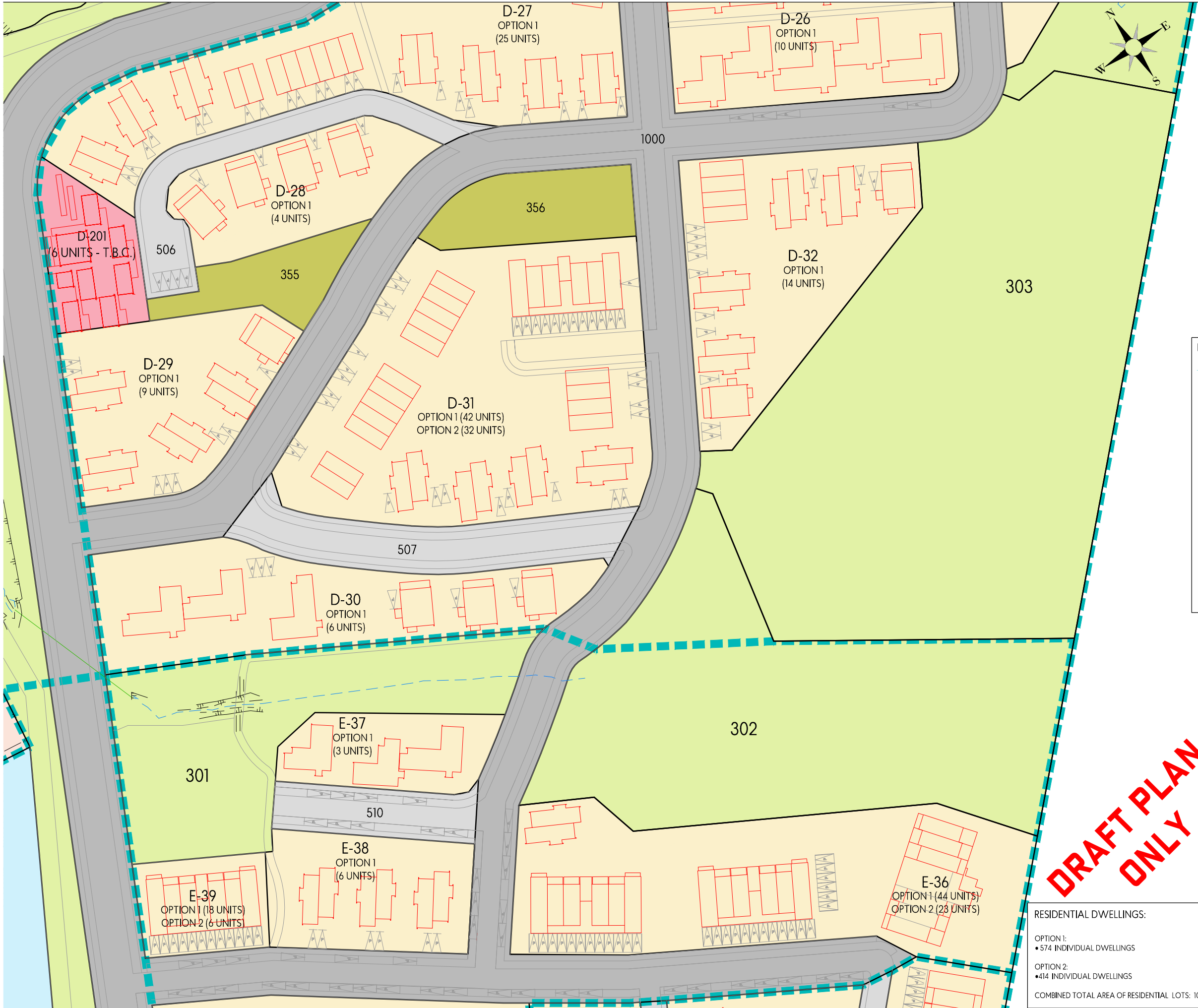

- NOTES:
1. THIS PLAN HAS BEEN PREPARED FOR INFORMATION PURPOSES ONLY. NO DETAILED DESIGN SHOULD BE UNDERTAKEN UTILISING THIS DATA.
 2. THIS PLAN DOES NOT SHOW ANY INFORMATION ABOUT INSTRUMENTS REGISTERED AGAINST THE EXISTING RECORDS OF TITLE OR ANY PROPOSED EASEMENTS, COVENANTS OR OTHER FUTURE INSTRUMENTS.
 3. THIS PLAN IS ISSUED FOR A SPECIFIC PROJECT AND MAY NOT BE ALTERED OR USED FOR ANY OTHER PURPOSE WITHOUT THE PRIOR WRITTEN CONSENT OF ENVELOPE ENGINEERING.
 4. EXISTING BOUNDARIES SHOWN ON THIS PLAN ARE FROM LAND INFORMATION DCDB (104/05/2022) AND HAVE NOT BEEN SURVEYED. A BOUNDARY DEFINITION SURVEY SHOULD BE CARRIED OUT TO ESTABLISH EXACT BOUNDARY POSITIONS ON SITE.
 5. LEGAL DESCRIPTION:
LOT 2 DP 548977 (COMPRISED IN RT 942889) 55.3822 Ha.
LOT 1 DP 548977 (COMPRISED IN RT 942888) 4.4352 Ha.
TOTAL AREA BOTH TITLES: 59.8174 Ha.
 6. THESE NOTES ARE AN INTEGRAL PART OF THIS PLAN.

- LEGEND:
- PROPOSED LOT BOUNDARY
 - PROPOSED ZONE BOUNDARY
 - EXISTING LOT BOUNDARY
 - ROAD BOUNDARY
 - RESIDENTIAL LOT
 - COMMERCIAL LOT
 - CLUSTER HOUSING LOT
 - RACE COURSE LOT
 - RACE COURSE COMMERCIAL LOT
 - PARK LOT
 - POCKET PARK LOT
 - ROAD TO VEST
 - PRIVATE LANE (JOINTLY OWNED ACCESS LOT)
 - PROPOSED BUILDING
 - EXISTING BUILDING

This design and drawing shall only be used for the purpose for which it was supplied and shall not be altered or reproduced without the permission of Envelope Engineering Limited. No liability shall be accepted for unauthorised use of this design and drawing.

REVISIONS:		BY:	DATE:
REV	NOTES		
P1	PRELIMINARY ISSUE	JEG	26.07.2022
P2	NUMBERED BY ZONE	JEG	05.08.2022
P3	OPTION 2 ADDED	JEG	11.08.22
P4	LOT BOUNDARIES AMENDED	MJP	27-10-2022

PROJECT:
OTAKI REVISITED LIMITED
OTAKI MAORI RACECOURSE,
57 RAHUI ROAD, OTAKI.

TITLE:
DEVELOPMENT LOT
SHEET 5 OF 7

ENVELOPE
W W W . E N V E L O P E - E N G . C O . N Z

DESIGNED: JEG
CHECKED: EFC
SCALE A1: 1:500
STATUS: PRELIMINARY

DRAWN: JEG
PLOT DATE: 27-10-2022
SCALE A3: 1:1000

PROJECT No: 1733-01
DRAWING No: SK010
REVISION: P4

RESIDENTIAL DWELLINGS:

OPTION 1:
• 574 INDIVIDUAL DWELLINGS

OPTION 2:
• 414 INDIVIDUAL DWELLINGS

COMBINED TOTAL AREA OF RESIDENTIAL LOTS: 10.7606 ha

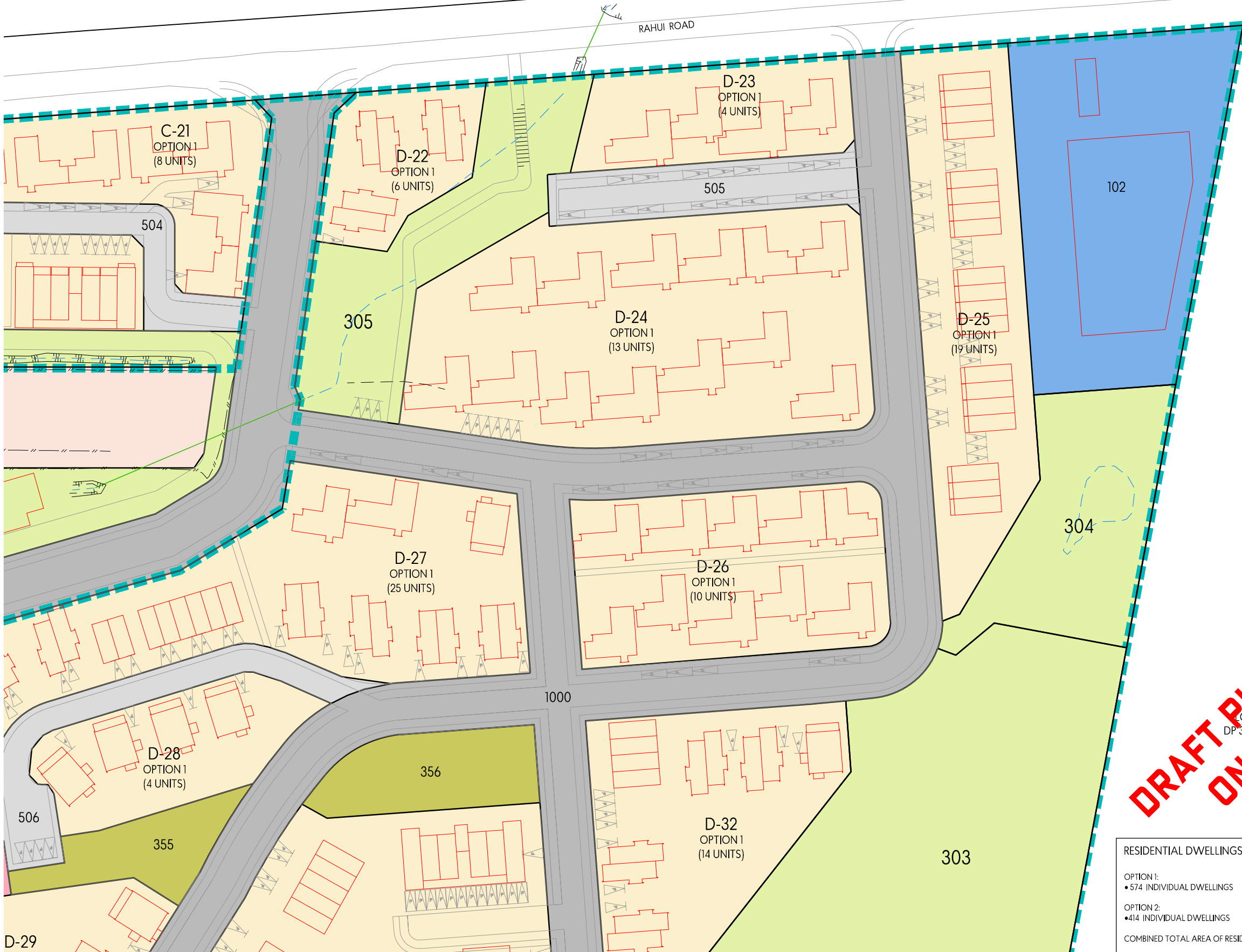

1. THIS PLAN HAS BEEN PREPARED FOR INFORMATION PURPOSES ONLY. NO DETAILED DESIGN SHOULD BE UNDERTAKEN UTILISING THIS DATA.
2. THIS PLAN SHOULD NOT SHOW ANY INFORMATION ABOUT INSTRUMENTS REGISTERED AGAINST THE EXISTING RECORDS OF TITLE OR ANY PROPOSED EASEMENTS, COVENANTS OR OTHER FUTURE INSTRUMENTS.
3. THIS PLAN IS ISSUED FOR A SPECIFIC PROJECT AND MAY NOT BE ALTERED OR USED FOR ANY OTHER PURPOSE WITHOUT THE PRIOR WRITTEN CONSENT OF ENVELOPE ENGINEERING.
4. EXISTING BOUNDARIES SHOWN ON THIS PLAN ARE FROM LAND INFORMATION DCDB (104/06/2022) AND HAVE NOT BEEN SURVEYED. A BOUNDARY DEFINITION SURVEY SHOULD BE CARRIED OUT TO ESTABLISH EXACT BOUNDARY POSITIONS ON SITE.
5. LEGAL DESCRIPTION:
LOT 2 DP 548977 (COMPRISED IN RT 942889) 55.3822 Ha.
LOT 1 DP 548977 (COMPRISED IN RT 942888) 44.352 Ha.

TOTAL AREA BOTH TITLES: 99.7342 Ha.
6. THESE NOTES ARE AN INTEGRAL PART OF THIS PLAN.

LEGEND:

-
- PROPOSED LOT BOUNDARY
 PROPOSED ZONE BOUNDARY
 EXISTING LOT BOUNDARY
 ROAD BOUNDARY
- RESIDENTIAL LOT
 COMMERCIAL LOT
 CLUSTER HOUSING LOT
 RACE COURSE LOT
 RACE COURSE COMMERCIAL LOT
 PARK LOT
 POCKET PARK LOT
 RV - ROAD TO VEST
 PRIVATE LANE (JOINTLY OWNED ACCESS LOT)
 PROPOSED BUILDING
 EXISTING BUILDING

This design and drawing shall only be used for the purpose for which it was supplied and shall not be altered or reproduced without the permission of Envelope Engineering Limited. No liability shall be accepted for unauthorised use of this design and drawing.

REVISIONS:

REV	NOTES	BY	DATE
P1	PRELIMINARY ISSUE	JEG	26.07.2022
P2	NUMBERED BY ZONE	JEG	05.08.2022
P3	OPTION 2 ADDED	JEG	11.08.22
P4	LOT BOUNDARIES AMENDED	MJP	27.10.2022

PROJECT:

OTAKI REVISITED LIMITED
OTAKI MAORI RACECOURSE,
57 RAHUI ROAD, OTAKI.

TITLE:

DEVELOPMENT LOT
SHEET 6 OF 7

DESIGNED: JEG DRAWN: JEG
CHECKED: EFC PLOT DATE: 27-10-2022
SCALE A1: 1:500 SCALE A3: 1:1000

PROJECT No:	DRAWING No:	REVISION:
1733-01	SK011	P4

RESIDENTIAL DWELLINGS:

OPTION 1:
• 574 INDIVIDUAL DWELLINGS

OPTION 2:
• 414 INDIVIDUAL DWELLINGS

COMBINED TOTAL AREA OF RESIDENTIAL LOTS: 10.7606 ha

**DRAFT PLAN
ONLY**

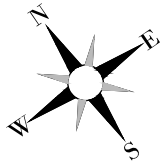
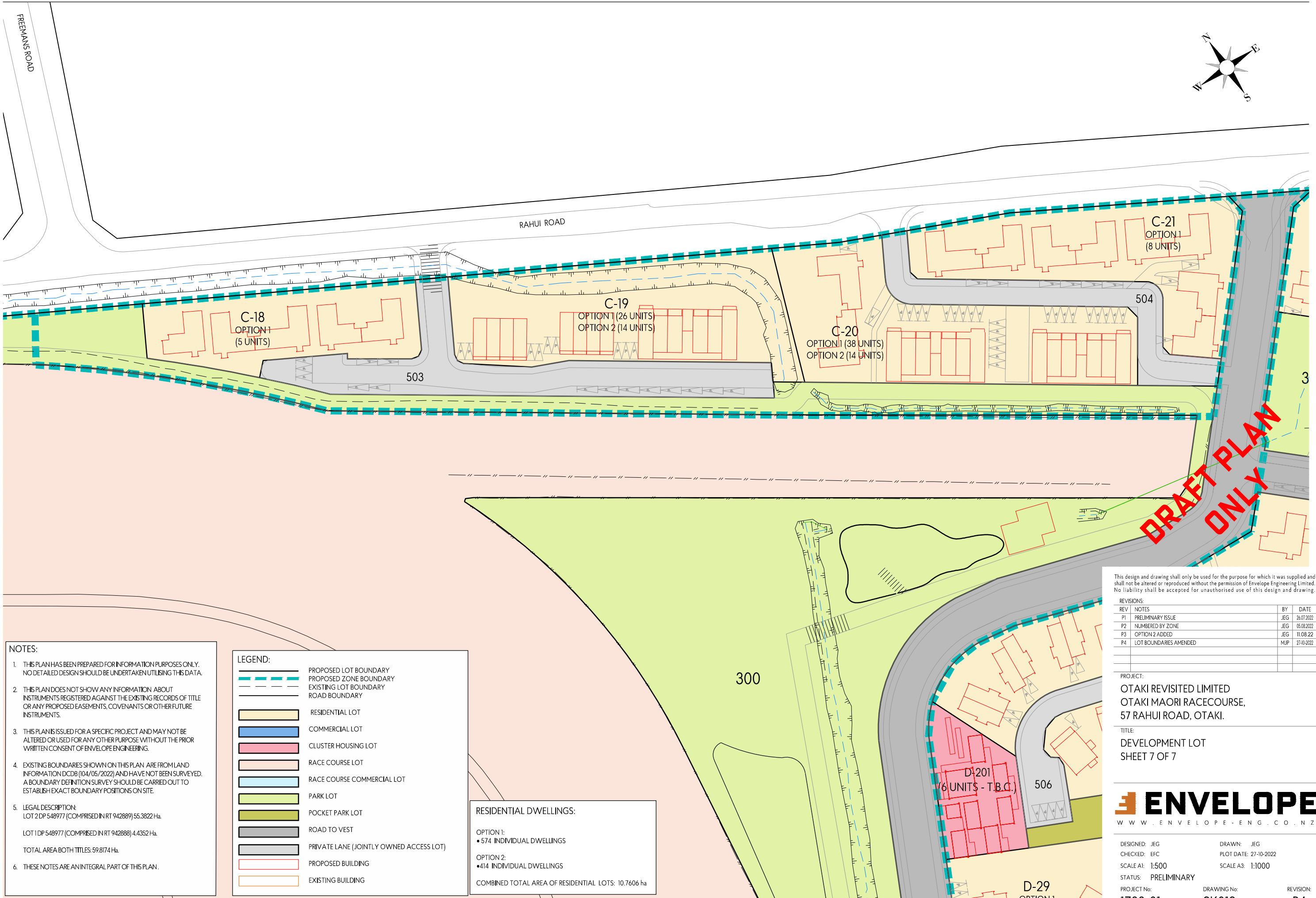

NOTES:

1. THIS PLAN HAS BEEN PREPARED FOR INFORMATION PURPOSES ONLY. NO DETAILED DESIGN SHOULD BE UNDERTAKEN UTILISING THIS DATA.

2. THIS PLAN DOES NOT SHOW ANY INFORMATION ABOUT INSTRUMENTS REGISTERED AGAINST THE EXISTING RECORDS OF TITLE OR ANY PROPOSED EASEMENTS, COVENANTS OR OTHER FUTURE INSTRUMENTS.

3. THIS PLAN IS ISSUED FOR A SPECIFIC PROJECT AND MAY NOT BE ALTERED OR USED FOR ANY OTHER PURPOSE WITHOUT THE PRIOR WRITTEN CONSENT OF ENVELOPE ENGINEERING.

4. EXISTING BOUNDARIES SHOWN ON THIS PLAN ARE FROM LAND INFORMATION DCDB (104/05/2022) AND HAVE NOT BEEN SURVEYED. A BOUNDARY DEFINITION SURVEY SHOULD BE CARRIED OUT TO ESTABLISH EXACT BOUNDARY POSITIONS ON SITE.

5. LEGAL DESCRIPTION:
LOT 2 DP 548977 (COMPRISED IN RT 942889) 55.3822 Ha.
LOT 1 DP 548977 (COMPRISED IN RT 942888) 4.4352 Ha.
TOTAL AREA BOTH TITLES: 59.8174 Ha.

6. THESE NOTES ARE AN INTEGRAL PART OF THIS PLAN.

LEGEND:

	PROPOSED LOT BOUNDARY
	PROPOSED ZONE BOUNDARY
	EXISTING LOT BOUNDARY
	ROAD BOUNDARY
	RESIDENTIAL LOT
	COMMERCIAL LOT
	CLUSTER HOUSING LOT
	RACE COURSE LOT
	RACE COURSE COMMERCIAL LOT
	PARK LOT
	POCKET PARK LOT
	ROAD TO VEST
	PRIVATE LANE (JOINTLY OWNED ACCESS LOT)
	PROPOSED BUILDING
	EXISTING BUILDING

RESIDENTIAL DWELLINGS:

OPTION 1:
• 574 INDIVIDUAL DWELLINGS

OPTION 2:
• 414 INDIVIDUAL DWELLINGS

COMBINED TOTAL AREA OF RESIDENTIAL LOTS: 10.7606 ha

This design and drawing shall only be used for the purpose for which it was supplied and shall not be altered or reproduced without the permission of Envelope Engineering Limited. No liability shall be accepted for unauthorised use of this design and drawing.

REVISIONS:			
REV	NOTES	BY	DATE
P1	PRELIMINARY ISSUE	JEG	26.07.2022
P2	NUMBERED BY ZONE	JEG	05.08.2022
P3	OPTION 2 ADDED	JEG	11.08.22
P4	LOT BOUNDARIES AMENDED	MJP	27-10-2022

PROJECT:
OTAKI REVISITED LIMITED
OTAKI MAORI RACECOURSE,
57 RAHUI ROAD, OTAKI.

TITLE:
DEVELOPMENT LOT
SHEET 7 OF 7



DESIGNED: JEG	DRAWN: JEG	REVISION:
CHECKED: EFC	PLOT DATE: 27-10-2022	
SCALE A1: 1:500	SCALE A3: 1:1000	
STATUS: PRELIMINARY		
PROJECT No: 1733-01	DRAWING No: SK012	P4