

**DISCLAIMER:**  
This map/plan is illustrative only and all information should be independently verified on site before taking any action.  
Copyright Auckland Council. Land Parcel Boundary information from LINZ (Crown Copyright Reserved). Whilst due care has been taken, Auckland Council gives no warranty as to the accuracy and plan completeness of any information on this map/plan and accepts no liability for any error, omission or use of the information. Height datum: Auckland 1946.

## Built Environment

### 20 Melia Place and 43A Vipond Road

Scale @ A4  
= 1:2,500

**Date Printed:**  
18/05/2021

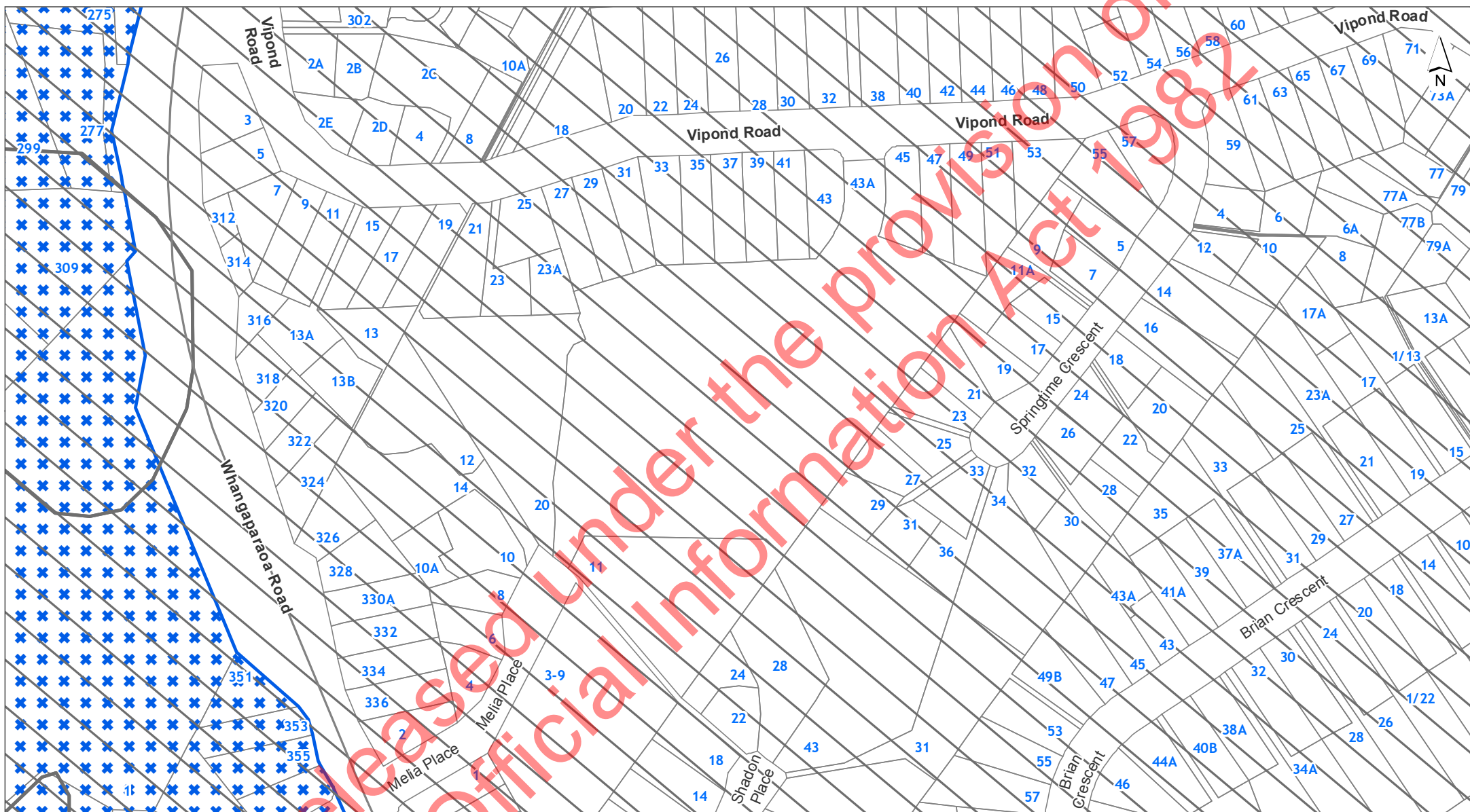

## DISCLAIMER:

This map/plan is illustrative only and all information should be independently verified on site before taking any action. Copyright Auckland Council. Land Parcel Boundary information from LINZ (Crown Copyright Reserved). Whilst due care has been taken, Auckland Council gives no warranty as to the accuracy and plan completeness of any information on this map/plan and accepts no liability for any error, omission or use of the information. Height datum: Auckland 1946.

## Controls

### 20 Melia Place and 43A Vipond Road

0 10 20 30  
Meters

Scale @ A4  
= 1:2,500

Date Printed:  
18/05/2021

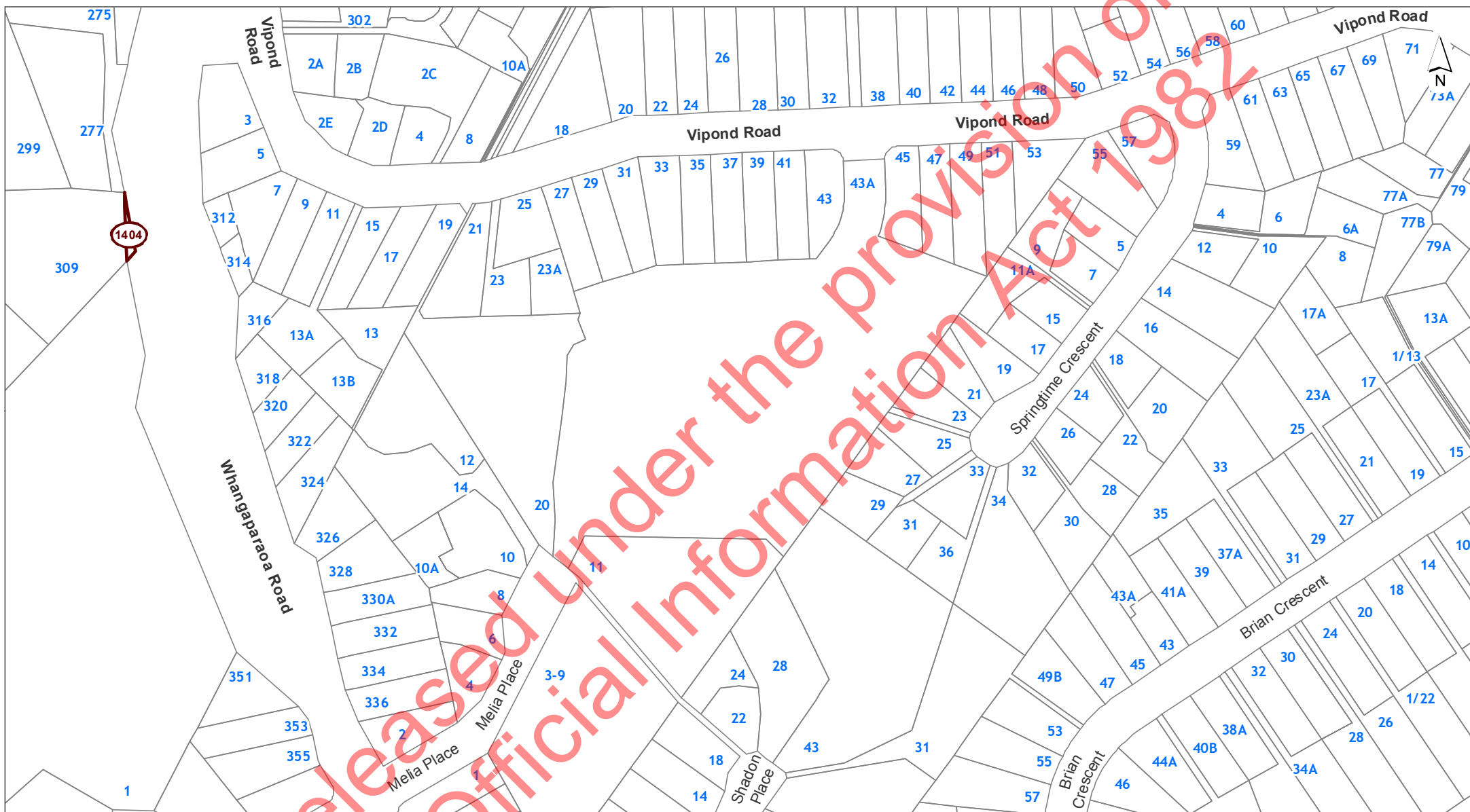

## DISCLAIMER:

This map/plan is illustrative only and all information should be independently verified on site before taking any action. Copyright Auckland Council. Land Parcel Boundary information from LINZ (Crown Copyright Reserved). Whilst due care has been taken, Auckland Council gives no warranty as to the accuracy and plan completeness of any information on this map/plan and accepts no liability for any error, omission or use of the information. Height datum: Auckland 1946.

## Designations

### 20 Melia Place and 43A Vipond Road

0 10 20 30  
Meters

Scale @ A4  
= 1:2,500

Date Printed:  
18/05/2021

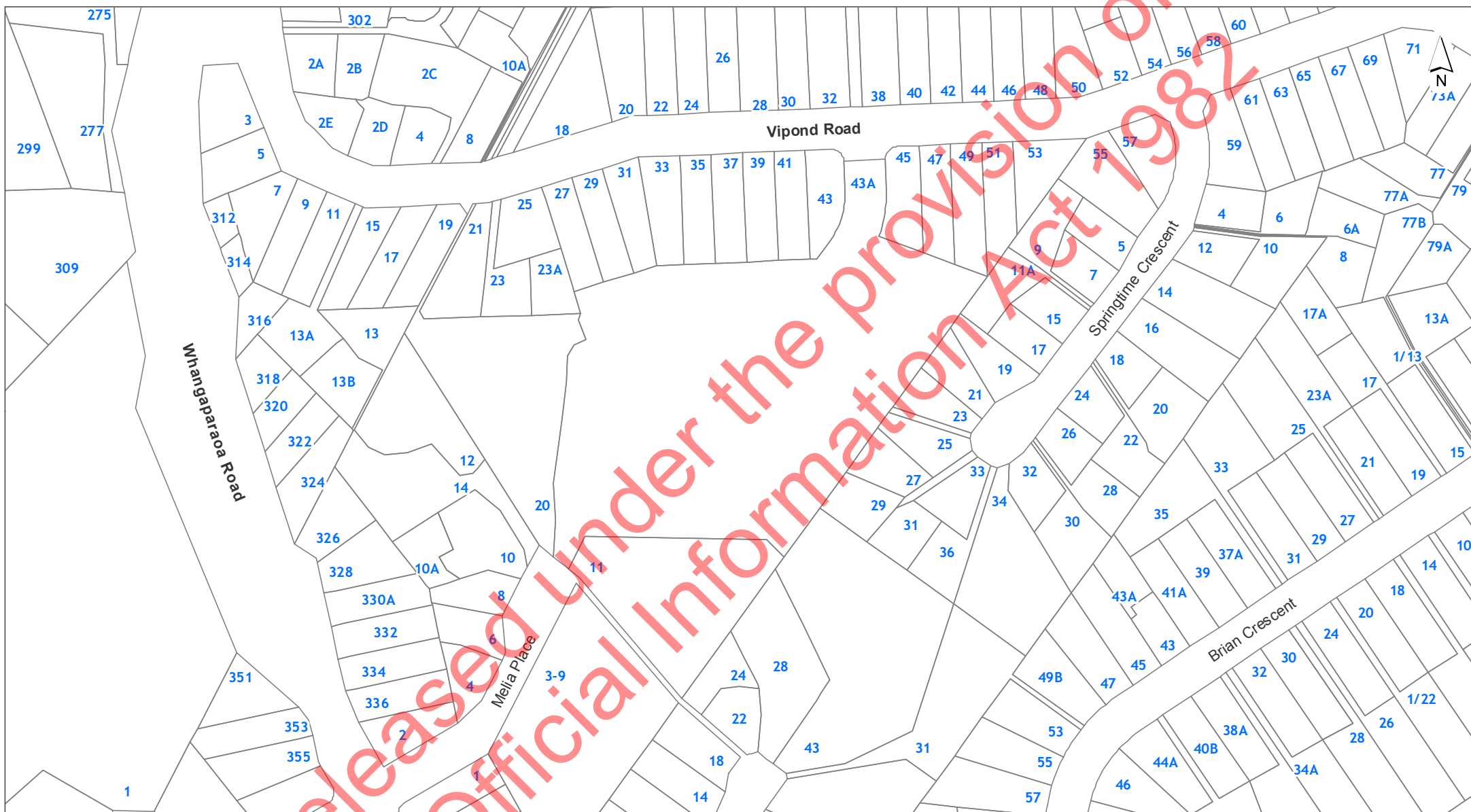

**DISCLAIMER:**  
This map/plan is illustrative only and all information should be independently verified on site before taking any action.  
Copyright Auckland Council. Land Parcel Boundary information from LINZ (Crown Copyright Reserved). Whilst due care has been taken, Auckland Council gives no warranty as to the accuracy and plan completeness of any information on this map/plan and accepts no liability for any error, omission or use of the information. Height datum: Auckland 1946.

## Historic Heritage and Special Character 20 Melia Place and 43A Vipond Road

Scale @ A4  
= 1:2,500

**Date Printed:**  
18/05/2021

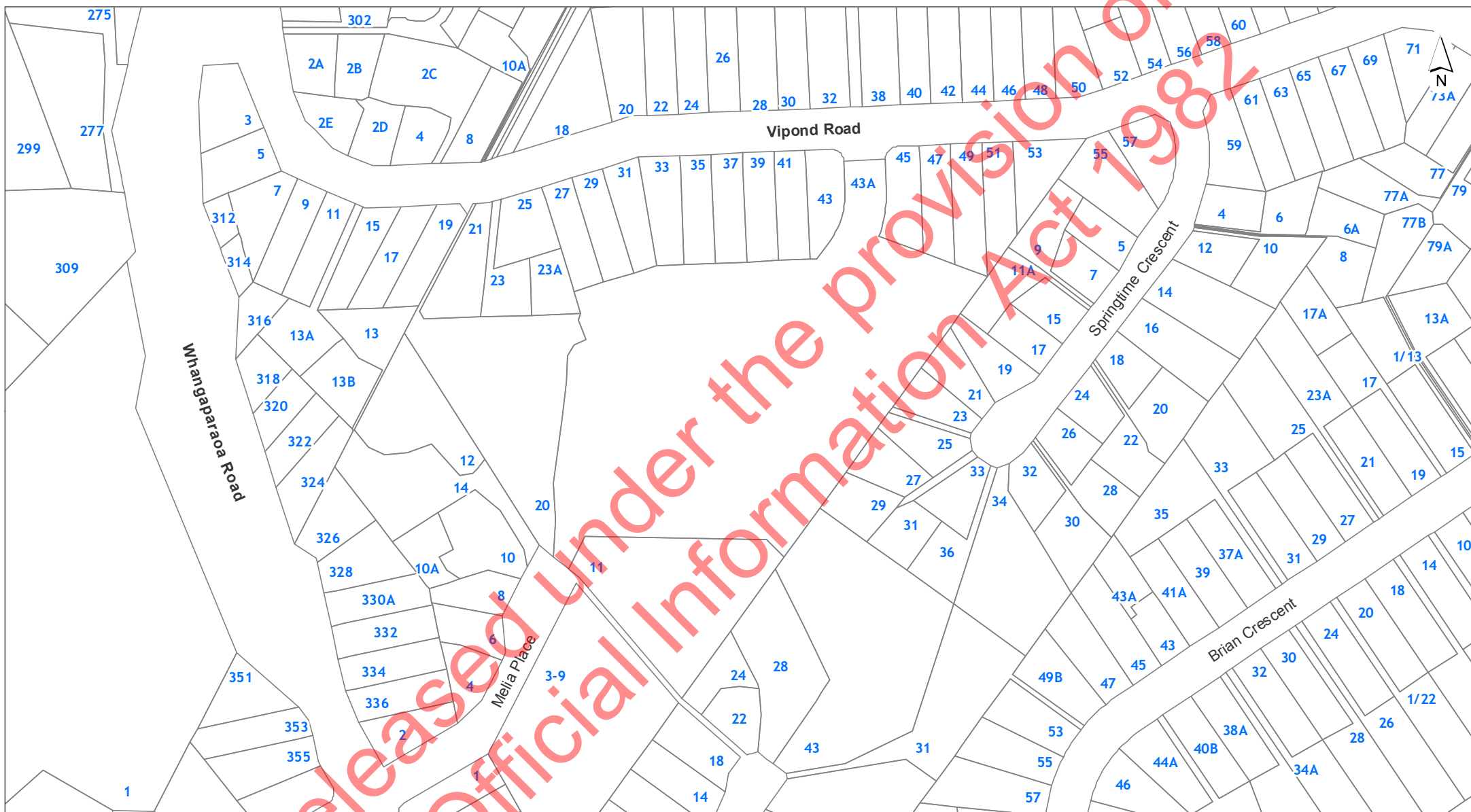

**DISCLAIMER:**  
This map/plan is illustrative only and all information should be independently verified on site before taking any action.  
Copyright Auckland Council. Land Parcel Boundary information from LINZ (Crown Copyright Reserved). Whilst due care has been taken, Auckland Council gives no warranty as to the accuracy and plan completeness of any information on this map/plan and accepts no liability for any error, omission or use of the information. Height datum: Auckland 1946.

## Infrastructure

### 20 Melia Place and 43A Vipond Road

Scale @ A4  
= 1:2,500

**Date Printed:**  
18/05/2021

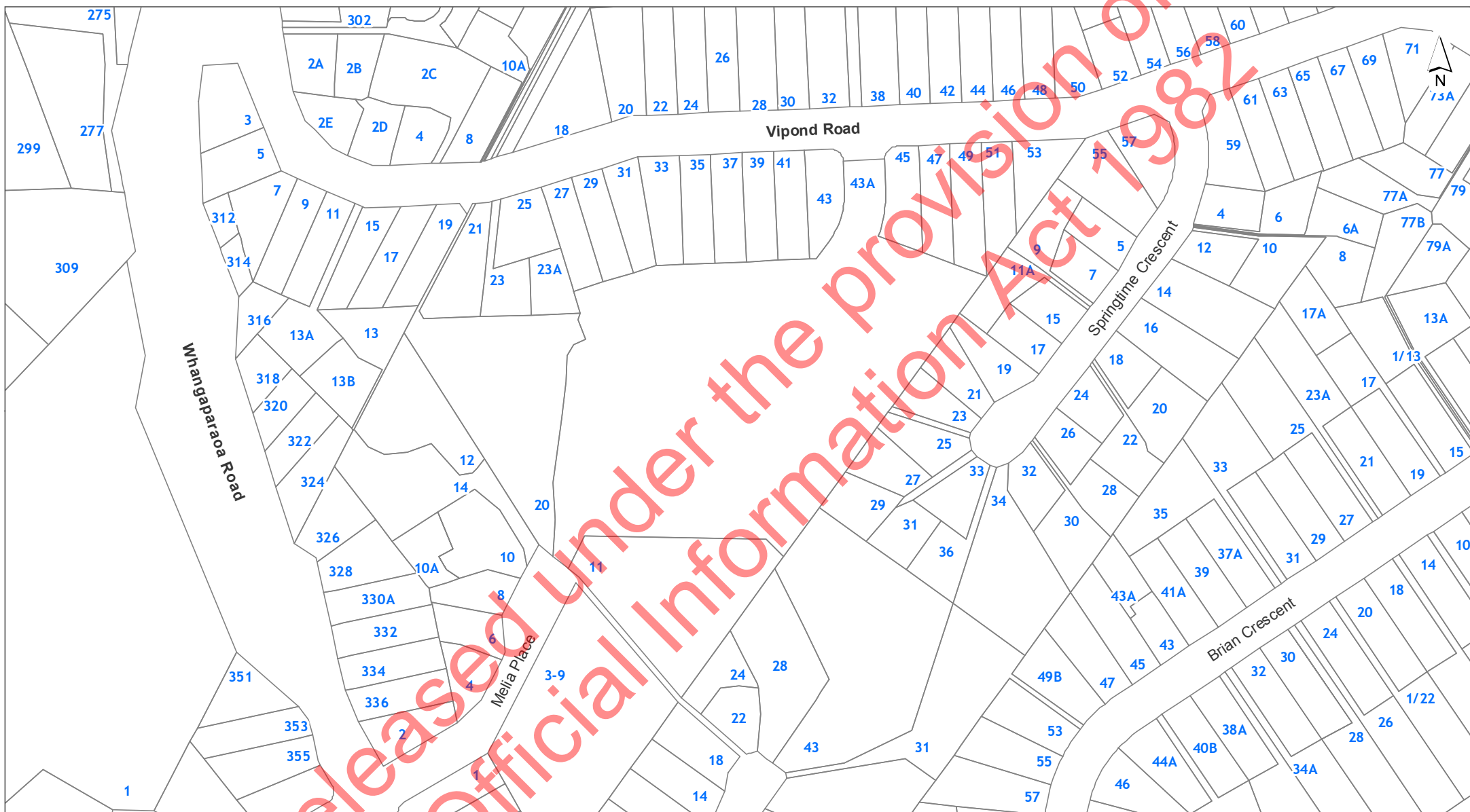

**DISCLAIMER:**  
This map/plan is illustrative only and all information should be independently verified on site before taking any action.  
Copyright Auckland Council. Land Parcel Boundary information from LINZ (Crown Copyright Reserved). Whilst due care has been taken, Auckland Council gives no warranty as to the accuracy and plan completeness of any information on this map/plan and accepts no liability for any error, omission or use of the information. Height datum: Auckland 1946.

## Mana Whenua 20 Melia Place and 43A Vipond Road

0 10 20 30  
Meters

Scale @ A4  
= 1:2,500

Date Printed:  
18/05/2021

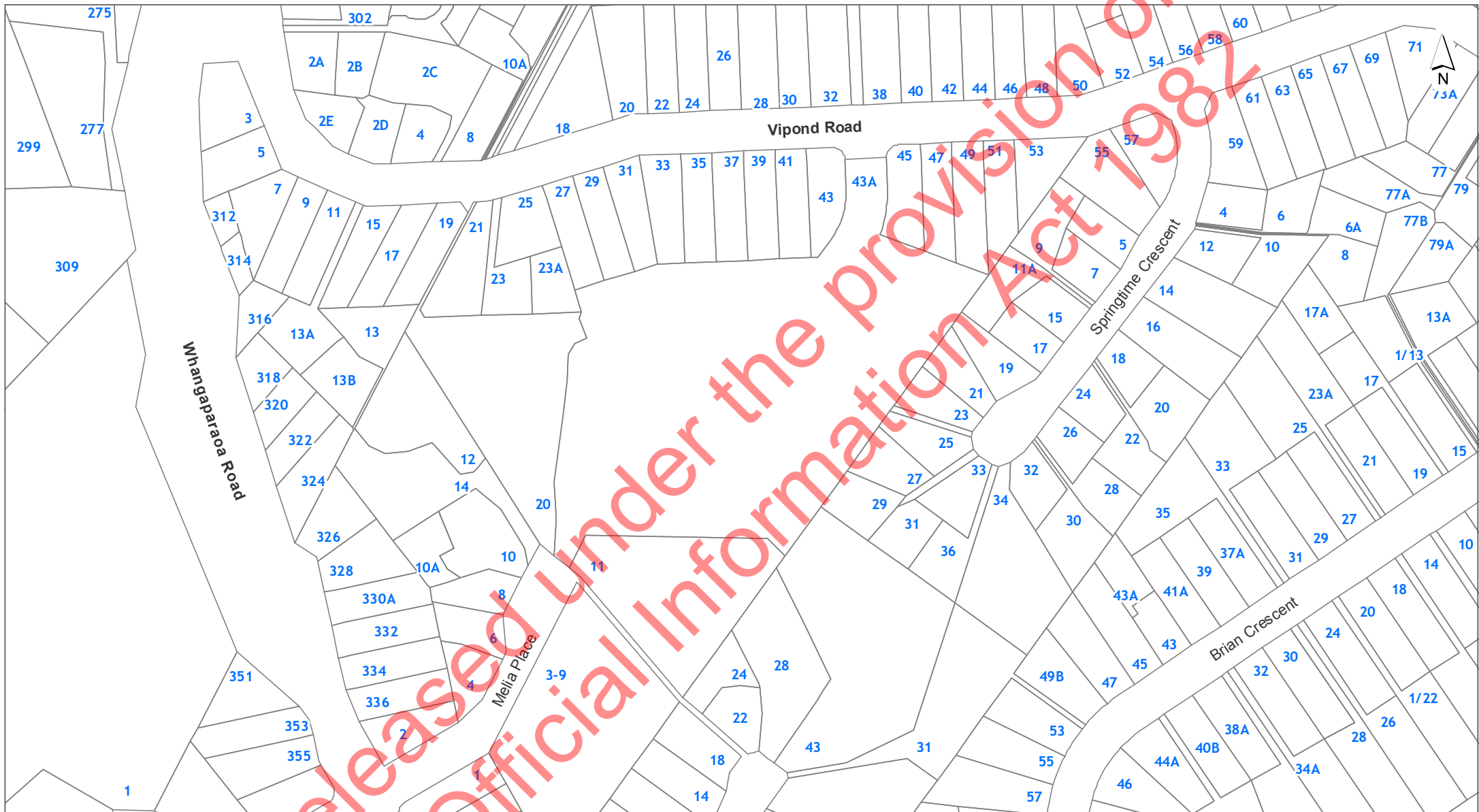

**DISCLAIMER:**  
This map/plan is illustrative only and all information should be independently verified on site before taking any action.  
Copyright Auckland Council. Land Parcel Boundary information from LINZ (Crown Copyright Reserved). Whilst due care has been taken, Auckland Council gives no warranty as to the accuracy and plan completeness of any information on this map/plan and accepts no liability for any error, omission or use of the information. Height datum: Auckland 1946.

## Natural Heritage

### 20 Melia Place and 43A Vipond Road



Scale @ A4  
= 1:2,500

**Date Printed:**  
18/05/2021

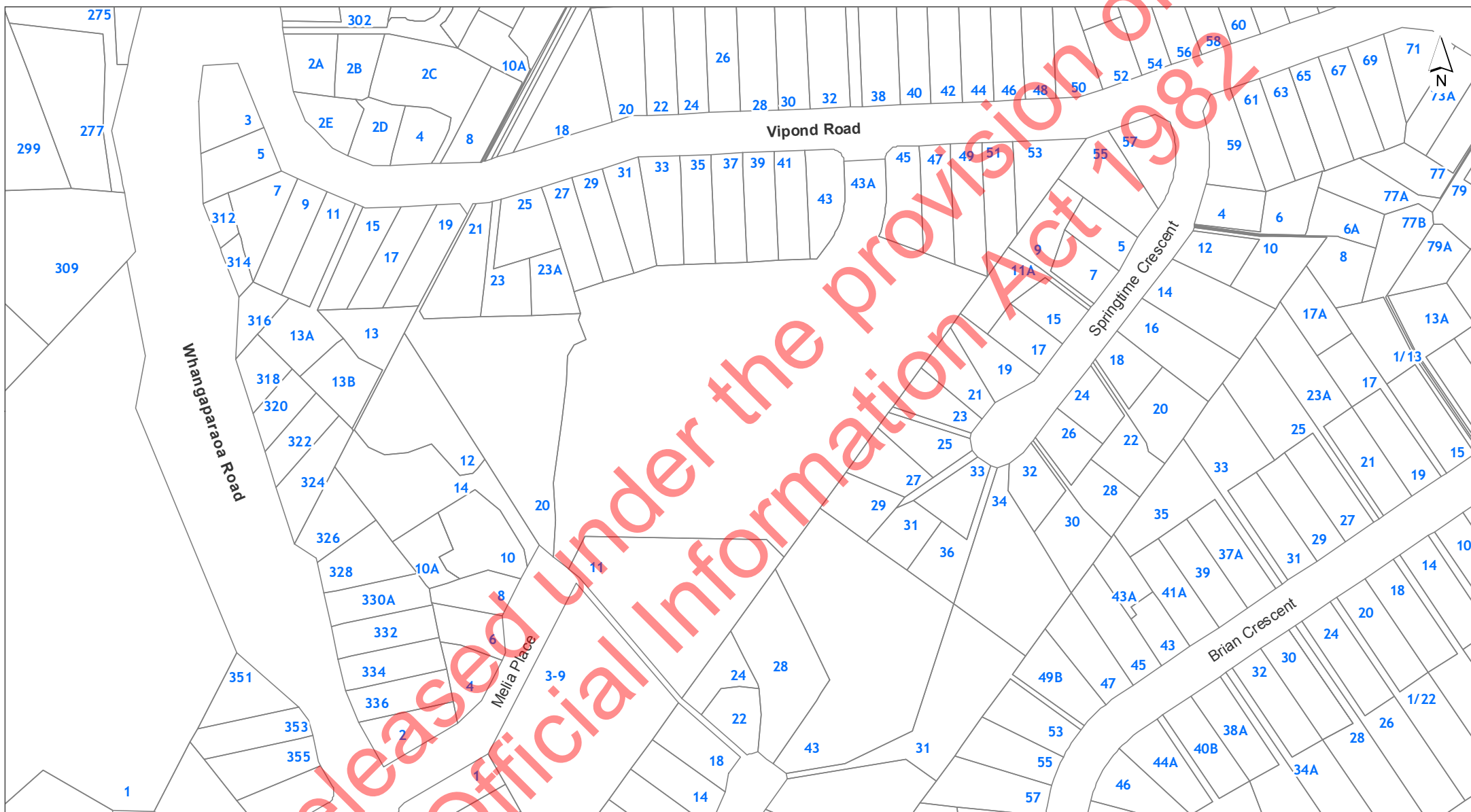

**DISCLAIMER:**  
This map/plan is illustrative only and all information should be independently verified on site before taking any action.  
Copyright Auckland Council. Land Parcel Boundary information from LINZ (Crown Copyright Reserved). Whilst due care has been taken, Auckland Council gives no warranty as to the accuracy and plan completeness of any information on this map/plan and accepts no liability for any error, omission or use of the information. Height datum: Auckland 1946.

### Natural Resources

#### 20 Melia Place and 43A Vipond Road

0 10 20 30  
Meters

Scale @ A4  
= 1:2,500

Date Printed:  
18/05/2021

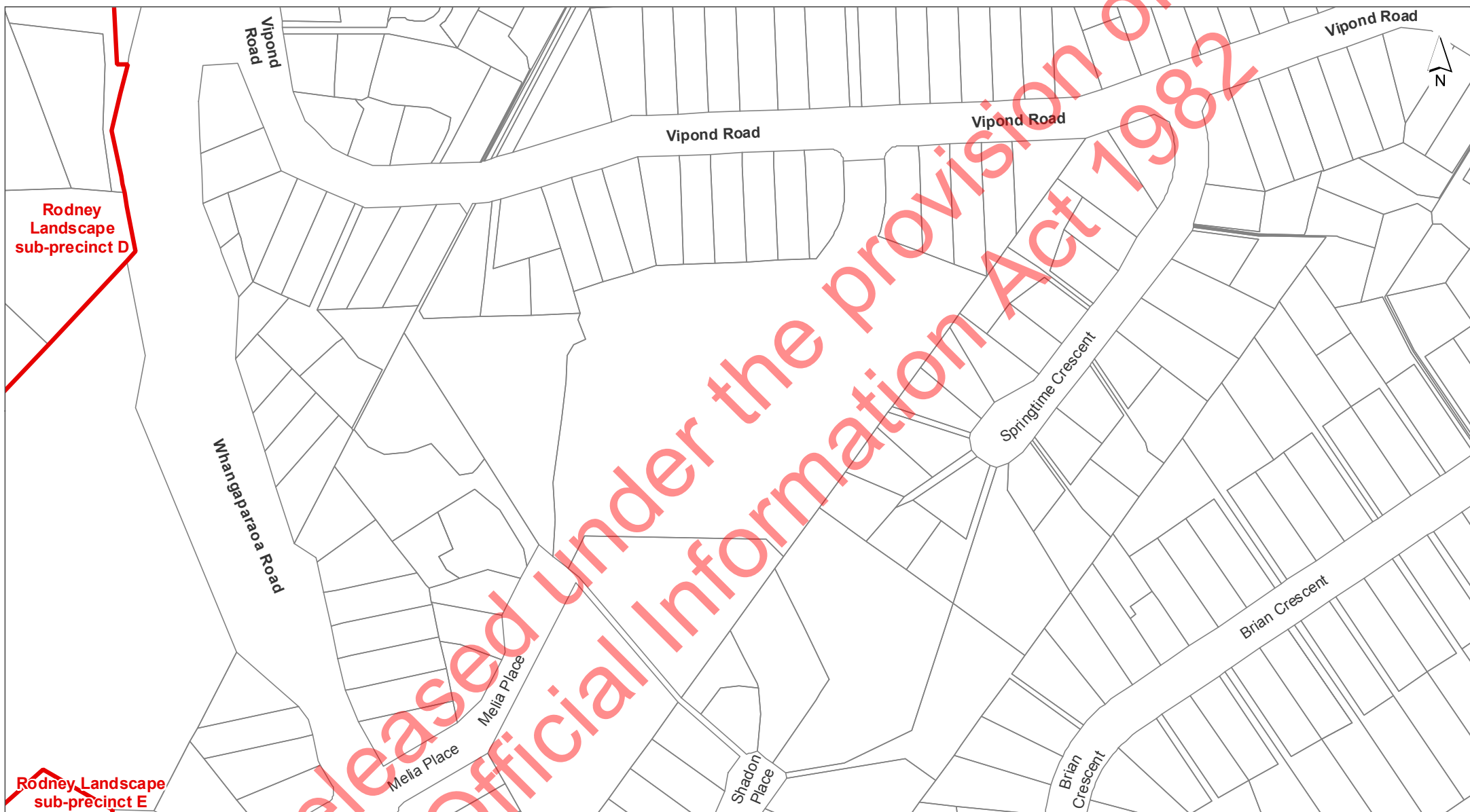

## DISCLAIMER:

This map/plan is illustrative only and all information should be independently verified on site before taking any action. Copyright Auckland Council. Land Parcel Boundary information from LINZ (Crown Copyright Reserved). Whilst due care has been taken, Auckland Council gives no warranty as to the accuracy and plan completeness of any information on this map/plan and accepts no liability for any error, omission or use of the information. Height datum: Auckland 1946.

### Precincts

#### 20 Melia Place and 43A Vipond Road

0 10 20 30  
Meters

Scale @ A4  
= 1:2,500

Date Printed:  
18/05/2021

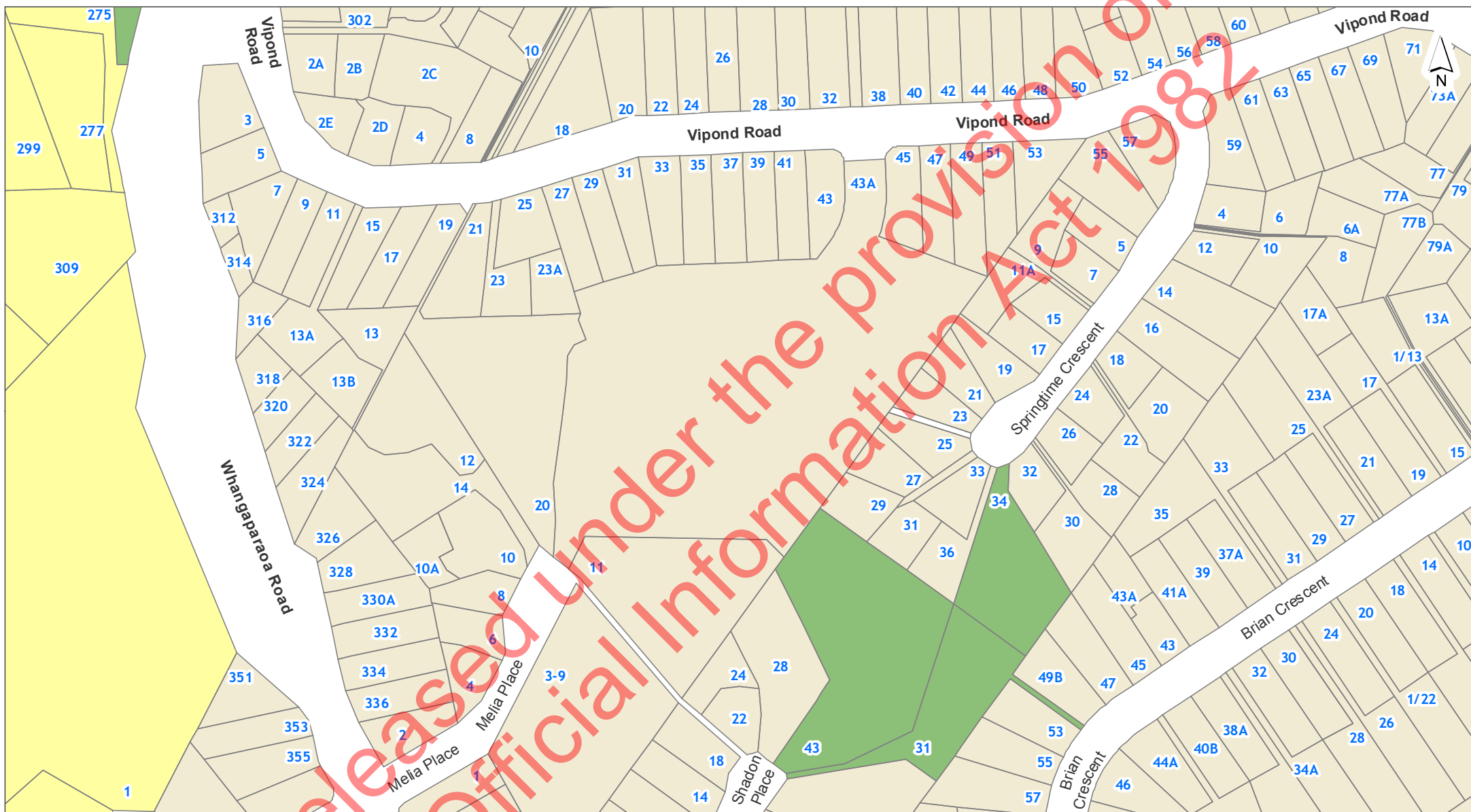

## DISCLAIMER:

This map/plan is illustrative only and all information should be independently verified on site before taking any action. Copyright Auckland Council. Land Parcel Boundary information from LINZ (Crown Copyright Reserved). Whilst due care has been taken, Auckland Council gives no warranty as to the accuracy and plan completeness of any information on this map/plan and accepts no liability for any error, omission or use of the information. Height datum: Auckland 1946.

### Zones and Rural Urban Boundary 20 Melia Place and 43A Vipond Road



0 10 20 30  
Meters

Scale @ A4  
= 1:2,500



Date Printed:  
18/05/2021

## NOTATIONS

## Appeals

-  Properties affected by Appeals seeking change to zones or management layers
-  Properties affected by Appeals seeking reinstatement of management layers

## Proposed Plan Modifications



-  Notice of Requirements
-  Plan Changes

## Tagging of Provisions:

- [ i ] = Information only
- [ rp ] = Regional Plan
- [ rcp ] = Regional Coastal Plan
- [ rps ] = Regional Policy Statement
- [ dp ] = District Plan (only noted when dual provisions apply)

## ZONING







## Residential

-  Residential - Large Lot Zone
-  Residential - Rural and Coastal Settlement Zone
-  Residential - Single House Zone
-  Residential - Mixed Housing Suburban Zone
-  Residential - Mixed Housing Urban Zone
-  Residential - Terrace Housing and Apartment Buildings Zone

## Business

-  Business - City Centre Zone
-  Business - Metropolitan Centre Zone
-  Business - Town Centre Zone
-  Business - Local Centre Zone
-  Business - Neighbourhood Centre Zone
-  Business - Mixed Use Zone
-  Business - General Business Zone
-  Business - Business Park Zone
-  Business - Heavy Industry Zone
-  Business - Light Industry Zone

## Open space

-  Open Space - Conservation Zone
-  Open Space - Informal Recreation Zone
-  Open Space - Sport and Active Recreation Zone
-  Open Space - Civic Spaces Zone
-  Open Space - Community Zone
-  Water [i]



## Rural

-  Rural - Rural Production Zone
-  Rural - Mixed Rural Zone
-  Rural - Rural Coastal Zone
-  Rural - Rural Conservation Zone
-  Rural - Countryside Living Zone
-  Rural - Waitakere Foothills Zone
-  Rural - Waitakere Ranges Zone

## Future Urban

-  Future Urban Zone
-  Green Infrastructure Corridor (Operative in some Special Housing Areas)

## Infrastructure

-  Special Purpose Zone - Airports & Airfields  
Cemetery  
Quarry  
Healthcare Facility & Hospital  
Tertiary Education  
Māori Purpose  
Major Recreation Facility  
School
-  Strategic Transport Corridor Zone

## Coastal

-  Coastal - General Coastal Marine Zone [rcp]
-  Coastal - Marina Zone [rcp/dp]
-  Coastal - Mooring Zone [rcp]
-  Coastal - Minor Port Zone [rcp/dp]
-  Coastal - Ferry Terminal Zone [rcp/dp]
-  Coastal - Defence Zone [rcp]
-  Coastal - Coastal Transition Zone



Precincts

- - - - Rural Urban Boundary

- - - - Indicative Coastline [i]

## Overlays

### Natural Resources

	Terrestrial [rp/dp]	} Significant Ecological Areas Overlay
	Marine 1 [rcp]	
	Marine 2 [rcp]	
	Water Supply Management Areas Overlay [rp]	
	Natural Stream Management Areas Overlay [rp]	
	High-Use Stream Management Areas Overlay [rp]	
	Natural Lake Management Areas Overlay	} (Natural Lake and Urban Lake)
	Urban	
	High-Use Aquifer Management Areas Overlay [rp]	
	Quality-Sensitive Aquifer Management Areas Overlay [rp]	
	Wetland Management Areas Overlay [rp]	

### Infrastructure

	Airport Approach Surface Overlay	
	Aircraft Noise Overlay	
	City Centre Port Noise Overlay [rcp / dp]	
	Quarry Buffer Area Overlay	
	National Grid Subdivision Corridor	} National Grid Corridor Overlay
	National Grid Substation Corridor	
	National Grid Yard Compromised	
	National Grid Yard Uncompromised	

### Mana Whenua

	Sites & Places of Significance to Mana Whenua Overlay [rcp/dp]
--	--

### Built Environment

	Identified Growth Corridor Overlay
--	------------------------------------

### Natural Heritage

	Notable Trees Overlay	
	Outstanding Natural Features Overlay [rcp/dp]	
	Outstanding Natural Landscapes Overlay [rcp/dp]	
	Outstanding Natural Character Overlay [rcp/dp]	
	High Natural Character Overlay [rcp/dp]	
	Viewshafts	} Regionally Significant Volcanic Viewshafts & Height Sensitive Areas Overlay [rcp/dp]
	Height Sensitive Areas	
	Regionally Significant Volcanic Viewshafts Overlay Contours [i]	
	Locally Significant Volcanic Viewshafts Overlay [rcp/dp]	
	Locally Significant Volcanic Viewshafts Overlay Contours [i]	
	Modified	} Ridgeline Protection Overlay
	Natural	
	Local Public Views Overlay [rcp/dp]	
	Extent of Overlay	} Waitakere Ranges Heritage Area Overlay
	Subdivision Schedule	

### Historic Heritage & Special Character

	Historic Heritage Overlay Place [rcp/dp]	
	Historic Heritage Overlay Extent of Place [rcp/dp]	
	Special Character Areas Overlay Residential and Business	
	Auckland War Memorial Museum Viewshaft Overlay [rcp/dp]	
	Auckland War Memorial Museum Viewshaft Overlay Contours [i]	
	Stockade Hill Viewshaft Overlay – 8m height area	
	Stockade Hill Viewshaft [i]	

## Controls

	Key Retail Frontage	} Building Frontage Control
	General Commercial Frontage	
	Adjacent to Level Crossings	} Vehicle Access Restriction Control
	General	
	Motorway Interchange Control	
	Centre Fringe Office Control	
	Height Variation Control	
	Parking Variation Control	
	Level Crossings With Sightlines Control	
	Arterial Roads	

	Business Park Zone Office Control	
	Hazardous Facilities	} Emergency Management Area Control
	Infrastructure	
	Macroinvertebrate Community Index	
	Flow 1 [rp]	} Stormwater Management Area Control
	Flow 2 [rp]	
	Subdivision Variation Control	
	Surf Breaks [rcp]	
	Cable Protection Areas Control [rcp]	
	Coastal Inundation 1 per cent AEP Plus 1m Control	

## Designations

	Designations
--	--------------

	Airspace Restriction Designations
--	-----------------------------------

## Auckland Unitary Plan Operative in part (15th November 2016) Property Summary Report

### Address

43A Vipond Road Stanmore Bay 0932

### Legal Description

Lot 1 DP 169527

### Appeals

### Modifications

### Zones

Residential - Single House Zone

### Precinct

### Controls

Controls: Macroinvertebrate Community Index - Urban

### Overlays

### Designations

Released under the provision of  
the Official Information Act 1982