

Released under the provision of
the Official Information Act 1982

<i>LANDSCAPE CONCEPT</i>	L102
<i>LANDSCAPE CONCEPT SECTOR 1</i>	L103
<i>LANDSCAPE CONCEPT SECTOR 2</i>	L104
<i>LANDSCAPE CONCEPT SECTOR 3</i>	L105
<i>PLANTING STRATEGY SECTOR 1</i>	L106
<i>PLANTING STRATEGY SECTOR 2</i>	L107
<i>PLANTING STRATEGY SECTOR 3</i>	L108



LANDSCAPE CONCEPT DESIGN PACKAGE
20 MELIA PLACE, STANMORE BAY

JAN 2021
113670

LANDSCAPE CONCEPT

- LEGEND**
- 1 MAIN GATED VEHICLE/PEDESTRIAN ENTRANCE
 - 2 PEDESTRIAN FOOTPATH
 - 3 VISITOR CARPARKS / CARPARK SPACES
 - 4 COMMUNITY CENTRE AND ARTIFICIAL TURF
 - 5 SMALL SHADESAIL WITH BBQ SPACE
 - 6 INFORMAL NATURE BASED PLAYSACE
 - 7 PETANQUE AREA
 - 8 GRAVEL PATH
 - 9 GRASS SPACE
 - 10 STREET TREES
 - 11 1.3M WIDE FENCED PLANTED AREA
 - 12 PRIVATE YARDS
 - 13 RAMP TO OLIVE GROVE
 - 14 COMMON BIN STORAGE AREA
 - 15 PATHWAY LINK TO SHANDON RESERVE



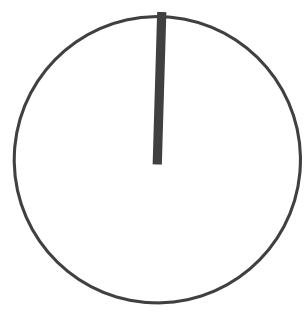

MATERIAL PALETTE

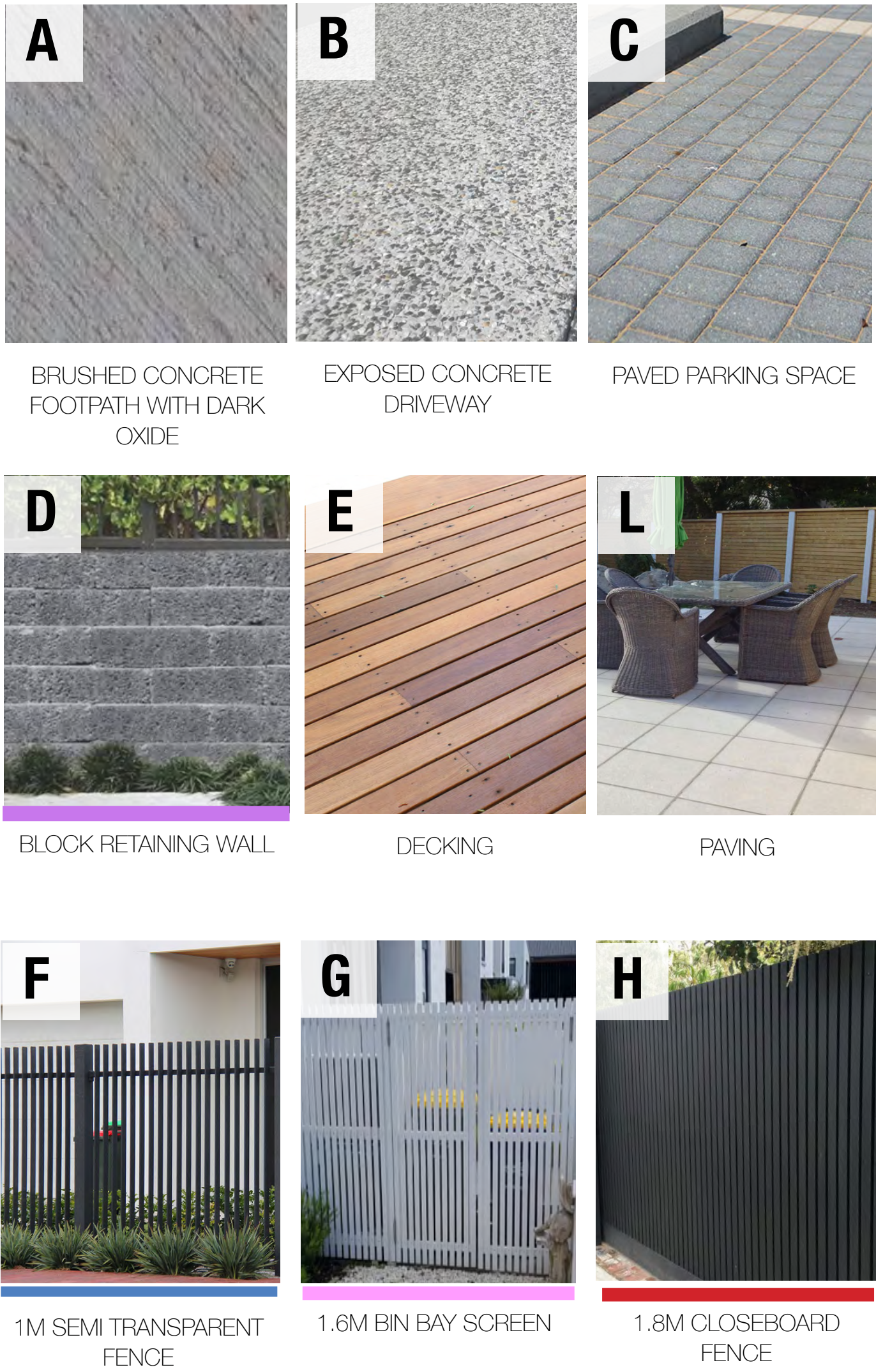

LEGEND

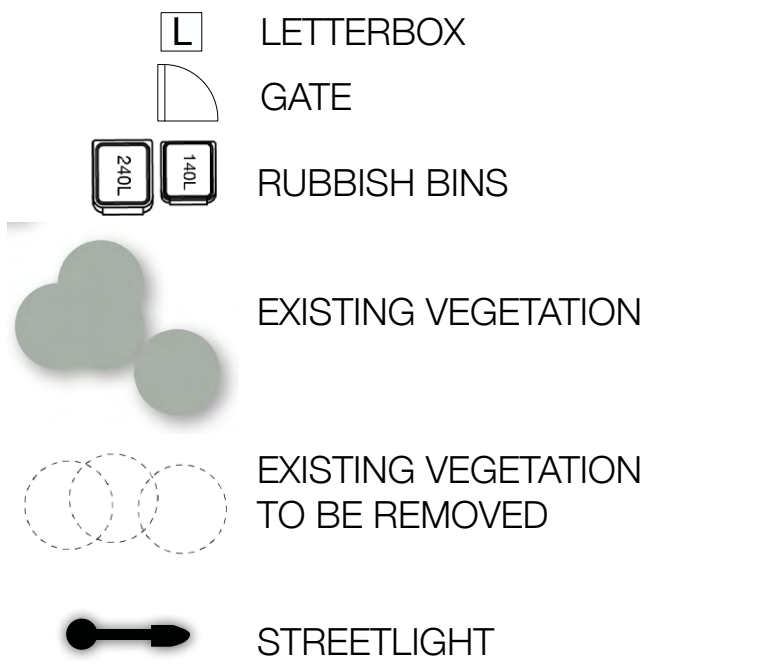

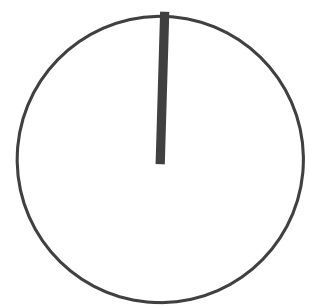

MATERIAL PALETTE

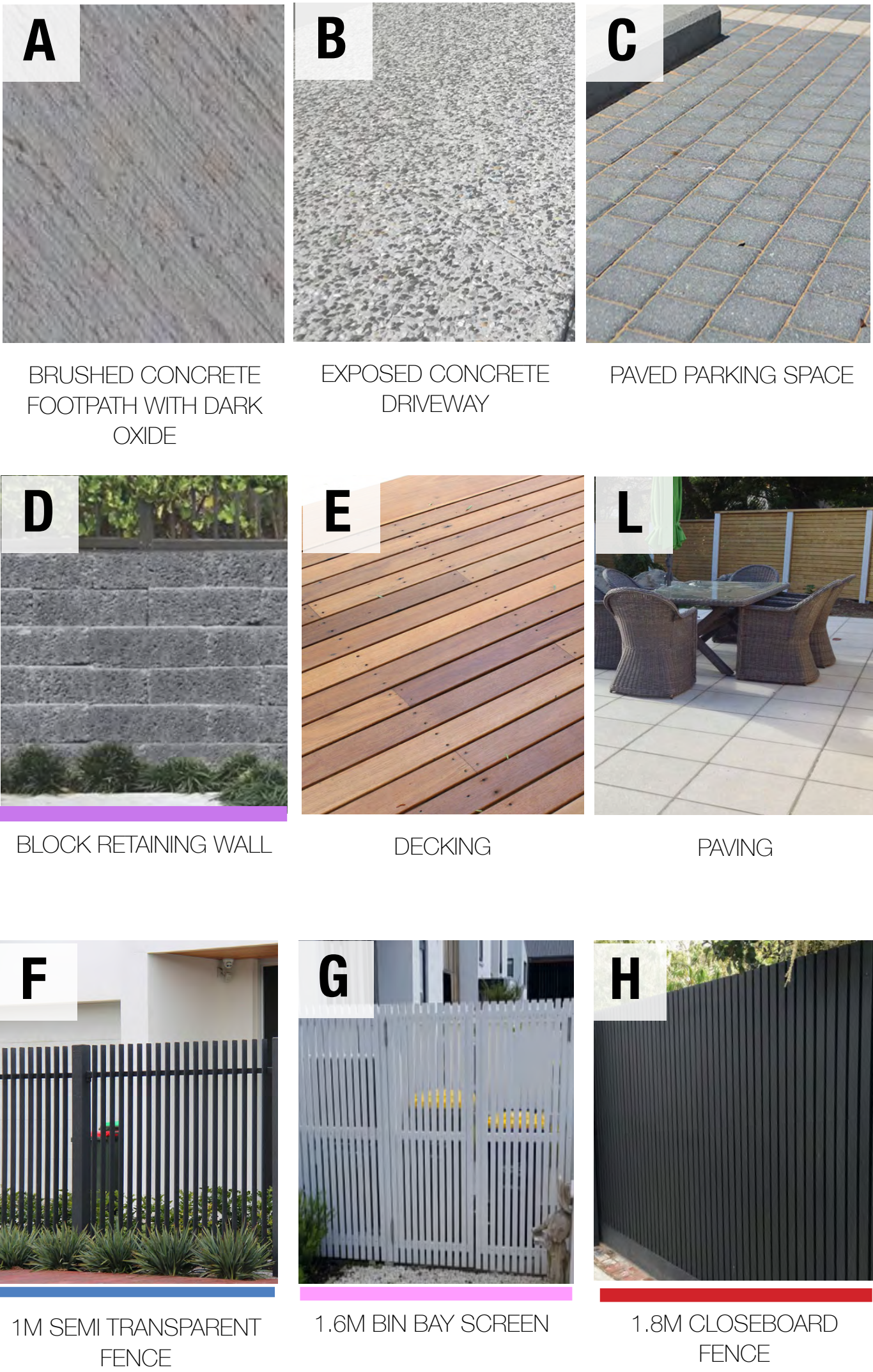

LEGEND

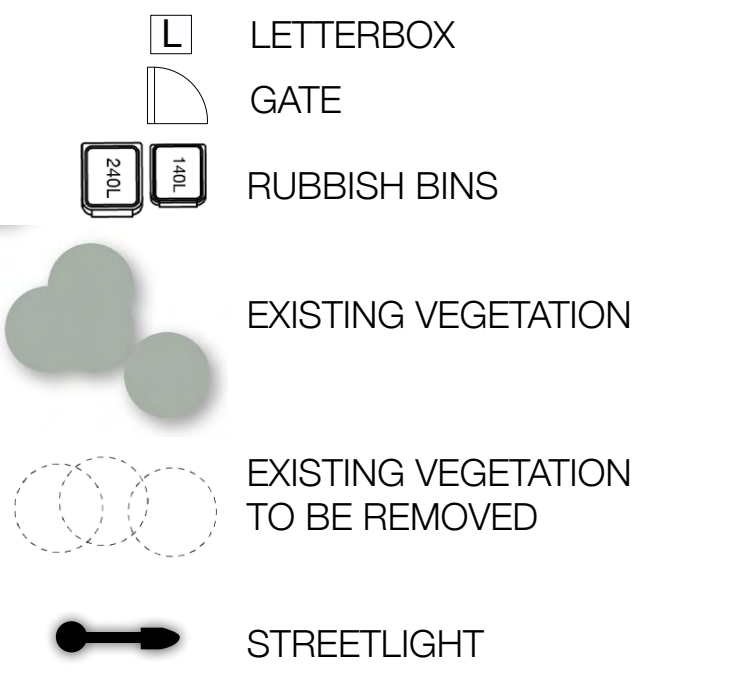

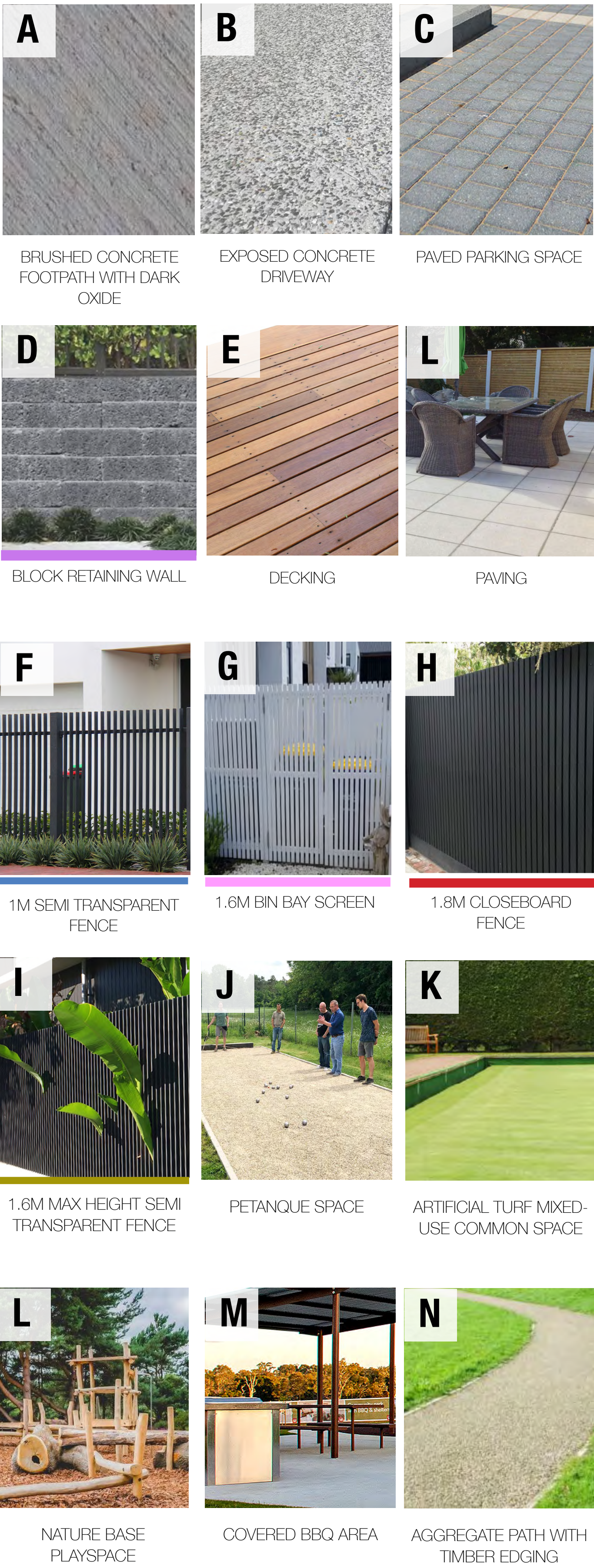

Planting Strategy Street Trees

Planting Strategy



LIRIODENDRON
TULIPIFERA
'TULIP' (LTU)



ACER X FREEMANII
'JEFFERSRED'
(AFR)



PYRUS CALLERYANA
'ARISTOCRAT'
(PCA)



SYAGRUS
ROMANZOFFIANA
(SRO)

Planting Strategy Private Yard



OLEA EUROPAEA
(OEU)



MAGNOLIA GRANDIFLORA
'BLANCHARD'
(MGR)

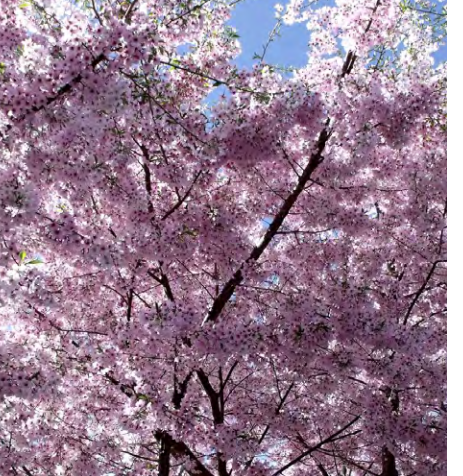

PRUNUS 'AWANUI'
(PAW)



MERYTA SINCLAIRII
(MSI)



LAURUS NOBILIS
(LNO)



PITTOSPORUM
CRASSIFOLIUM
(PCR)



PITTOSPORUM MOUNTATIN
GREEN
(PMO)



COPROSIA 'GEENTY'S
GREEN'
(CGE)



HEBE ODORA
(HOD)

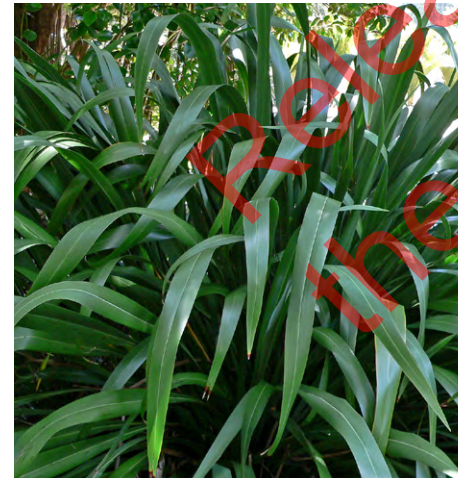

PHORMIUM COOKIANUM
(PCO)



CAREX GEMINATA
'RAUTAH'
(CGE)



APODASMIA SIMILIS
'OIOI'
(ASI)



LOMANDRA LONGIFOLIA
'TANIKA'
(LLO)



COPROSMA KIRKII
(CKI)



MUEHLENBECKIA
AXILLARIS
(MAX)



ARTHROPODIUM
CIRRATUM
(ACI)



CYATHEA MEDULLARIS
(CME)



CYATHEA DEALBATA
(CDE)

- NOTES:
1. IF PLANT SPECIES ARE NOT AVAILABLE, SIMILAR SPECIES MAY BE USED (CHANGES TO SPECIES MUST BE ACCEPTED BY SOLA LANDSCAPE ARCHITECTS OR COUNCIL TEAM LEADER).
 2. ALL GARDEN AREAS TO HAVE 300MM DEPTH QUALITY TOPSOIL AND 100MM DECORATIVE BARK MULCH UNLESS OTHERWISE STATED.
 3. 36 MONTH MAINTENANCE TO BE INCLUDED FOR COMMON LANDSCAPE AREAS AT THE COMPLETION OF LANDSCAPE CONSTRUCTION.

Planting Strategy Street Trees



LIRIODENDRON
TULIPIFERA
'TULIP' (LTU)



ACER X FREEMANII
'JEFFERSRED'
(AFR)



PYRUS CALLERYANA
'ARISTOCRAT'
(PCA)



SYAGRUS
ROMANZOFFIANA
(SRO)

Planting Strategy Private Yard



OLEA EUROPAEA
(OEU)



MAGNOLIA GRANDIFLORA
'BLANCHARD'
(MGR)



PRUNUS 'AWANUI'
(PAW)



MERYTA SINCLARII
(MSI)



LAURUS NOBILIS
(LNO)

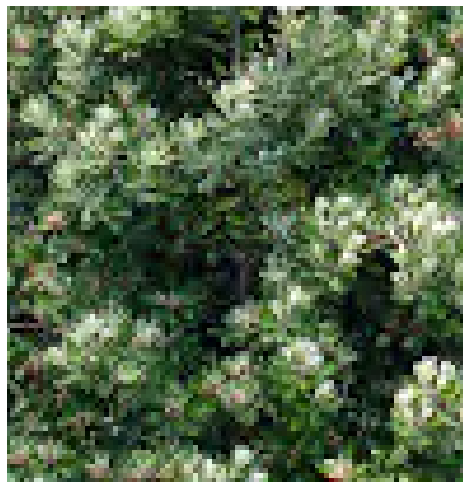

PITTOSPORUM
CRASSIFOLIUM
(PCR)



PITTOSPORUM MOUNTAIN
GREEN
(PMO)



COROKIA 'GEENTY'S
GREEN'
(CGE)



CAMELLIA BABY PEARL
'CAMELLIA'
(CBA)



HEBE ODORA
(HOD)



PHORMIUM COOKIANUM
(PCO)



APODASMIA SIMILIS
'OIOI'
(ASI)



ASTELIA BANKSII
'COASTAL ASTELIA'
(ABA)



AGAVE ATTENUATA
'FOX TAIL'
(AAT)



HEBE ODORA
'BOXWOOD HEBE'
(HOD)



LOMANDRA LONGIFOLIA
'TANIKA'
(LLO)



COPROSMA KIRKII
(CKI)



MUEHLENBECKIA
AXILLARIS
(MAX)



ARTHROPODIUM
CIRRATUM
(ACI)



CYATHEA MEDULLARIS
(CME)



CYATHEA DEALBATA
(CDE)

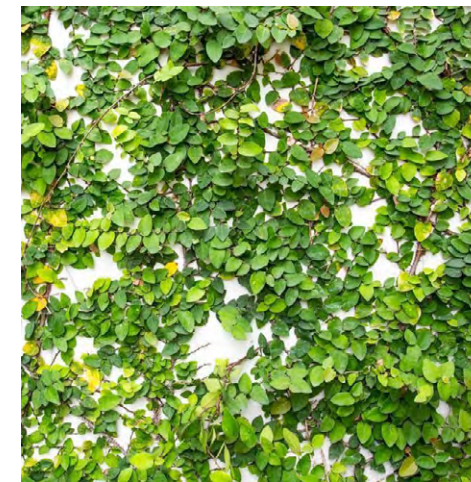

FICUS PUMILA
'CLIMBING FIG'
(FPU)

- NOTES:
1. IF PLANT SPECIES ARE NOT AVAILABLE, SIMILAR SPECIES MAY BE USED (CHANGES TO SPECIES MUST BE ACCEPTED BY SOLA LANDSCAPE ARCHITECTS OR COUNCIL TEAM LEADER).
 2. ALL GARDEN AREAS TO HAVE 300MM DEPTH QUALITY TOPSOIL AND 100MM DECORATIVE BARK MULCH UNLESS OTHERWISE STATED.
 3. 36 MONTH MAINTENANCE TO BE INCLUDED FOR COMMON LANDSCAPE AREAS AT THE COMPLETION OF LANDSCAPE CONSTRUCTION.



Planting Strategy Street Trees



LIRIODENDRON
TULIPIFERA
'TULIP' (LTU)



ACER X FREEMANII
'JEFFERSRED'
(AFR)



PYRUS CALLERYANA
'ARISTOCRAT'
(PCA)



SYAGRUS
ROMANZOFFIANA
(SRO)

Planting Strategy Private Yard



OLEA EUROPAEA
(OEU)



MAGNOLIA GRANDIFLORA
'BLANCHARD'
(MGR)



MERYTA SINCLARII
(MSI)



LAURUS NOBILIS
(LNO)



SOPHORA 'DRAGON'S
GOLD'
(SDR)



PODOCARPUS GRACILLIOR
(PGR)

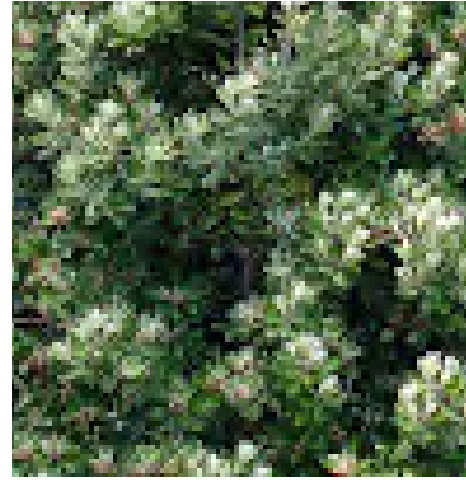

PITTOSPORUM
CRASSIFOLIUM
(PCR)



PITTOSPORUM MOUNTAIN
GREEN
(PMO)



COROKIA 'GEENTY'S
GREEN'
(CGE)



CAMELLIA BABY PEARL
'CAMELLIA'
(CBA)



HIBISCUS TRIONUM
(HTR)



PHORMIUM COOKIANUM
(PCO)



APODASMIA SIMILIS
'OIO'
(ASI)



ASTELIA BANKSII
'COASTAL ASTELIA'
(ABA)

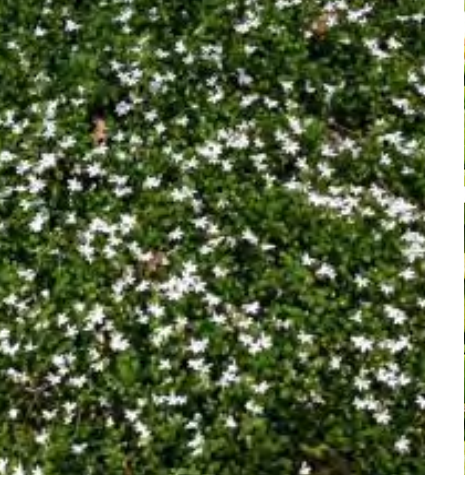

LOBELIA ANGULATA
(LAN)

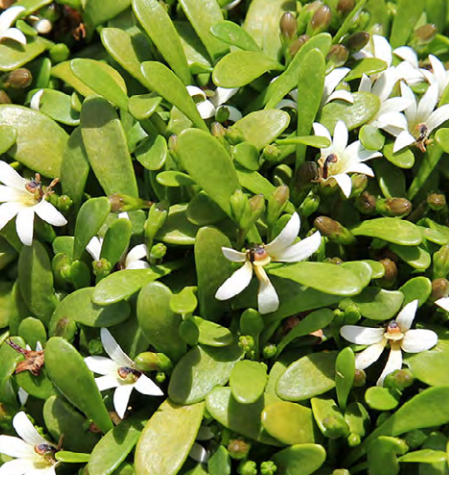

SELLIERA RADICANS
(SRA)



DIETES ROBINSONIANA
(DRO)



EUPHORBIA GLAUCA
(EGL)



LOMANDRA LONGIFOLIA
'TANIKA'
(LLO)



COPROSMA KIRKII
(CKI)



MUEHLENBECKIA
AXILLARIS
(MAX)



ARTHROPODIUM
CIRRATUM
(ACI)



CYATHEA MEDULLARIS
(CME)



CYATHEA DEALBATA
(CDE)

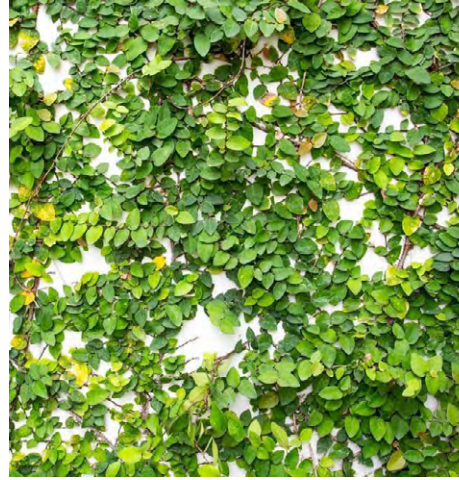

FICUS PUMILA
'CLIMBING FIG'
(FPU)

Planting Strategy Common Area replanting



CORDYLINAE AUSTRALIS
'CABBAGE TREE'
(CAU)



CAREX GEMINATA
'RAUTAH'
(CGE)



CAREX LESSONIANA
(CGE)



APODASMIA SIMILIS
'OIO'
(ASI)



ARTHROPODIUM
CIRRATUM



MUEHLENBECKIA
AXILLARIS
(MAX)



KUNZEA ERICOIDES
'KANUKA'
(KER)



LEPTOSPERMUM
SCOPARIUM
'MANUKA' (LSC)

NOTES:

1. IF PLANT SPECIES ARE NOT AVAILABLE, SIMILAR SPECIES MAY BE USED (CHANGES TO SPECIES MUST BE ACCEPTED BY SOLA LANDSCAPE ARCHITECTS OR COUNCIL TEAM LEADER).

2. ALL GARDEN AREAS TO HAVE 300MM DEPTH QUALITY TOPSOIL AND 100MM DECORATIVE BARK MULCH UNLESS OTHERWISE STATED.

3. 36 MONTH MAINTENANCE TO BE INCLUDED FOR COMMON LANDSCAPE AREAS AT THE COMPLETION OF LANDSCAPE CONSTRUCTION.