

**LEGEND:**

- SITE EXTENTS
- PROPOSED LOT BOUNDARY
- EXISTING TITLE BOUNDARY
- EXISTING LOT BOUNDARY
- ROAD BOUNDARY
- EXISTING EASEMENT BOUNDARY
- EXISTING EASEMENT BOUNDARY - DP 85451
- EXISTING EASEMENT AREA - 8070638.1
- EXISTING EASEMENT AREA - 8070638.2
- EXISTING ROW BOUNDARY - T. 411135
- LOT - STANDALONE / SEMIDETACHED DWELLING
- LOT - TOWNHOUSES
- LOT - APARTMENTS (UNIT TITLES)
- LOT - ACCESS
- LOT - PUBLIC URBAN OPEN SPACE
- LOT - COMMERCIAL
- LOT - OPEN SPACE/RESERVE/IWI/PUBLIC (TBC)
- LOT - PRIVATE COMMUNAL OUTDOOR SPACE
- LOT - ROAD TO VEST
- POSSIBLE ROAD ADJUSTMENT - TO VEST
- POSSIBLE ROAD ADJUSTMENT - TO BE CLOSED
- PROPOSED CABLE CAR EASEMENT

- NOTES:**
- THIS PLAN HAS BEEN PREPARED FOR INFORMATION PURPOSES ONLY. NO DETAILED DESIGN SHOULD BE UNDERTAKEN UTILISING THIS DATA.
  - THIS PLAN DOES NOT SHOW ANY INFORMATION ABOUT INSTRUMENTS REGISTERED AGAINST THE EXISTING RECORDS OF TITLE OR ANY PROPOSED EASEMENTS, COVENANTS OR OTHER FUTURE INSTRUMENTS.
  - THIS PLAN IS ISSUED FOR A SPECIFIC PROJECT AND MAY NOT BE ALTERED OR USED FOR ANY OTHER PURPOSE WITHOUT THE PRIOR WRITTEN CONSENT OF ENVELOPE ENGINEERING.
  - EXISTING BOUNDARIES SHOWN ON THIS PLAN ARE FROM LAND INFORMATION DCDB (31/10/2022) AND HAVE NOT BEEN SURVEYED. A BOUNDARY DEFINITION SURVEY SHOULD BE CARRIED OUT TO ESTABLISH EXACT BOUNDARY POSITIONS ON SITE.
  - LEGAL DESCRIPTION:
    - SECTION 1 SO 581456 (TITLE YET TO ISSUE) 1,9100 Ha.
    - SECTION 2 SO 581456 (TITLE YET TO ISSUE) 1,063 Ha.
    - PART LOT 1 DP 4741 (COMPRISED IN RT WN468/927) 5084m².
    - PART LOT 4 BLOCK XII DP 858 (COMPRISED IN RT WN468/923) 1,0901 Ha.
    - SECTION 1 SO 24508 & PART LOT 1 DP 4741 (COMPRISED IN RT WN468/926) 4527m².
    - SECTIONS 1 & 3 SO 477035 (COMPRISED IN RT 760897) 4,482 Ha.
    - SECTIONS 4, 6 & 7 SO 477035 (COMPRISED IN RT 760898) 5,2328 Ha.TOTAL AREA OF ALL TITLES: 14,6752 Ha.
  - FURTHER REGISTERED INTERESTS MAY BE ADDED TO TITLES UPON DISPOSITION FROM THE CROWN. ALL TITLES TO BE REVIEWED AND THIS PLAN SET UPDATED AT THE COMPLETION OF THAT PROCESS.
  - THESE NOTES ARE AN INTEGRAL PART OF THIS PLAN.

This design and drawing shall only be used for the purpose for which it was supplied and shall not be altered or reproduced without the permission of Envelope Engineering Limited. No liability shall be accepted for unauthorised use of this design and drawing.

REVISIONS:		BY:	DATE:
REV	NOTES		
R1	ISSUED FOR CLIENT INFORMATION	JEG	16/12/2022
R2	ISSUED FOR CLIENT INFORMATION	JEG	24/03/2023

PROJECT:  
THE WELLINGTON COMPANY ASSET  
MANAGEMENT LIMITED.  
MATAI MOANA (MOUNT CRAWFORD).

TITLE:  
CONCEPT PLAN OF PROPOSED SUBDIVISION  
AND EASEMENTS OVER ADJOINING LAND.  
OVERALL PLAN



DESIGNED: JEG	DRAWN: JEG	
CHECKED: EFC	PLOT DATE: 24-03-2023	
SCALE A1: 1:2000	SCALE A3: 1:4000	
STATUS: CLIENT INFORMATION		
PROJECT No:	DRAWING No:	REVISION:
1501-01	CP001	R2

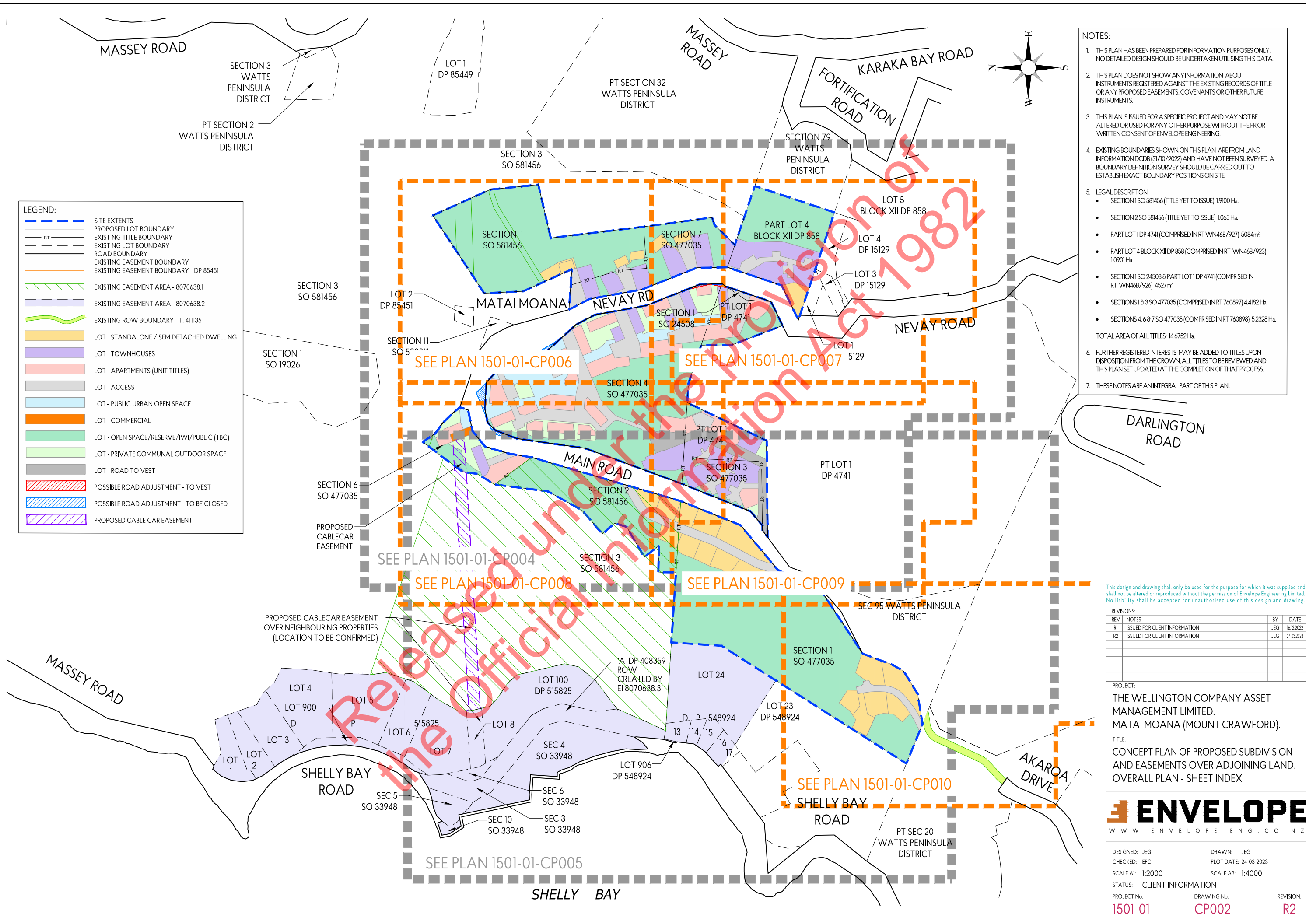

**LEGEND:**

- SITE EXTENTS
- PROPOSED LOT BOUNDARY
- EXISTING TITLE BOUNDARY
- EXISTING LOT BOUNDARY
- ROAD BOUNDARY
- EXISTING EASEMENT BOUNDARY
- EXISTING EASEMENT BOUNDARY - DP 85451
- EXISTING EASEMENT AREA - 8070638.1
- EXISTING EASEMENT AREA - 8070638.2
- EXISTING ROW BOUNDARY - T. 411135
- LOT - STANDALONE / SEMIDETACHED DWELLING
- LOT - TOWNHOUSES
- LOT - APARTMENTS (UNIT TITLES)
- LOT - ACCESS
- LOT - PUBLIC URBAN OPEN SPACE
- LOT - COMMERCIAL
- LOT - OPEN SPACE/RESERVE/IWI/PUBLIC (TBC)
- LOT - PRIVATE COMMUNAL OUTDOOR SPACE
- LOT - ROAD TO VEST
- POSSIBLE ROAD ADJUSTMENT - TO VEST
- POSSIBLE ROAD ADJUSTMENT - TO BE CLOSED
- PROPOSED CABLE CAR EASEMENT

- NOTES:**
- THIS PLAN HAS BEEN PREPARED FOR INFORMATION PURPOSES ONLY. NO DETAILED DESIGN SHOULD BE UNDERTAKEN UTILISING THIS DATA.
  - THIS PLAN DOES NOT SHOW ANY INFORMATION ABOUT INSTRUMENTS REGISTERED AGAINST THE EXISTING RECORDS OF TITLE OR ANY PROPOSED EASEMENTS, COVENANTS OR OTHER FUTURE INSTRUMENTS.
  - THIS PLAN IS ISSUED FOR A SPECIFIC PROJECT AND MAY NOT BE ALTERED OR USED FOR ANY OTHER PURPOSE WITHOUT THE PRIOR WRITTEN CONSENT OF ENVELOPE ENGINEERING.
  - EXISTING BOUNDARIES SHOWN ON THIS PLAN ARE FROM LAND INFORMATION DCDB (31/10/2022) AND HAVE NOT BEEN SURVEYED. A BOUNDARY DEFINITION SURVEY SHOULD BE CARRIED OUT TO ESTABLISH EXACT BOUNDARY POSITIONS ON SITE.
  - LEGAL DESCRIPTION:
    - SECTION 1 SO 581456 (TITLE YET TO ISSUE) 1,9100 Ha.
    - SECTION 2 SO 581456 (TITLE YET TO ISSUE) 1,063 Ha.
    - PART LOT 1 DP 4741 (COMPRISED IN RT WN468/927) 5084m².
    - PART LOT 4 BLOCK XII DP 858 (COMPRISED IN RT WN468/923) 1,0901 Ha.
    - SECTION 1 SO 24508 & PART LOT 1 DP 4741 (COMPRISED IN RT WN468/926) 4527m².
    - SECTIONS 1 & 3 SO 477035 (COMPRISED IN RT 760897) 4,4182 Ha.
    - SECTIONS 4, 6 & 7 SO 477035 (COMPRISED IN RT 760898) 5,2328 Ha.TOTAL AREA OF ALL TITLES: 14,6752 Ha.
  - FURTHER REGISTERED INTERESTS MAY BE ADDED TO TITLES UPON DISPOSITION FROM THE CROWN. ALL TITLES TO BE REVIEWED AND THIS PLAN SET UPDATED AT THE COMPLETION OF THAT PROCESS.
  - THESE NOTES ARE AN INTEGRAL PART OF THIS PLAN.

This design and drawing shall only be used for the purpose for which it was supplied and shall not be altered or reproduced without the permission of Envelope Engineering Limited. No liability shall be accepted for unauthorised use of this design and drawing.

REVISIONS:		BY	DATE
REV	NOTES	JEG	16/12/2022
R1	ISSUED FOR CLIENT INFORMATION	JEG	24/03/2023
R2	ISSUED FOR CLIENT INFORMATION	JEG	

PROJECT:  
THE WELLINGTON COMPANY ASSET  
MANAGEMENT LIMITED.  
MATAI MOANA (MOUNT CRAWFORD).

TITLE:  
CONCEPT PLAN OF PROPOSED SUBDIVISION  
AND EASEMENTS OVER ADJOINING LAND.  
OVERALL PLAN - SHEET INDEX



DESIGNED: JEG	DRAWN: JEG	
CHECKED: EFC	PLOT DATE: 24-03-2023	
SCALE A1: 1:2000	SCALE A3: 1:4000	
STATUS: CLIENT INFORMATION		
PROJECT No: 1501-01	DRAWING No: CP002	REVISION: R2





- NOTES:
1. THIS PLAN HAS BEEN PREPARED FOR INFORMATION PURPOSES ONLY. NO DETAILED DESIGN SHOULD BE UNDERTAKEN UTILISING THIS DATA.
  2. THIS PLAN DOES NOT SHOW ANY INFORMATION ABOUT INSTRUMENTS REGISTERED AGAINST THE EXISTING RECORDS OF TITLE OR ANY PROPOSED EASEMENTS, COVENANTS OR OTHER FUTURE INSTRUMENTS.
  3. THIS PLAN IS ISSUED FOR A SPECIFIC PROJECT AND MAY NOT BE ALTERED OR USED FOR ANY OTHER PURPOSE WITHOUT THE PRIOR WRITTEN CONSENT OF ENVELOPE ENGINEERING.
  4. EXISTING BOUNDARIES SHOWN ON THIS PLAN ARE FROM LAND INFORMATION DCDB (31/10/2022) AND HAVE NOT BEEN SURVEYED. A BOUNDARY DEFINITION SURVEY SHOULD BE CARRIED OUT TO ESTABLISH EXACT BOUNDARY POSITIONS ON SITE.
  5. LEGAL DESCRIPTION:
    - SECTION 1 SO 581456 (TITLE YET TO ISSUE) 1,9100 Ha.
    - SECTION 2 SO 581456 (TITLE YET TO ISSUE) 1,063 Ha.
    - PART LOT 1 DP 4741 (COMPRISED IN RT WN468/927) 5084m<sup>2</sup>.
    - PART LOT 4 BLOCK XII DP 858 (COMPRISED IN RT WN468/923) 1,0901 Ha.
    - SECTION 1 SO 24508 & PART LOT 1 DP 4741 (COMPRISED IN RT WN468/926) 4527m<sup>2</sup>.
    - SECTIONS 1 & 3 SO 477035 (COMPRISED IN RT 760897) 4,482 Ha.
    - SECTIONS 4, 6 & 7 SO 477035 (COMPRISED IN RT 760898) 5,2328 Ha.TOTAL AREA OF ALL TITLES: 14,6752 Ha.
  6. FURTHER REGISTERED INTERESTS MAY BE ADDED TO TITLES UPON DISPOSITION FROM THE CROWN. ALL TITLES TO BE REVIEWED AND THIS PLAN SET UPDATED AT THE COMPLETION OF THAT PROCESS.
  7. THESE NOTES ARE AN INTEGRAL PART OF THIS PLAN.

This design and drawing shall only be used for the purpose for which it was supplied and shall not be altered or reproduced without the permission of Envelope Engineering Limited. No liability shall be accepted for unauthorised use of this design and drawing.

REVISIONS:		BY	DATE
REV	NOTES		
R1	ISSUED FOR CLIENT INFORMATION	JEG	16/12/2022
R2	ISSUED FOR CLIENT INFORMATION	JEG	24/03/2023

PROJECT:  
THE WELLINGTON COMPANY ASSET  
MANAGEMENT LIMITED.  
MATAI MOANA (MOUNT CRAWFORD).

TITLE:  
CONCEPT PLAN OF PROPOSED SUBDIVISION  
AND EASEMENTS OVER ADJOINING LAND.  
OVERALL PLAN WITH AERIAL IMAGERY

**ENVELOPE**  
WWW.ENVELOPE-ENG.CO.NZ

DESIGNED: JEG	DRAWN: JEG	
CHECKED: EFC	PLOT DATE: 24-03-2023	
SCALE A1: 1:2500	SCALE A3: 1:5000	
STATUS: CLIENT INFORMATION		
PROJECT No: 1501-01	DRAWING No: CP003	REVISION: R2



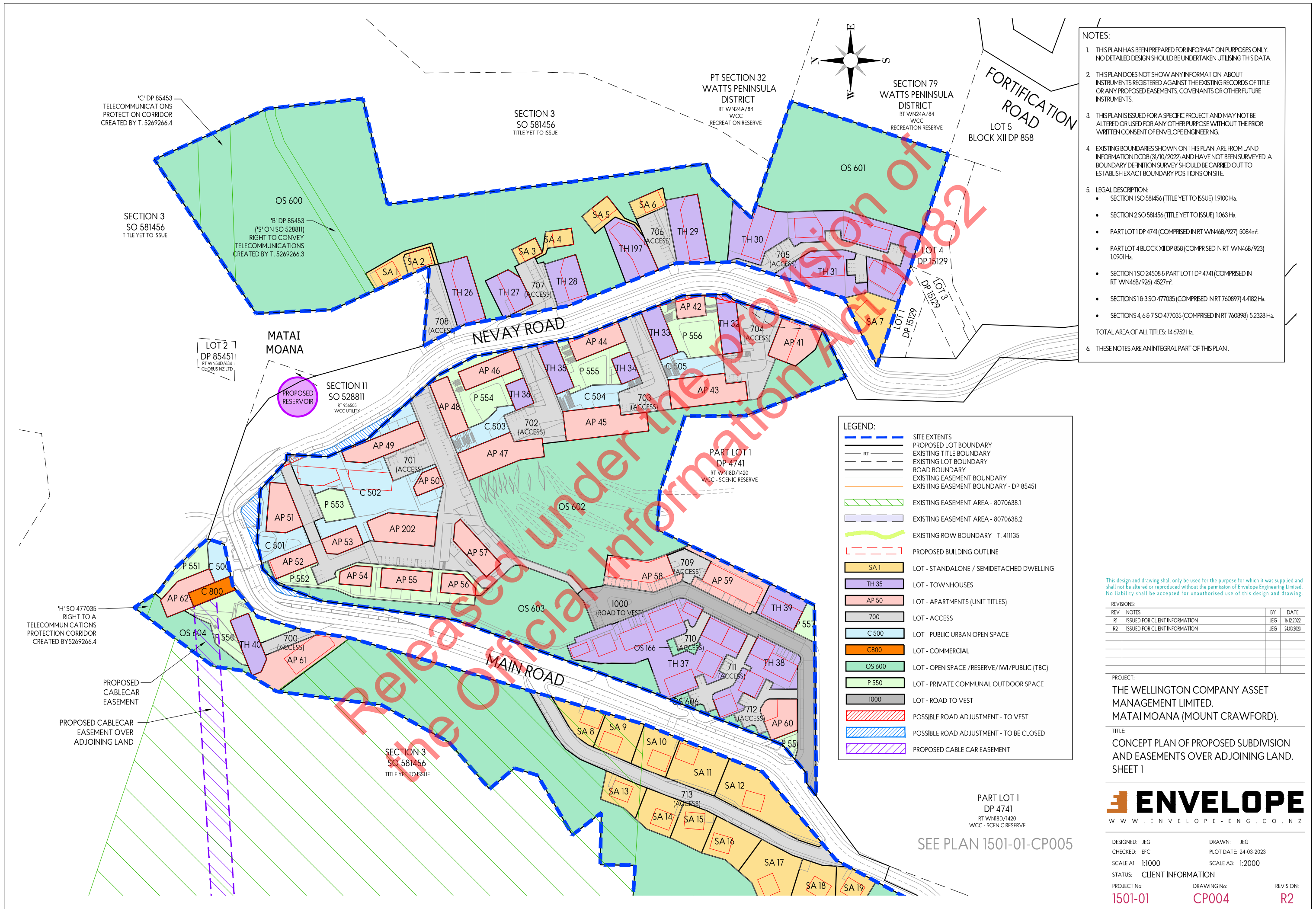



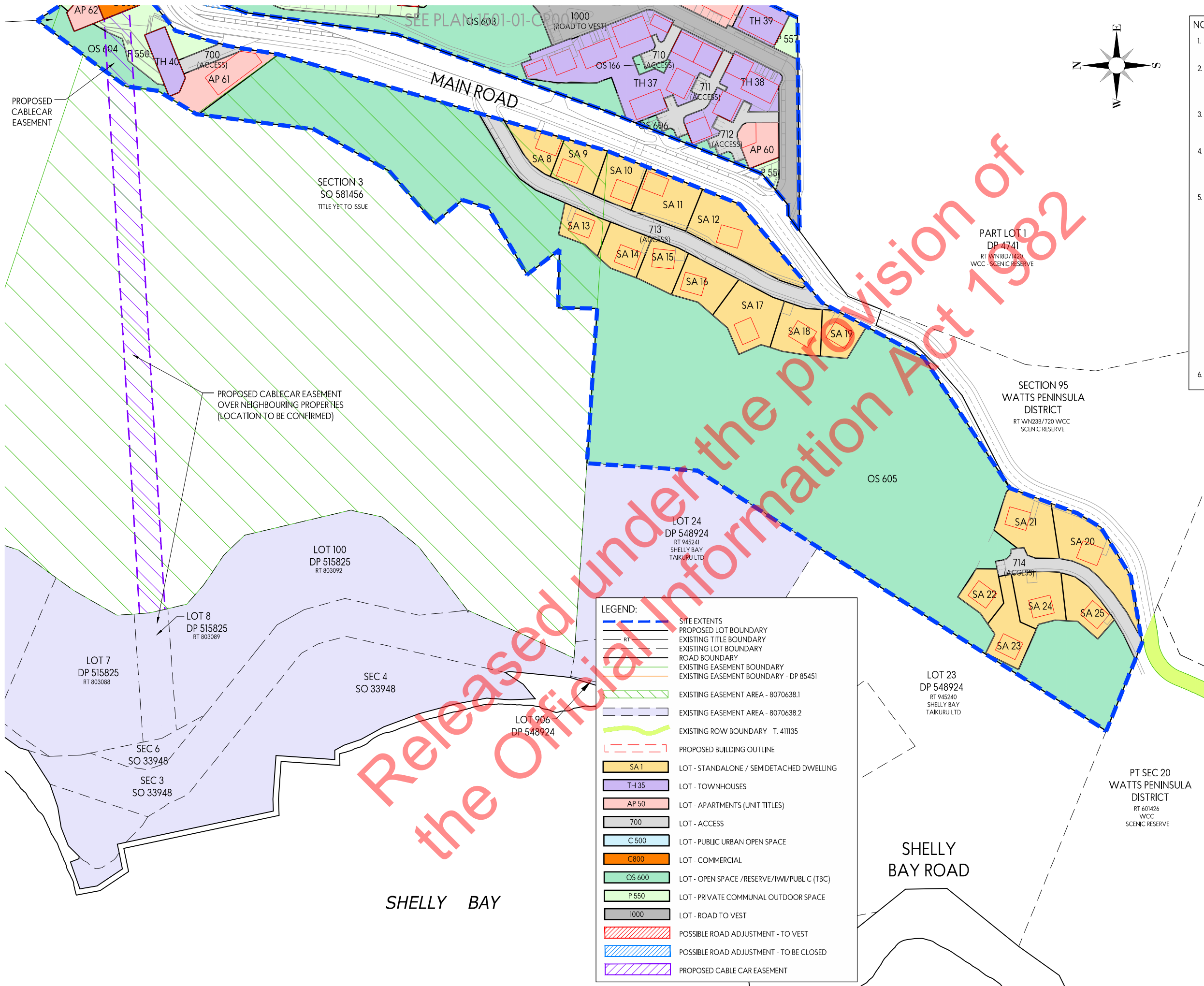

- NOTES:
1. THIS PLAN HAS BEEN PREPARED FOR INFORMATION PURPOSES ONLY. NO DETAILED DESIGN SHOULD BE UNDERTAKEN UTILISING THIS DATA.
  2. THIS PLAN DOES NOT SHOW ANY INFORMATION ABOUT INSTRUMENTS REGISTERED AGAINST THE EXISTING RECORDS OF TITLE OR ANY PROPOSED EASEMENTS, COVENANTS OR OTHER FUTURE INSTRUMENTS.
  3. THIS PLAN IS ISSUED FOR A SPECIFIC PROJECT AND MAY NOT BE ALTERED OR USED FOR ANY OTHER PURPOSE WITHOUT THE PRIOR WRITTEN CONSENT OF ENVELOPE ENGINEERING.
  4. EXISTING BOUNDARIES SHOWN ON THIS PLAN ARE FROM LAND INFORMATION DCDB (31/10/2022) AND HAVE NOT BEEN SURVEYED. A BOUNDARY DEFINITION SURVEY SHOULD BE CARRIED OUT TO ESTABLISH EXACT BOUNDARY POSITIONS ON SITE.
  5. LEGAL DESCRIPTION:
    - SECTION 1 SO 581456 (TITLE YET TO ISSUE) 1,9100 Ha.
    - SECTION 2 SO 581456 (TITLE YET TO ISSUE) 1,063 Ha.
    - PART LOT 1 DP 4741 (COMPRISED IN RT WN468/927) 5084m<sup>2</sup>.
    - PART LOT 4 BLOCK XII DP 858 (COMPRISED IN RT WN468/923) 1,0901 Ha.
    - SECTION 1 SO 24508 & PART LOT 1 DP 4741 (COMPRISED IN RT WN468/926) 4527m<sup>2</sup>.
    - SECTIONS 1 & 3 SO 477035 (COMPRISED IN RT 760897) 4,482 Ha.
    - SECTIONS 4, 6 & 7 SO 477035 (COMPRISED IN RT 760898) 5,2328 Ha.TOTAL AREA OF ALL TITLES: 14,6752 Ha.
  6. THESE NOTES ARE AN INTEGRAL PART OF THIS PLAN.

This design and drawing shall only be used for the purpose for which it was supplied and shall not be altered or reproduced without the permission of Envelope Engineering Limited. No liability shall be accepted for unauthorised use of this design and drawing.

REVISIONS:			
REV	NOTES	BY	DATE
R1	ISSUED FOR CLIENT INFORMATION	JEG	16/12/2022
R2	ISSUED FOR CLIENT INFORMATION	JEG	24/03/2023

PROJECT:  
THE WELLINGTON COMPANY ASSET  
MANAGEMENT LIMITED.  
MATAI MOANA (MOUNT CRAWFORD).

TITLE:  
CONCEPT PLAN OF PROPOSED SUBDIVISION  
AND EASEMENTS OVER ADJOINING LAND.  
SHEET 2

**ENVELOPE**  
W W W . E N V E L O P E - E N G . C O . N Z

DESIGNED: JEG	DRAWN: JEG
CHECKED: EFC	PLOT DATE: 24-03-2023
SCALE A1: 1:1000	SCALE A3: 1:2000
STATUS: CLIENT INFORMATION	
PROJECT No: 1501-01	DRAWING No: CP005
	REVISION: R2



- NOTES:
1. THIS PLAN HAS BEEN PREPARED FOR INFORMATION PURPOSES ONLY. NO DETAILED DESIGN SHOULD BE UNDERTAKEN UTILISING THIS DATA.
  2. THIS PLAN DOES NOT SHOW ANY INFORMATION ABOUT INSTRUMENTS REGISTERED AGAINST THE EXISTING RECORDS OF TITLE OR ANY PROPOSED EASEMENTS, COVENANTS OR OTHER FUTURE INSTRUMENTS.
  3. THIS PLAN IS ISSUED FOR A SPECIFIC PROJECT AND MAY NOT BE ALTERED OR USED FOR ANY OTHER PURPOSE WITHOUT THE PRIOR WRITTEN CONSENT OF ENVELOPE ENGINEERING.
  4. EXISTING BOUNDARIES SHOWN ON THIS PLAN ARE FROM LAND INFORMATION DCDB (31/10/2022) AND HAVE NOT BEEN SURVEYED. A BOUNDARY DEFINITION SURVEY SHOULD BE CARRIED OUT TO ESTABLISH EXACT BOUNDARY POSITIONS ON SITE.
  5. LEGAL DESCRIPTION:
    - SECTION 1 SO 581456 (TITLE YET TO ISSUE) 1.9100 Ha.
    - SECTION 2 SO 581456 (TITLE YET TO ISSUE) 1.063 Ha.
    - PART LOT 1 DP 4741 (COMPRISED IN RT WN468/927) 5084m<sup>2</sup>.
    - PART LOT 4 BLOCK XII DP 858 (COMPRISED IN RT WN468/923) 1.0901 Ha.
    - SECTION 1 SO 24508 & PART LOT 1 DP 4741 (COMPRISED IN RT WN468/926) 4527m<sup>2</sup>.
    - SECTIONS 1 & 3 SO 477035 (COMPRISED IN RT 760897) 4.4182 Ha.
    - SECTIONS 4, 6 & 7 SO 477035 (COMPRISED IN RT 760898) 5.2328 Ha.TOTAL AREA OF ALL TITLES: 14.6752 Ha.
  6. THESE NOTES ARE AN INTEGRAL PART OF THIS PLAN.

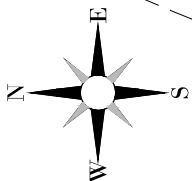

PT SECTION 32  
WATTS PENINSULA  
DISTRICT

SECTION 3  
SO 581456

OS 600

LOT 2  
DP 85451

MATAI  
MOANA

SECTION 3  
SO 581456

SECTION 11  
SO 528811

NEVAY ROAD

- LEGEND:
- SITE EXTENTS
  - PROPOSED LOT BOUNDARY
  - RT EXISTING TITLE BOUNDARY
  - EXISTING LOT BOUNDARY
  - ROAD BOUNDARY
  - PROPOSED BUILDING OUTLINE
  - SA 1 LOT - STANDALONE / SEMIDETACHED DWELLING
  - TH 35 LOT - TOWNHOUSES
  - AP 50 LOT - APARTMENTS (UNIT TITLES)
  - 700 LOT - ACCESS
  - C 500 LOT - PUBLIC URBAN OPEN SPACE
  - C 800 LOT - COMMERCIAL
  - OS 600 LOT - OPEN SPACE/RESERVE/IWI/PUBLIC (TBC)
  - P 550 LOT - PRIVATE COMMUNAL OUTDOOR SPACE
  - 1000 LOT - ROAD TO VEST
  - POSSIBLE ROAD ADJUSTMENT - TO VEST
  - POSSIBLE ROAD ADJUSTMENT - TO BE CLOSED

This design and drawing shall only be used for the purpose for which it was supplied and shall not be altered or reproduced without the permission of Envelope Engineering Limited. No liability shall be accepted for unauthorised use of this design and drawing.

REVISIONS:		BY	DATE
REV	NOTES		
R1	NOT ISSUED		
R2	ISSUED FOR CLIENT INFORMATION	JEG	24.03.2023

PROJECT:  
THE WELLINGTON COMPANY ASSET  
MANAGEMENT LIMITED.  
MATAI MOANA (MOUNT CRAWFORD).

TITLE:  
CONCEPT PLAN OF PROPOSED SUBDIVISION  
PROPOSED LOTS AND DWELLING COUNT  
SHEET 1

**ENVELOPE**  
WWW.ENVELOPE-ENG.CO.NZ

DESIGNED: JEG  
CHECKED: EFC  
SCALE A1: 1:1000  
STATUS: CLIENT INFORMATION  
PROJECT No: 1501-01

DRAWN: JEG  
PLOT DATE: 24-03-2023  
SCALE A3: 1:2000  
DRAWING No: CP006

REVISION: R2



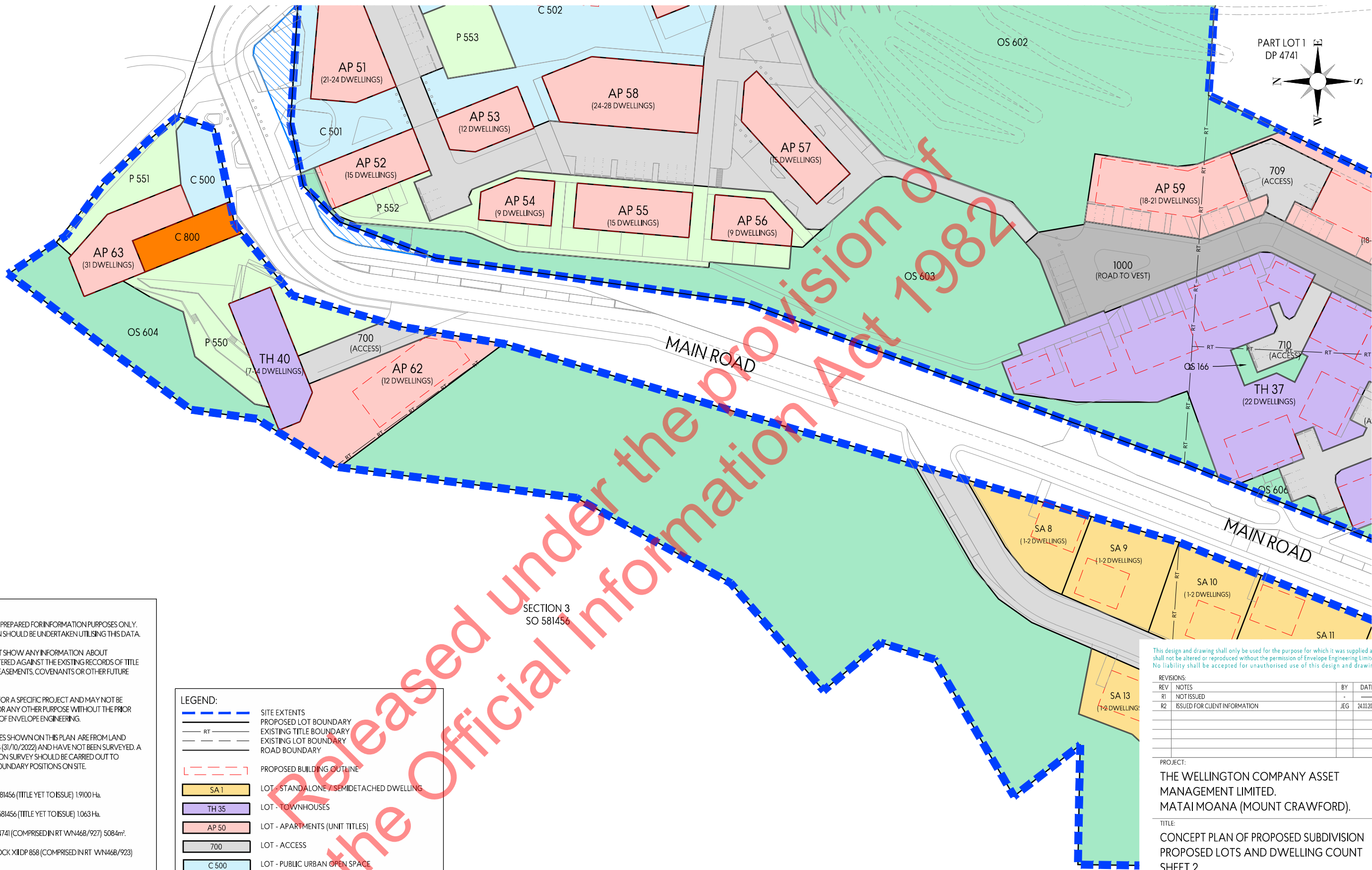

- NOTES:
- THIS PLAN HAS BEEN PREPARED FOR INFORMATION PURPOSES ONLY. NO DETAILED DESIGN SHOULD BE UNDERTAKEN UTILISING THIS DATA.
  - THIS PLAN DOES NOT SHOW ANY INFORMATION ABOUT INSTRUMENTS REGISTERED AGAINST THE EXISTING RECORDS OF TITLE OR ANY PROPOSED EASEMENTS, COVENANTS OR OTHER FUTURE INSTRUMENTS.
  - THIS PLAN IS ISSUED FOR A SPECIFIC PROJECT AND MAY NOT BE ALTERED OR USED FOR ANY OTHER PURPOSE WITHOUT THE PRIOR WRITTEN CONSENT OF ENVELOPE ENGINEERING.
  - EXISTING BOUNDARIES SHOWN ON THIS PLAN ARE FROM LAND INFORMATION DCDB (31/10/2022) AND HAVE NOT BEEN SURVEYED. A BOUNDARY DEFINITION SURVEY SHOULD BE CARRIED OUT TO ESTABLISH EXACT BOUNDARY POSITIONS ON SITE.
  - LEGAL DESCRIPTION:
    - SECTION 1 SO 581456 (TITLE YET TO ISSUE) 1,9100 Ha.
    - SECTION 2 SO 581456 (TITLE YET TO ISSUE) 1,063 Ha.
    - PART LOT 1 DP 4741 (COMPRISED IN RT VN46B/927) 5084m<sup>2</sup>.
    - PART LOT 4 BLOCK XII DP 858 (COMPRISED IN RT VN46B/923) 1,0901 Ha.
    - SECTION 1 SO 24508 & PART LOT 1 DP 4741 (COMPRISED IN RT VN46B/926) 4527m<sup>2</sup>.
    - SECTIONS 1 & 3 SO 477035 (COMPRISED IN RT 760897) 4,4182 Ha.
    - SECTIONS 4, 6 & 7 SO 477035 (COMPRISED IN RT 760898) 5,2328 Ha.TOTAL AREA OF ALL TITLES: 14,6752 Ha.
  - THESE NOTES ARE AN INTEGRAL PART OF THIS PLAN.

LEGEND:	
	SITE EXTENTS
	PROPOSED LOT BOUNDARY
	EXISTING TITLE BOUNDARY
	EXISTING LOT BOUNDARY
	ROAD BOUNDARY
	PROPOSED BUILDING OUTLINE
	LOT - STANDALONE / SEMIDETACHED DWELLING
	LOT - TOWNHOUSES
	LOT - APARTMENTS (UNIT TITLES)
	LOT - ACCESS
	LOT - PUBLIC URBAN OPEN SPACE
	LOT - COMMERCIAL
	LOT - OPEN SPACE/RESERVE/IWI/PUBLIC (TBC)
	LOT - PRIVATE COMMUNAL OUTDOOR SPACE
	LOT - ROAD TO VEST
	POSSIBLE ROAD ADJUSTMENT - TO VEST
	POSSIBLE ROAD ADJUSTMENT - TO BE CLOSED

This design and drawing shall only be used for the purpose for which it was supplied and shall not be altered or reproduced without the permission of Envelope Engineering Limited. No liability shall be accepted for unauthorised use of this design and drawing.

REVISIONS:		BY	DATE
REV	NOTES		
R1	NOT ISSUED		
R2	ISSUED FOR CLIENT INFORMATION	JEG	24.03.2023

PROJECT:  
THE WELLINGTON COMPANY ASSET  
MANAGEMENT LIMITED.  
MATAI MOANA (MOUNT CRAWFORD).

TITLE:  
CONCEPT PLAN OF PROPOSED SUBDIVISION  
PROPOSED LOTS AND DWELLING COUNT  
SHEET 2

**ENVELOPE**  
W W W . E N V E L O P E - E N G . C O . N Z

DESIGNED: JEG	DRAWN: JEG	
CHECKED: EFC	PLOT DATE: 24-03-2023	
SCALE A1: 1:1000	SCALE A3: 1:2000	
STATUS: CLIENT INFORMATION		
PROJECT No: 1501-01	DRAWING No: CP007	REVISION: R2



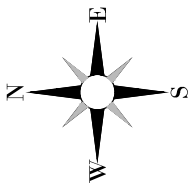
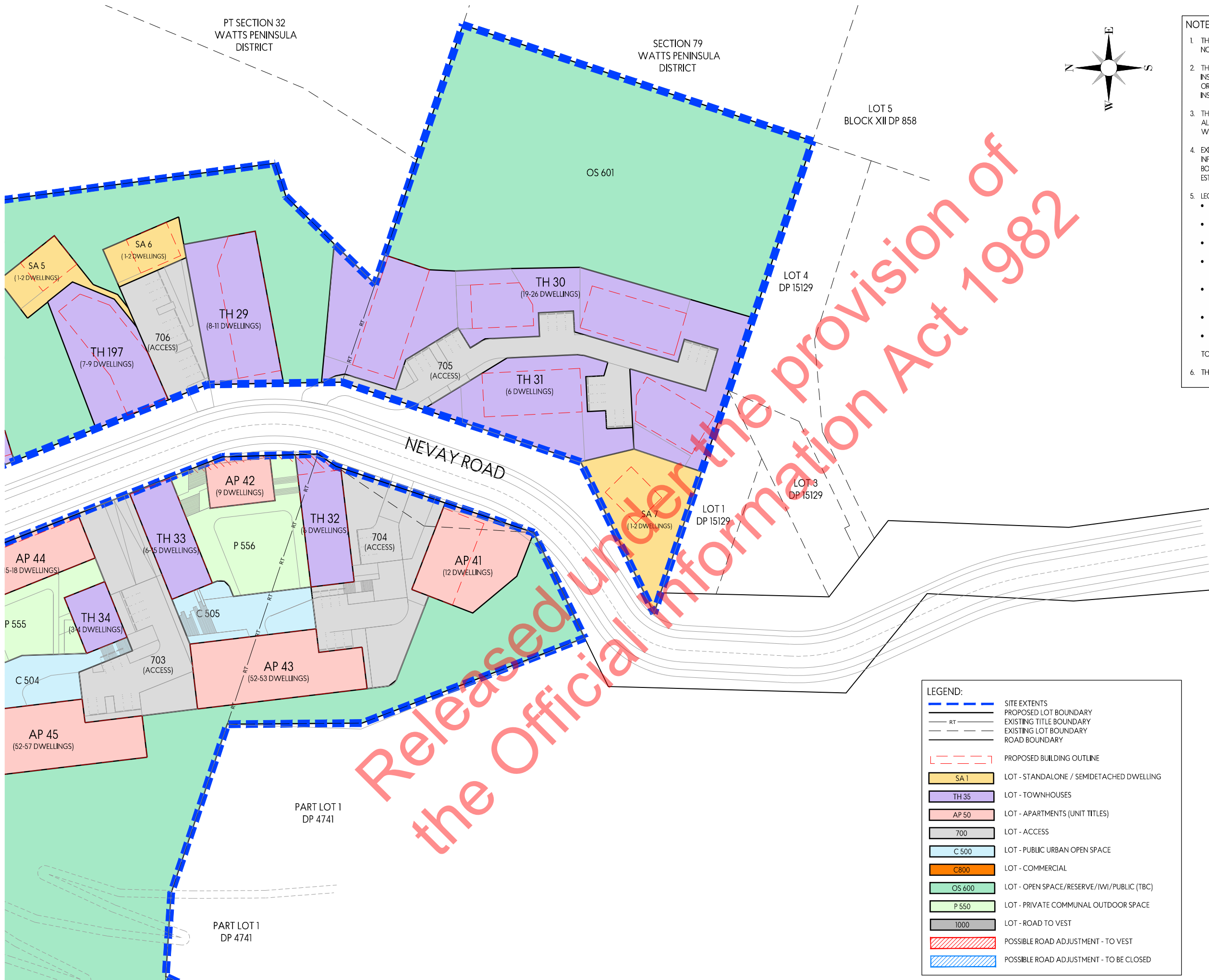

- NOTES:
1. THIS PLAN HAS BEEN PREPARED FOR INFORMATION PURPOSES ONLY. NO DETAILED DESIGN SHOULD BE UNDERTAKEN UTILISING THIS DATA.
  2. THIS PLAN DOES NOT SHOW ANY INFORMATION ABOUT INSTRUMENTS REGISTERED AGAINST THE EXISTING RECORDS OF TITLE OR ANY PROPOSED EASEMENTS, COVENANTS OR OTHER FUTURE INSTRUMENTS.
  3. THIS PLAN IS ISSUED FOR A SPECIFIC PROJECT AND MAY NOT BE ALTERED OR USED FOR ANY OTHER PURPOSE WITHOUT THE PRIOR WRITTEN CONSENT OF ENVELOPE ENGINEERING.
  4. EXISTING BOUNDARIES SHOWN ON THIS PLAN ARE FROM LAND INFORMATION DCDB (31/10/2022) AND HAVE NOT BEEN SURVEYED. A BOUNDARY DEFINITION SURVEY SHOULD BE CARRIED OUT TO ESTABLISH EXACT BOUNDARY POSITIONS ON SITE.
  5. LEGAL DESCRIPTION:
    - SECTION 1 SO 581456 (TITLE YET TO ISSUE) 1,9100 Ha.
    - SECTION 2 SO 581456 (TITLE YET TO ISSUE) 1,063 Ha.
    - PART LOT 1 DP 4741 (COMPRISED IN RT WN468/927) 5084m<sup>2</sup>.
    - PART LOT 4 BLOCK XII DP 858 (COMPRISED IN RT WN468/923) 1,0901 Ha.
    - SECTION 1 SO 24508 & PART LOT 1 DP 4741 (COMPRISED IN RT WN468/926) 4527m<sup>2</sup>.
    - SECTIONS 1 & 3 SO 477035 (COMPRISED IN RT 760897) 4,482 Ha.
    - SECTIONS 4, 6 & 7 SO 477035 (COMPRISED IN RT 760898) 5,2328 Ha.TOTAL AREA OF ALL TITLES: 14,6752 Ha.
  6. THESE NOTES ARE AN INTEGRAL PART OF THIS PLAN.

LEGEND:	
	SITE EXTENTS
	PROPOSED LOT BOUNDARY
	EXISTING TITLE BOUNDARY
	EXISTING LOT BOUNDARY
	ROAD BOUNDARY
	PROPOSED BUILDING OUTLINE
	SA 1 LOT - STANDALONE / SEMIDETACHED DWELLING
	TH 35 LOT - TOWNHOUSES
	AP 50 LOT - APARTMENTS (UNIT TITLES)
	700 LOT - ACCESS
	C 500 LOT - PUBLIC URBAN OPEN SPACE
	C800 LOT - COMMERCIAL
	OS 600 LOT - OPEN SPACE/RESERVE/IWI/PUBLIC (TBC)
	P 550 LOT - PRIVATE COMMUNAL OUTDOOR SPACE
	1000 LOT - ROAD TO VEST
	POSSIBLE ROAD ADJUSTMENT - TO VEST
	POSSIBLE ROAD ADJUSTMENT - TO BE CLOSED

This design and drawing shall only be used for the purpose for which it was supplied and shall not be altered or reproduced without the permission of Envelope Engineering Limited. No liability shall be accepted for unauthorised use of this design and drawing.

REVISIONS:		BY	DATE
REV	NOTES		
R1	NOT ISSUED	-	-
R2	ISSUED FOR CLIENT INFORMATION	JEG	24.03.2023

PROJECT:  
THE WELLINGTON COMPANY ASSET  
MANAGEMENT LIMITED.  
MATAI MOANA (MOUNT CRAWFORD).

TITLE:  
CONCEPT PLAN OF PROPOSED SUBDIVISION  
PROPOSED LOTS AND DWELLING COUNT  
SHEET 3



DESIGNED: JEG	DRAWN: JEG	
CHECKED: EFC	PLOT DATE: 24-03-2023	
SCALE A1: 1:1000	SCALE A3: 1:2000	
STATUS: CLIENT INFORMATION		
PROJECT No: 1501-01	DRAWING No: CP008	REVISION: R2



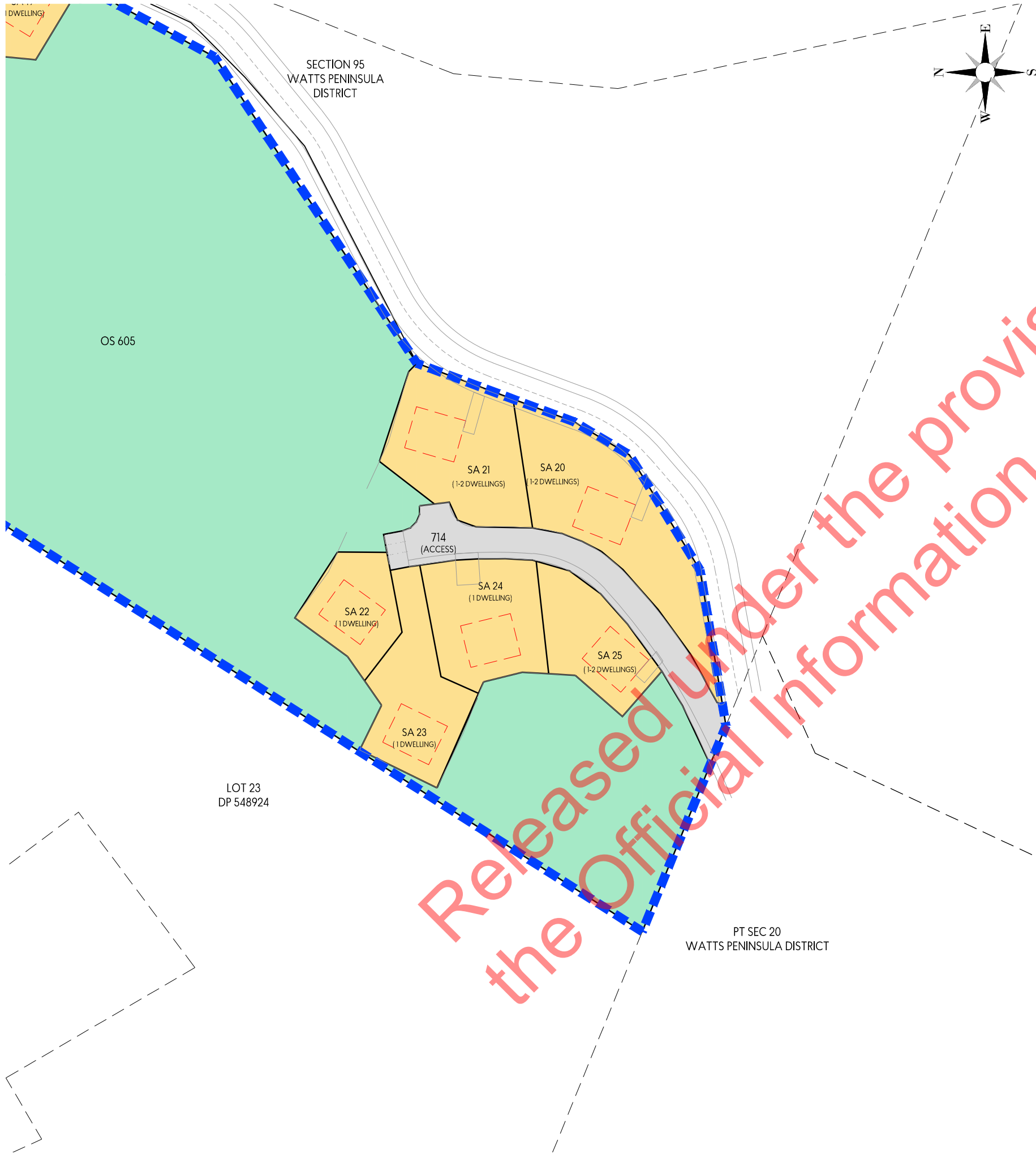

**LEGEND:**

- SITE EXTENTS
- PROPOSED LOT BOUNDARY
- EXISTING TITLE BOUNDARY
- RT --- EXISTING LOT BOUNDARY
- ROAD BOUNDARY
- PROPOSED BUILDING OUTLINE
- SA 1 LOT - STANDALONE / SEMIDETACHED DWELLING
- TH 35 LOT - TOWNHOUSES
- AP 50 LOT - APARTMENTS (UNIT TITLES)
- 700 LOT - ACCESS
- C 500 LOT - PUBLIC URBAN OPEN SPACE
- C 800 LOT - COMMERCIAL
- OS 600 LOT - OPEN SPACE / RESERVE / IWI / PUBLIC (TBC)
- P 550 LOT - PRIVATE COMMUNAL OUTDOOR SPACE
- 1000 LOT - ROAD TO VEST
- POSSIBLE ROAD ADJUSTMENT - TO VEST
- POSSIBLE ROAD ADJUSTMENT - TO BE CLOSED

- NOTES:**
- THIS PLAN HAS BEEN PREPARED FOR INFORMATION PURPOSES ONLY. NO DETAILED DESIGN SHOULD BE UNDERTAKEN UTILISING THIS DATA.
  - THIS PLAN DOES NOT SHOW ANY INFORMATION ABOUT INSTRUMENTS REGISTERED AGAINST THE EXISTING RECORDS OF TITLE OR ANY PROPOSED EASEMENTS, COVENANTS OR OTHER FUTURE INSTRUMENTS.
  - THIS PLAN IS ISSUED FOR A SPECIFIC PROJECT AND MAY NOT BE ALTERED OR USED FOR ANY OTHER PURPOSE WITHOUT THE PRIOR WRITTEN CONSENT OF ENVELOPE ENGINEERING.
  - EXISTING BOUNDARIES SHOWN ON THIS PLAN ARE FROM LAND INFORMATION DCDB (31/10/2022) AND HAVE NOT BEEN SURVEYED. A BOUNDARY DEFINITION SURVEY SHOULD BE CARRIED OUT TO ESTABLISH EXACT BOUNDARY POSITIONS ON SITE.
  - LEGAL DESCRIPTION:
    - SECTION 1 SO 581456 (TITLE YET TO ISSUE) 1,9100 Ha.
    - SECTION 2 SO 581456 (TITLE YET TO ISSUE) 1,063 Ha.
    - PART LOT 1 DP 4741 (COMPRISED IN RT WN468/927) 5084m<sup>2</sup>.
    - PART LOT 4 BLOCK XII DP 858 (COMPRISED IN RT WN468/923) 1,0901 Ha.
    - SECTION 1 SO 24508 & PART LOT 1 DP 4741 (COMPRISED IN RT WN468/926) 4527m<sup>2</sup>.
    - SECTIONS 1 & 3 SO 477035 (COMPRISED IN RT 760897) 4,4182 Ha.
    - SECTIONS 4, 6 & 7 SO 477035 (COMPRISED IN RT 760898) 5,2328 Ha.TOTAL AREA OF ALL TITLES: 14,6752 Ha.
  - THESE NOTES ARE AN INTEGRAL PART OF THIS PLAN.

This design and drawing shall only be used for the purpose for which it was supplied and shall not be altered or reproduced without the permission of Envelope Engineering Limited. No liability shall be accepted for unauthorised use of this design and drawing.

REVISIONS:			BY	DATE
REV	NOTES			
R1	NOT ISSUED		-	
R2	ISSUED FOR CLIENT INFORMATION		JEG	24.03.2023

PROJECT:  
THE WELLINGTON COMPANY ASSET  
MANAGEMENT LIMITED.  
MATAI MOANA (MOUNT CRAWFORD).

TITLE:  
CONCEPT PLAN OF PROPOSED SUBDIVISION  
PROPOSED LOTS AND DWELLING COUNT  
SHEET 4



DESIGNED: JEG	DRAWN: JEG
CHECKED: EFC	PLOT DATE: 24-03-2023
SCALE A1: 1:1000	SCALE A3: 1:2000
STATUS: CLIENT INFORMATION	
PROJECT No: <b>1501-01</b>	DRAWING No: <b>CP009</b>
	REVISION: <b>R2</b>



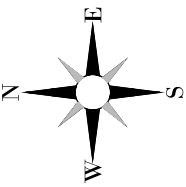
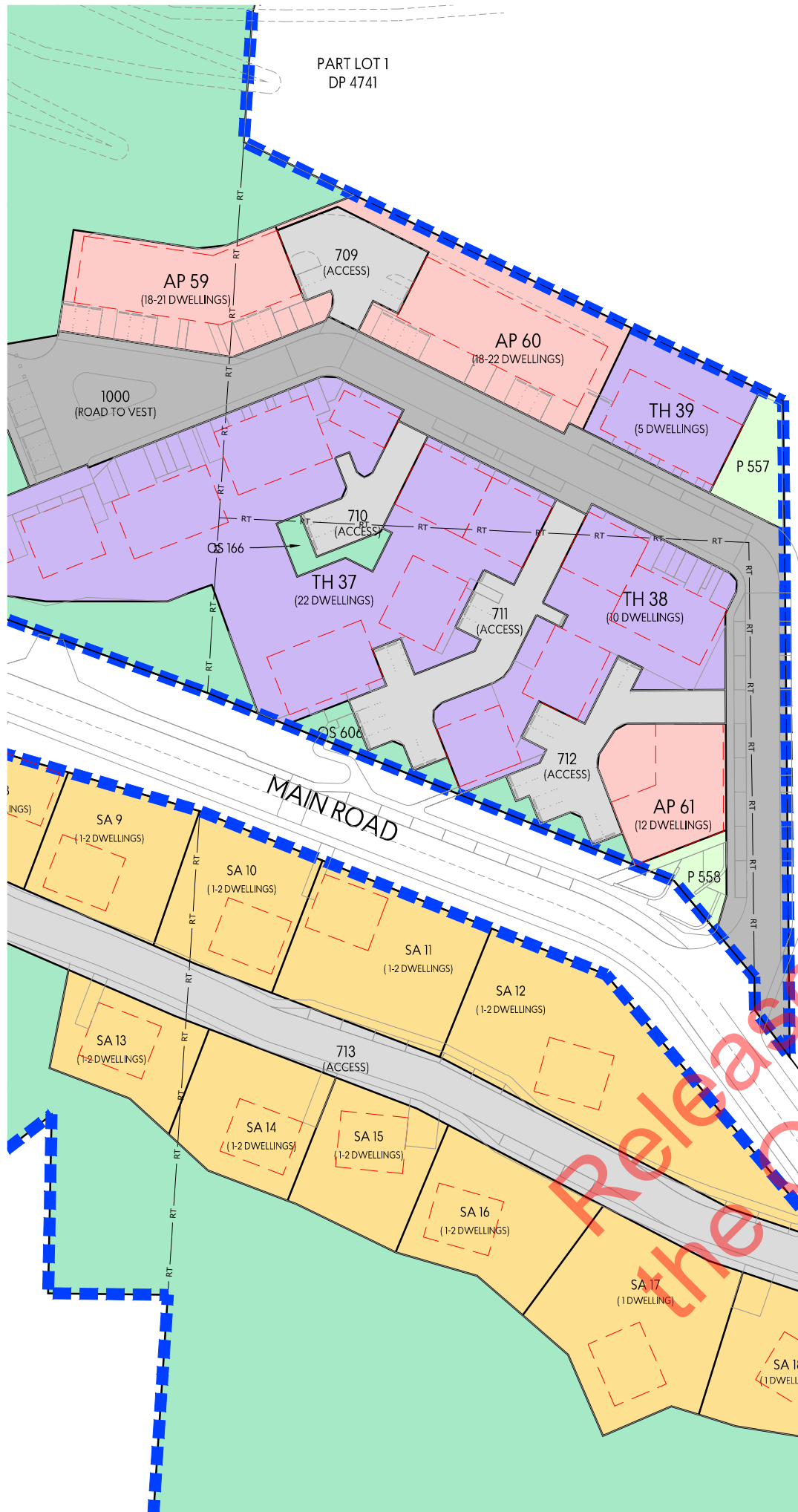

**LEGEND:**

- SITE EXTENTS
- - - PROPOSED LOT BOUNDARY
- RT --- EXISTING TITLE BOUNDARY
- EXISTING LOT BOUNDARY
- ROAD BOUNDARY
- - - PROPOSED BUILDING OUTLINE
- SA 1 LOT - STANDALONE / SEMIDETACHED DWELLING
- TH 35 LOT - TOWNHOUSES
- AP 50 LOT - APARTMENTS (UNIT TITLES)
- 700 LOT - ACCESS
- C 500 LOT - PUBLIC URBAN OPEN SPACE
- C 800 LOT - COMMERCIAL
- OS 600 LOT - OPEN SPACE / RESERVE / IWI / PUBLIC (TBC)
- P 550 LOT - PRIVATE COMMUNAL OUTDOOR SPACE
- 1000 LOT - ROAD TO VEST
- POSSIBLE ROAD ADJUSTMENT - TO VEST
- POSSIBLE ROAD ADJUSTMENT - TO BE CLOSED

- NOTES:**
- THIS PLAN HAS BEEN PREPARED FOR INFORMATION PURPOSES ONLY. NO DETAILED DESIGN SHOULD BE UNDERTAKEN UTILISING THIS DATA.
  - THIS PLAN DOES NOT SHOW ANY INFORMATION ABOUT INSTRUMENTS REGISTERED AGAINST THE EXISTING RECORDS OF TITLE OR ANY PROPOSED EASEMENTS, COVENANTS OR OTHER FUTURE INSTRUMENTS.
  - THIS PLAN IS ISSUED FOR A SPECIFIC PROJECT AND MAY NOT BE ALTERED OR USED FOR ANY OTHER PURPOSE WITHOUT THE PRIOR WRITTEN CONSENT OF ENVELOPE ENGINEERING.
  - EXISTING BOUNDARIES SHOWN ON THIS PLAN ARE FROM LAND INFORMATION DCDB (31/10/2022) AND HAVE NOT BEEN SURVEYED. A BOUNDARY DEFINITION SURVEY SHOULD BE CARRIED OUT TO ESTABLISH EXACT BOUNDARY POSITIONS ON SITE.
  - LEGAL DESCRIPTION:
    - SECTION 1 SO 581456 (TITLE YET TO ISSUE) 1,910.0 Ha.
    - SECTION 2 SO 581456 (TITLE YET TO ISSUE) 1,063 Ha.
    - PART LOT 1 DP 4741 (COMPRISED IN RT WN468/927) 5084m<sup>2</sup>.
    - PART LOT 4 BLOCK XII DP 858 (COMPRISED IN RT WN468/923) 1,090.1 Ha.
    - SECTION 1 SO 24508 & PART LOT 1 DP 4741 (COMPRISED IN RT WN468/926) 4527m<sup>2</sup>.
    - SECTIONS 1 & 3 SO 477035 (COMPRISED IN RT 760897) 4,482 Ha.
    - SECTIONS 4, 6 & 7 SO 477035 (COMPRISED IN RT 760898) 5,232.8 Ha.TOTAL AREA OF ALL TITLES: 14,675.2 Ha.
  - THESE NOTES ARE AN INTEGRAL PART OF THIS PLAN.

This design and drawing shall only be used for the purpose for which it was supplied and shall not be altered or reproduced without the permission of Envelope Engineering Limited. No liability shall be accepted for unauthorised use of this design and drawing.

REVISIONS:		BY	DATE
REV	NOTES		
R1	NOT ISSUED	-	-
R2	ISSUED FOR CLIENT INFORMATION	JEG	24.03.2023

PROJECT:  
THE WELLINGTON COMPANY ASSET  
MANAGEMENT LIMITED.  
MATAI MOANA (MOUNT CRAWFORD).

TITLE:  
CONCEPT PLAN OF PROPOSED SUBDIVISION  
PROPOSED LOTS AND DWELLING COUNT  
SHEET 5



DESIGNED: JEG	DRAWN: JEG	
CHECKED: EFC	PLOT DATE: 24-03-2023	
SCALE A1: 1:1000	SCALE A3: 1:2000	
STATUS: CLIENT INFORMATION		
PROJECT No: 1501-01	DRAWING No: CP010	REVISION: R2