**DISCLAIMER:**

This map/plan is illustrative only and all information should be independently verified on site before taking any action. Copyright Auckland Council. Land Parcel Boundary information from LINZ (Crown Copyright Reserved). Whilst due care has been taken, Auckland Council gives no warranty as to the accuracy and plan completeness of any information on this map/plan and accepts no liability for any error, omission or use of the information. Height datum: Auckland 1946.

Built Environment

0 180 360 540
Meters

Scale @ A4
= 1:25,000

Date Printed:
20/02/2023

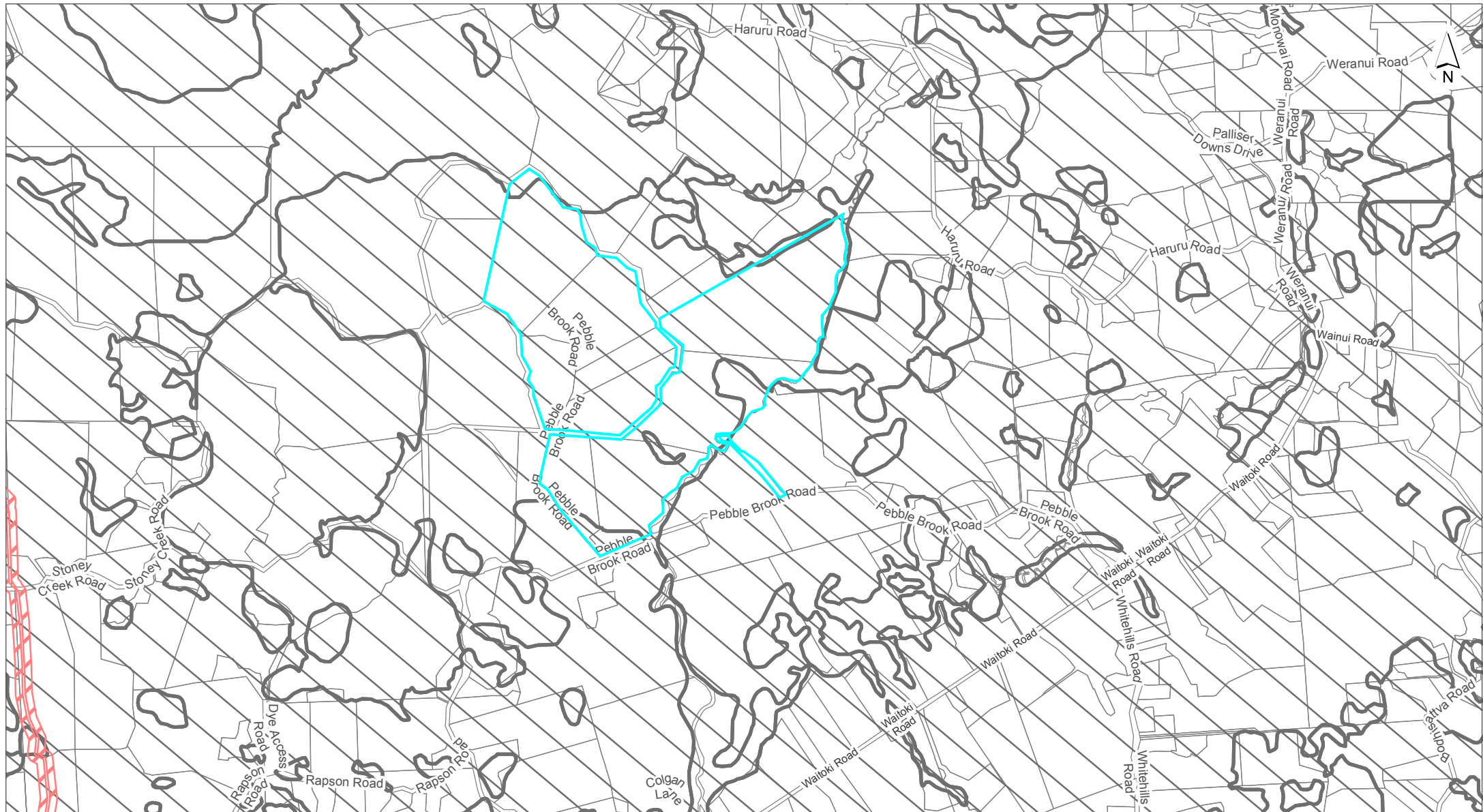
**DISCLAIMER:**

This map/plan is illustrative only and all information should be independently verified on site before taking any action. Copyright Auckland Council. Land Parcel Boundary information from LINZ (Crown Copyright Reserved). Whilst due care has been taken, Auckland Council gives no warranty as to the accuracy and plan completeness of any information on this map/plan and accepts no liability for any error, omission or use of the information. Height datum: Auckland 1946.

Controls

0 180 360 540
Meters

Scale @ A4
= 1:25,000

Date Printed:
20/02/2023

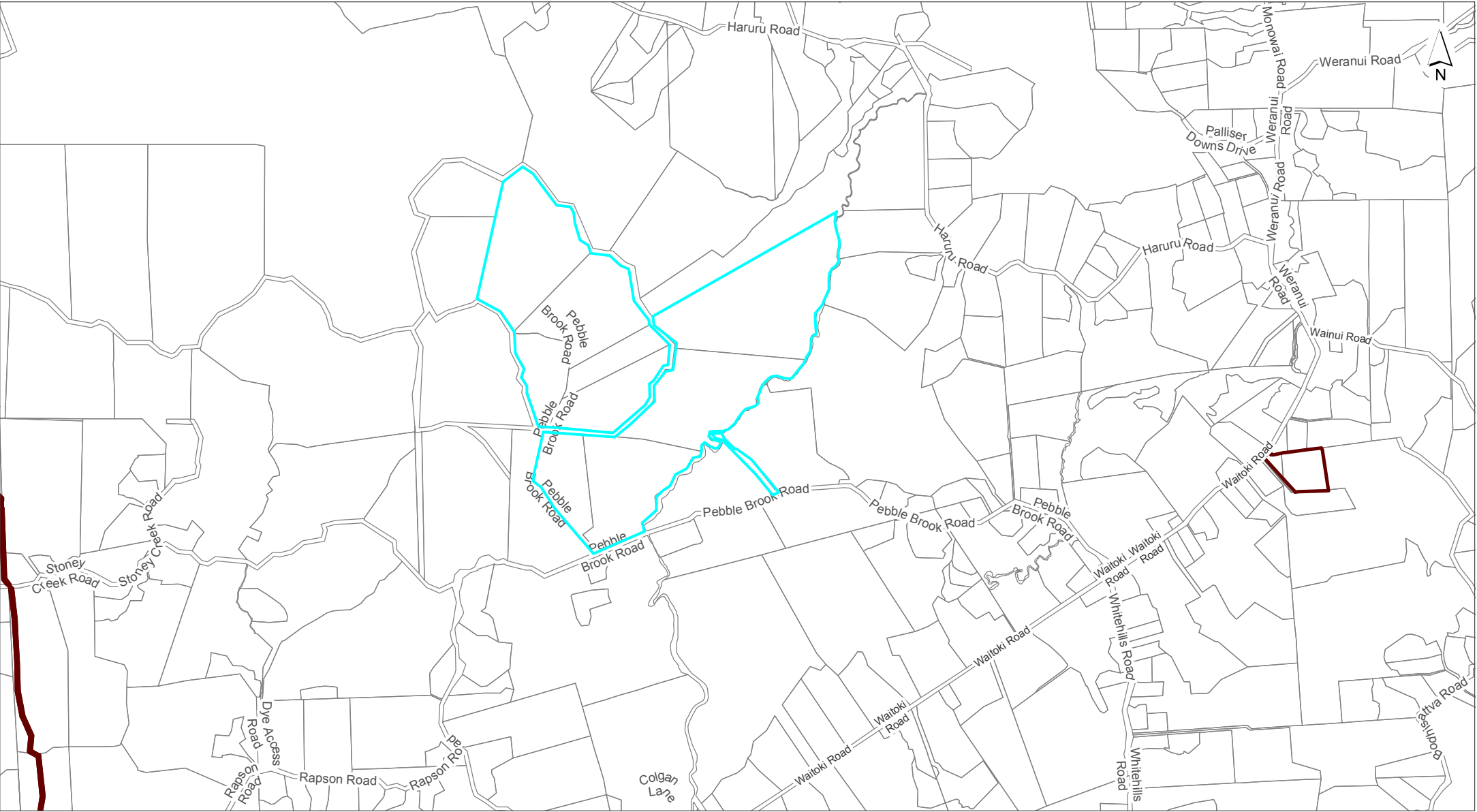

DISCLAIMER:
This map/plan is illustrative only and all information should be independently verified on site before taking any action.
Copyright Auckland Council. Land Parcel Boundary information from LINZ (Crown Copyright Reserved). Whilst due care has been taken, Auckland Council gives no warranty as to the accuracy and plan completeness of any information on this map/plan and accepts no liability for any error, omission or use of the information. Height datum: Auckland 1946.

Designations



Scale @ A4
= 1:25,000

Date Printed:
20/02/2023

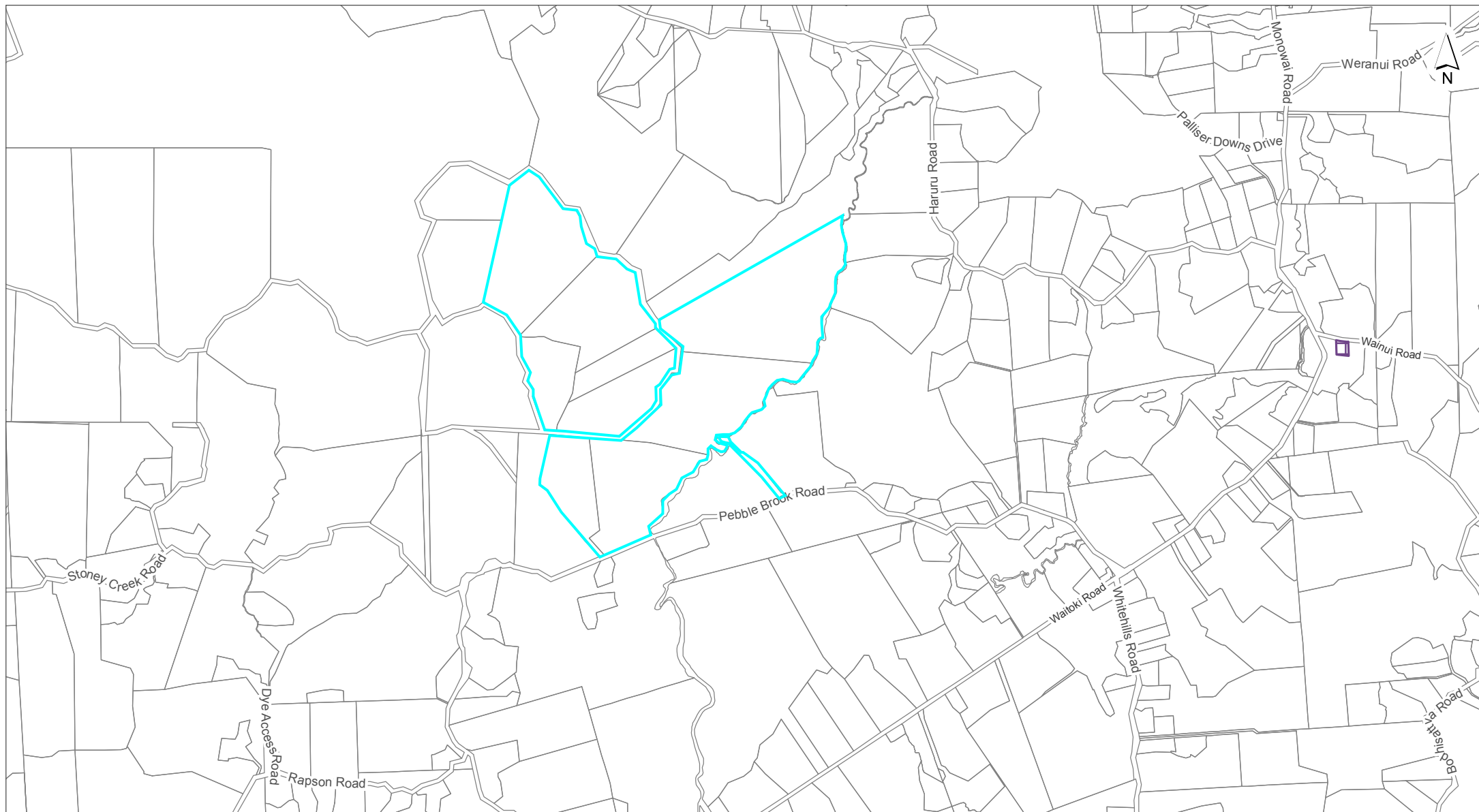

**DISCLAIMER:**

This map/plan is illustrative only and all information should be independently verified on site before taking any action. Copyright Auckland Council. Land Parcel Boundary information from LINZ (Crown Copyright Reserved). Whilst due care has been taken, Auckland Council gives no warranty as to the accuracy and plan completeness of any information on this map/plan and accepts no liability for any error, omission or use of the information. Height datum: Auckland 1946.

Historic Heritage and Special Character

0 180 360 540
Meters

Scale @ A4
= 1:25,000

Date Printed:
20/02/2023

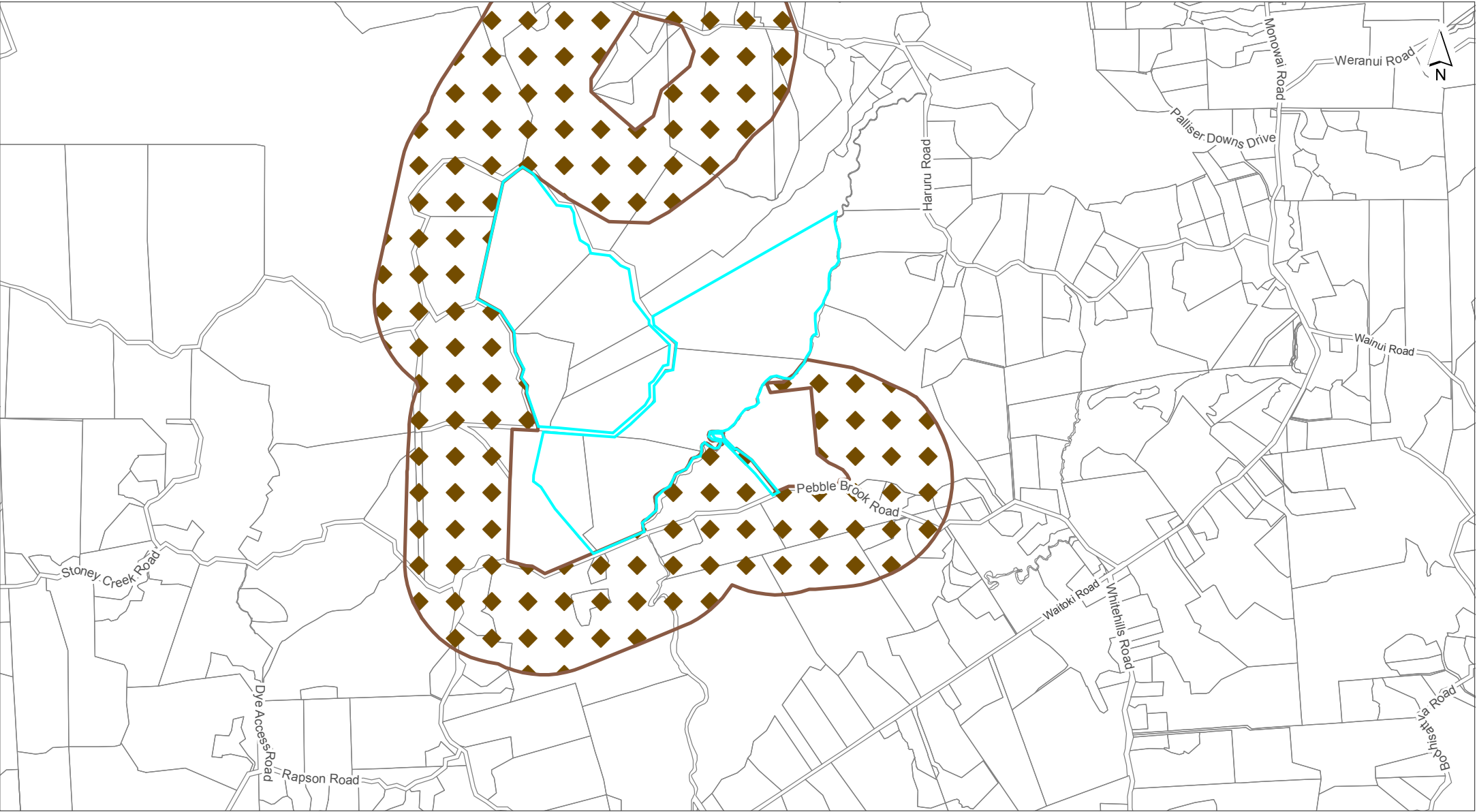

DISCLAIMER:
This map/plan is illustrative only and all information should be independently verified on site before taking any action.
Copyright Auckland Council. Land Parcel Boundary information from LINZ (Crown Copyright Reserved). Whilst due care has been taken, Auckland Council gives no warranty as to the accuracy and plan completeness of any information on this map/plan and accepts no liability for any error, omission or use of the information. Height datum: Auckland 1946.

Infrastructure



Scale @ A4
= 1:25,000

Date Printed:
20/02/2023



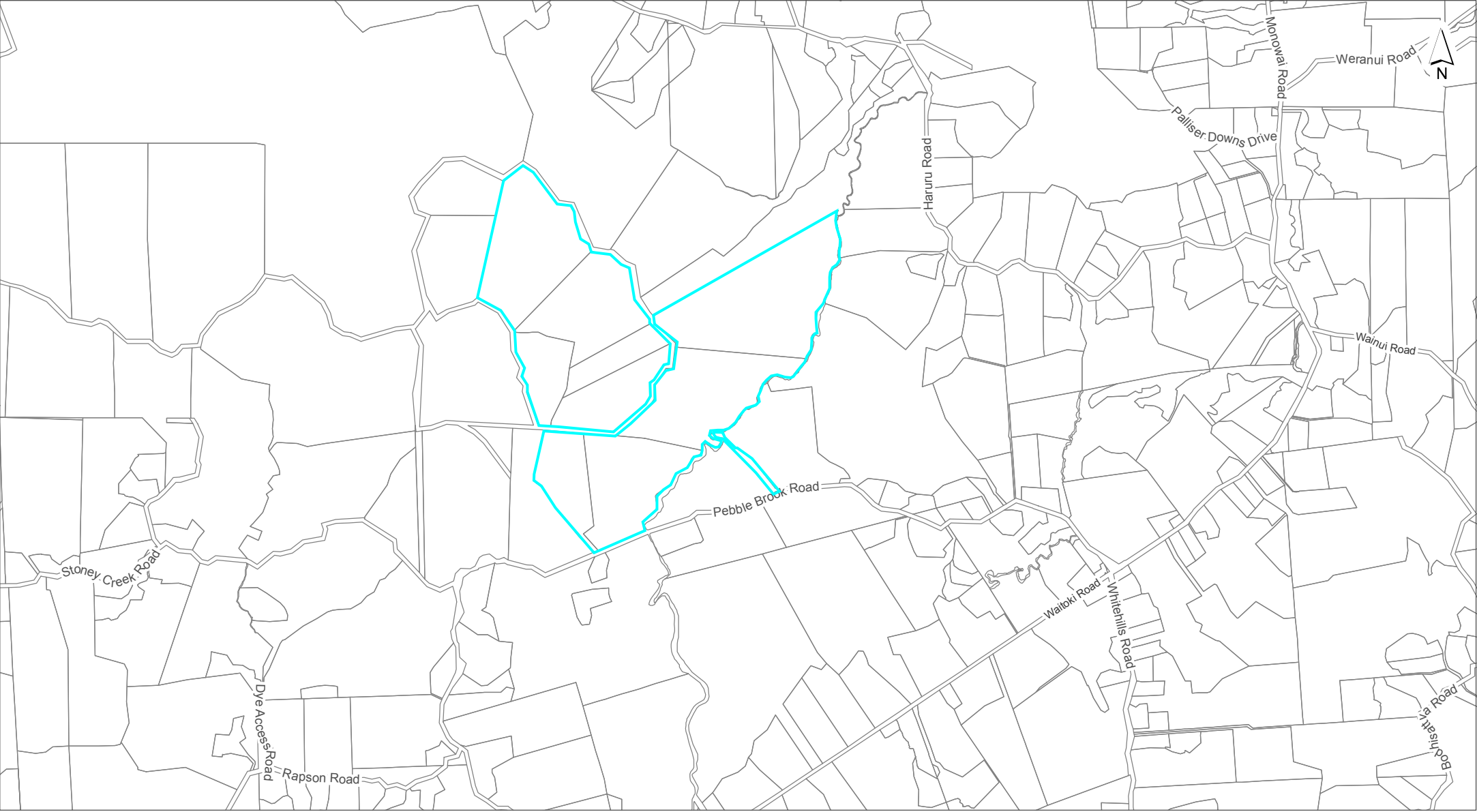

DISCLAIMER:
This map/plan is illustrative only and all information should be independently verified on site before taking any action.
Copyright Auckland Council. Land Parcel Boundary information from LINZ (Crown Copyright Reserved). Whilst due care has been taken, Auckland Council gives no warranty as to the accuracy and plan completeness of any information on this map/plan and accepts no liability for any error, omission or use of the information. Height datum: Auckland 1946.

Mana Whenua

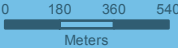

Scale @ A4
= 1:25,000

Date Printed:
20/02/2023



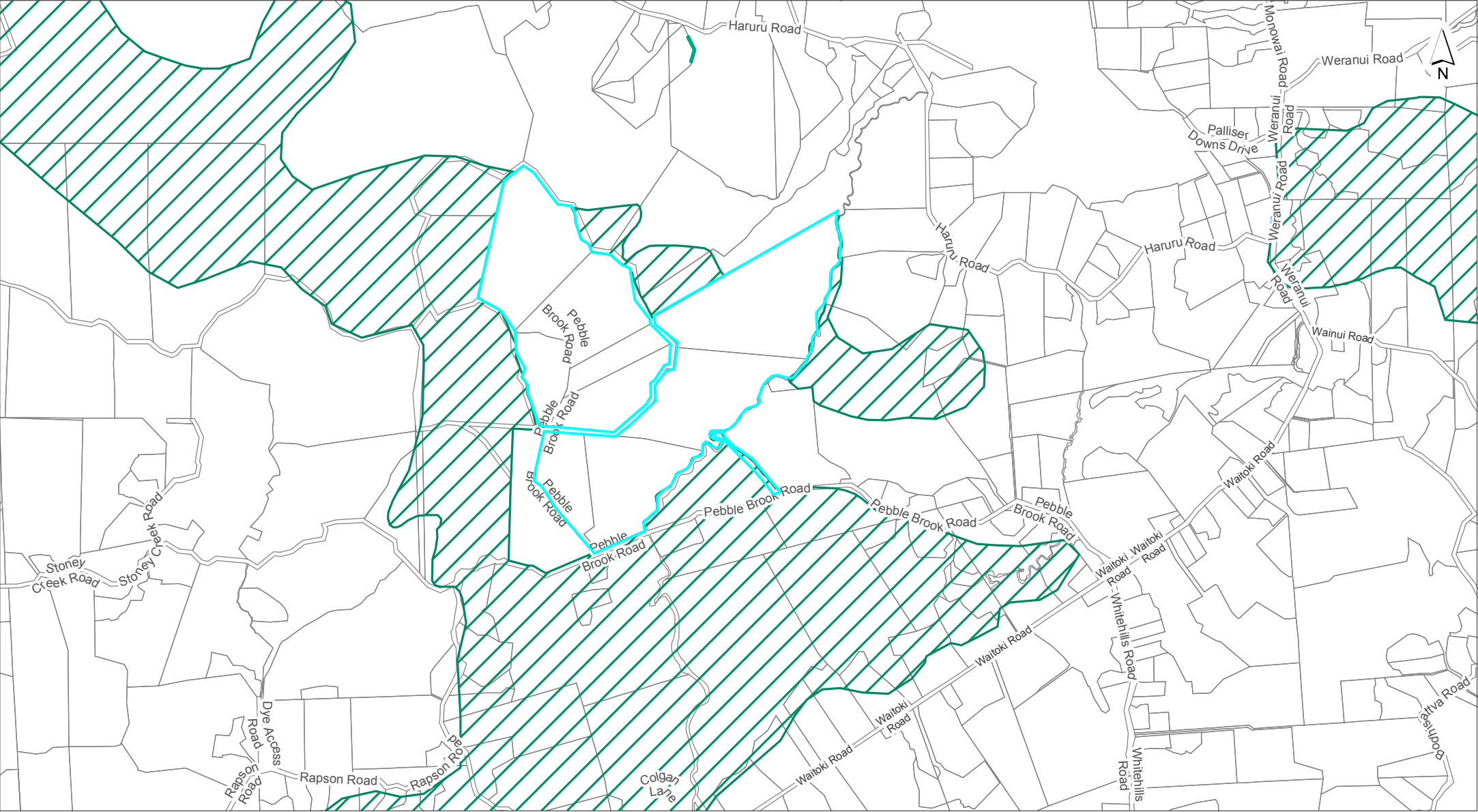

DISCLAIMER:
This map/plan is illustrative only and all information should be independently verified on site before taking any action.
Copyright Auckland Council. Land Parcel Boundary information from LINZ (Crown Copyright Reserved). Whilst due care has been taken, Auckland Council gives no warranty as to the accuracy and plan completeness of any information on this map/plan and accepts no liability for any error, omission or use of the information. Height datum: Auckland 1946.

Natural Heritage

0 180 360 540
Meters

Scale @ A4
= 1:25,000

Date Printed:
20/02/2023

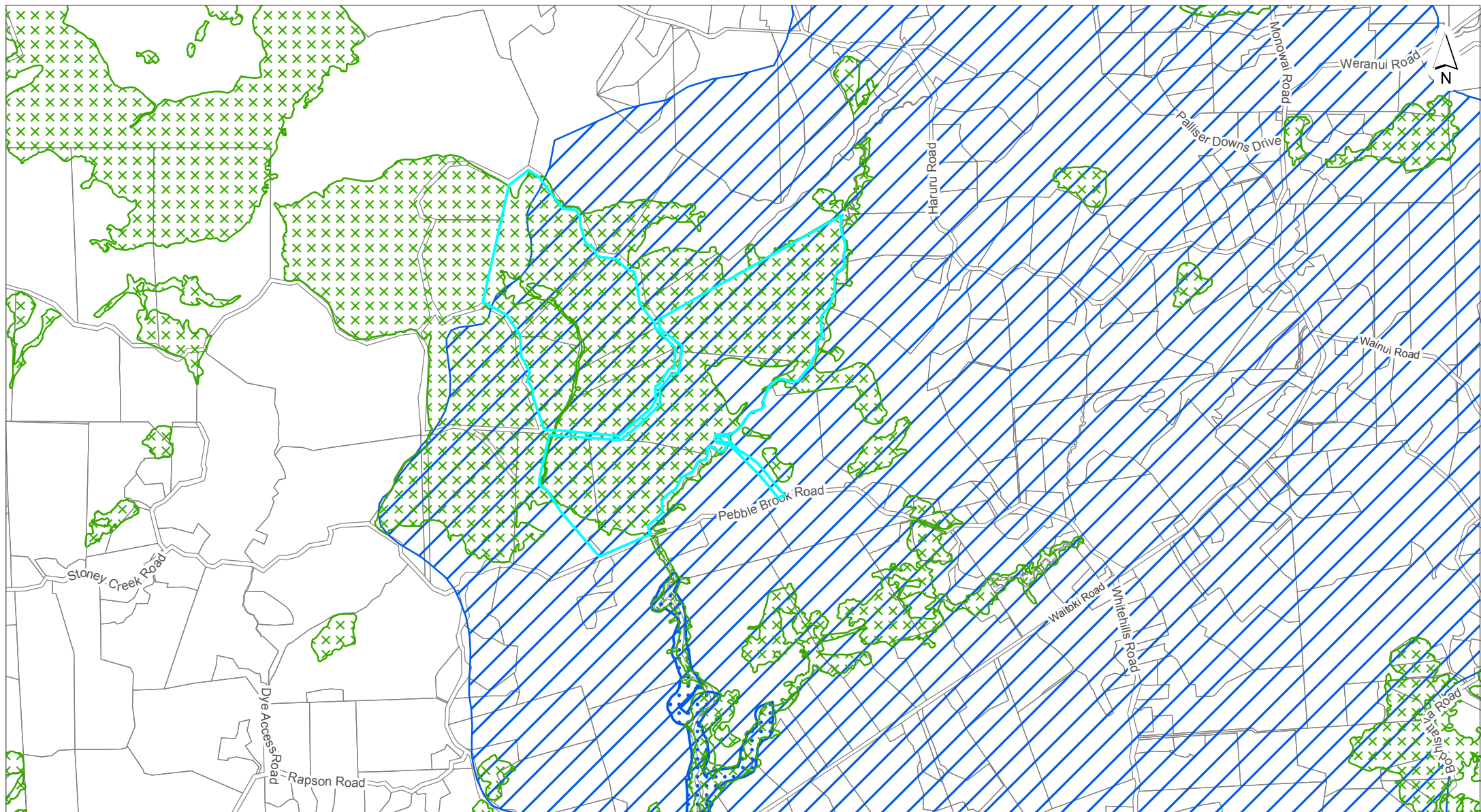

**DISCLAIMER:**

This map/plan is illustrative only and all information should be independently verified on site before taking any action. Copyright Auckland Council. Land Parcel Boundary information from LINZ (Crown Copyright Reserved). Whilst due care has been taken, Auckland Council gives no warranty as to the accuracy and plan completeness of any information on this map/plan and accepts no liability for any error, omission or use of the information. Height datum: Auckland 1946.

Natural Resources

0 180 360 540
Meters

Scale @ A4
= 1:25,000

Date Printed:
20/02/2023

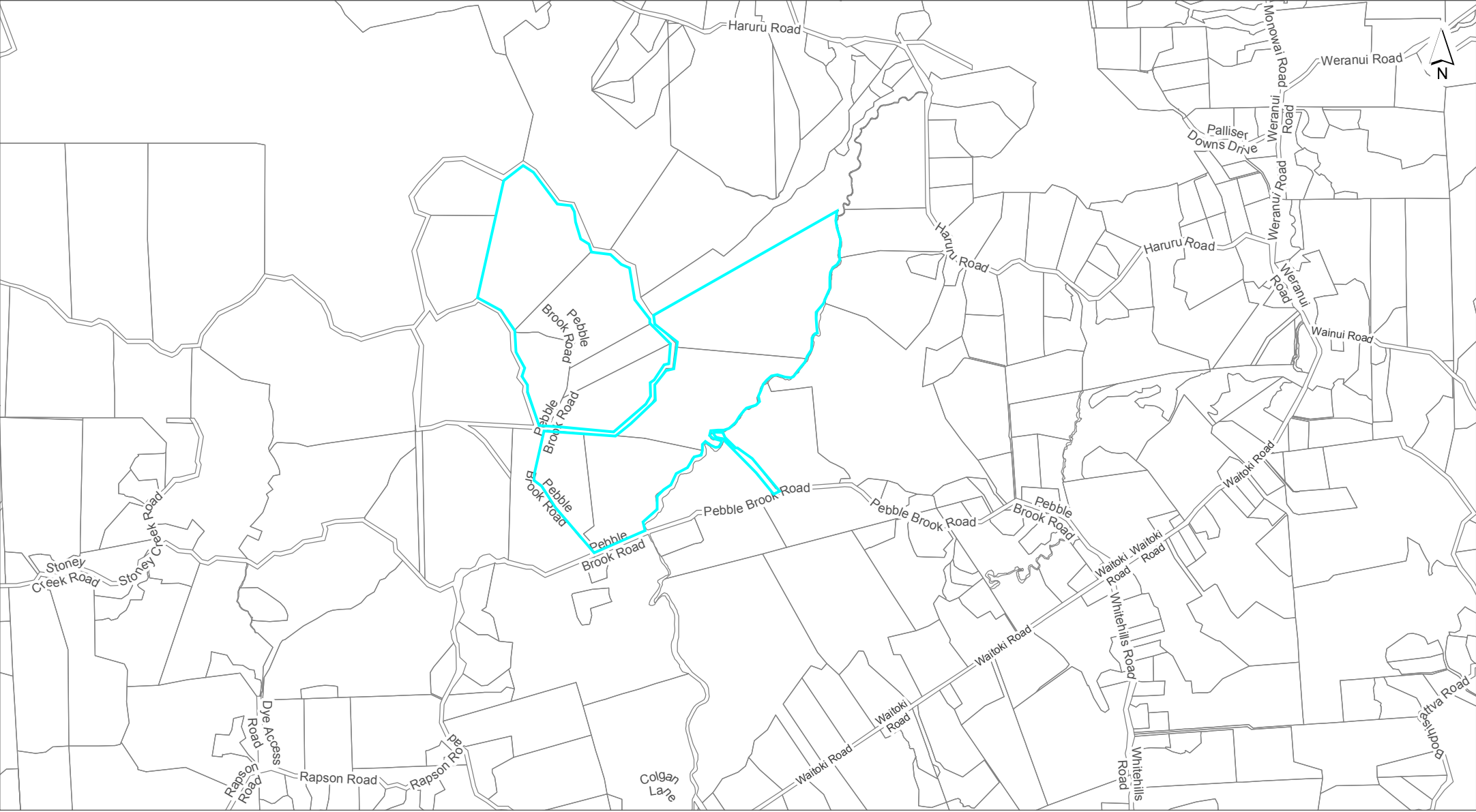

DISCLAIMER:
This map/plan is illustrative only and all information should be independently verified on site before taking any action.
Copyright Auckland Council. Land Parcel Boundary information from LINZ (Crown Copyright Reserved). Whilst due care has been taken, Auckland Council gives no warranty as to the accuracy and plan completeness of any information on this map/plan and accepts no liability for any error, omission or use of the information. Height datum: Auckland 1946.

Precincts

0 180 360 540
Meters
Scale @ A4
= 1:25,000
Date Printed:
20/02/2023

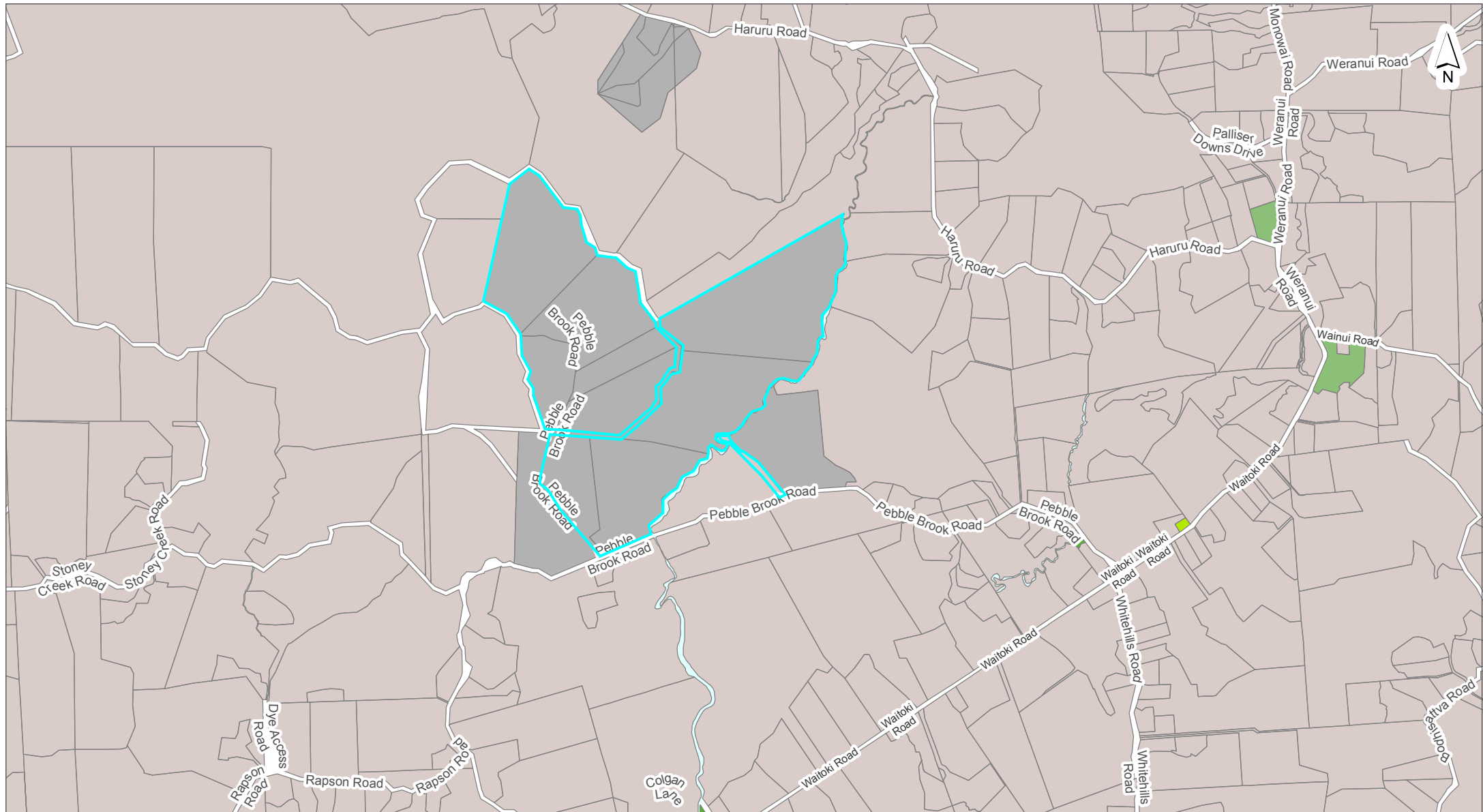

**DISCLAIMER:**

This map/plan is illustrative only and all information should be independently verified on site before taking any action. Copyright Auckland Council. Land Parcel Boundary information from LINZ (Crown Copyright Reserved). Whilst due care has been taken, Auckland Council gives no warranty as to the accuracy and plan completeness of any information on this map/plan and accepts no liability for any error, omission or use of the information. Height datum: Auckland 1946.

Zones and Rural Urban Boundary

0 180 360 540
Meters

Scale @ A4
= 1:25,000

Date Printed:
20/02/2023

NOTATIONS

Appeals to the Proposed Plan

 Appeals seeking changes to zones or management layers

Proposed Modifications

 Notice of Requirements

 Plan Changes

 Future Coastal Hazards Plan Change

Tagging of Provisions:

[i] = Information only

[rp] = Regional Plan

[rcp] = Regional Coastal Plan

[rps] = Regional Policy Statement

[dp] = District Plan (only noted when dual provisions apply)

ZONING

Residential

-  Residential - Large Lot Zone
-  Residential - Rural and Coastal Settlement Zone
-  Residential - Single House Zone
-  Residential - Mixed Housing Suburban Zone
-  Residential - Mixed Housing Urban Zone
-  Residential - Terrace Housing and Apartment Buildings Zone







Business

-  Business - City Centre Zone
-  Business - Metropolitan Centre Zone
-  Business - Town Centre Zone
-  Business - Local Centre Zone
-  Business - Neighbourhood Centre Zone
-  Business - Mixed Use Zone
-  Business - General Business Zone
-  Business - Business Park Zone
-  Business - Heavy Industry Zone
-  Business - Light Industry Zone

Open space

-  Open Space - Conservation Zone
-  Open Space - Informal Recreation Zone
-  Open Space - Sport and Active Recreation Zone
-  Open Space - Civic Spaces Zone
-  Open Space - Community Zone
-  Water [i]



Rural

-  Rural - Rural Production Zone
-  Rural - Mixed Rural Zone
-  Rural - Rural Coastal Zone
-  Rural - Rural Conservation Zone
-  Rural - Countryside Living Zone
-  Rural - Waitakere Foothills Zone
-  Rural - Waitakere Ranges Zone

Future Urban

-  Future Urban Zone
-  Green Infrastructure Corridor (Operative in some Special Housing Areas)

Infrastructure

-  Special Purpose Zone - Airports & Airfields
Cemetery
Quarry
Healthcare Facility & Hospital
Tertiary Education
Māori Purpose
Major Recreation Facility
School
-  Strategic Transport Corridor Zone

Coastal

-  Coastal - General Coastal Marine Zone [rcp]
-  Coastal - Marina Zone [rcp/dp]
-  Coastal - Mooring Zone [rcp]
-  Coastal - Minor Port Zone [rcp/dp]
-  Coastal - Ferry Terminal Zone [rcp/dp]
-  Coastal - Defence Zone [rcp]
-  Coastal - Coastal Transition Zone



Precincts

--- Rural Urban Boundary

--- Indicative Coastline [i]

Overlays

Natural Resources

	Terrestrial [rp/dp]	} Significant Ecological Areas Overlay
	Marine 1 [rcp]	
	Marine 2 [rcp]	
	Water Supply Management Areas Overlay [rp]	
	Natural Stream Management Areas Overlay [rp]	
	High-Use Stream Management Areas Overlay [rp]	
	Natural	
	Urban	
	High-Use Aquifer Management Areas Overlay [rp]	
	Quality-Sensitive Aquifer Management Areas Overlay [rp]	
	Wetland Management Areas Overlay [rp]	

Infrastructure

	Airport Approach Surface Overlay	
	Aircraft Noise Overlay	
	City Centre Port Noise Overlay [rcp / dp]	
	Quarry Buffer Area Overlay	
	National Grid Subdivision Corridor	} National Grid Corridor Overlay
	National Grid Substation Corridor	
	National Grid Yard Compromised	
	National Grid Yard Uncompromised	

Mana Whenua

	Sites & Places of Significance to Mana Whenua Overlay [rcp/dp]
--	--

Built Environment

	Identified Growth Corridor Overlay
--	------------------------------------

Natural Heritage

	Verified position of tree	} Notable Trees Overlay
	Unverified position of tree	
	Group of Trees	
	Outstanding Natural Features Overlay [rcp/dp]	
	Outstanding Natural Landscapes Overlay [rcp/dp]	
	Outstanding Natural Character Overlay [rcp/dp]	
	High Natural Character Overlay [rcp/dp]	
	Viewshafts	} Regionally Significant Volcanic Viewshafts & Height Sensitive Areas Overlay [rcp/dp]
	Height Sensitive Areas	
	Regionally Significant Volcanic Viewshafts Overlay Contours [i]	
	Locally Significant Volcanic Viewshafts Overlay [rcp/dp]	
	Locally Significant Volcanic Viewshafts Overlay Contours [i]	
	Modified	} Ridgeline Protection Overlay
	Natural	
	Local Public Views Overlay [rcp/dp]	
	Extent of Overlay	} Waitakere Ranges Heritage Area Overlay
	Subdivision Schedule	

Historic Heritage & Special Character

	Historic Heritage Overlay Place [rcp/dp]
	Historic Heritage Overlay Extent of Place [rcp/dp]
	Special Character Areas Overlay Residential and Business
	Auckland War Memorial Museum Viewshaft Overlay [rcp/dp]
	Auckland War Memorial Museum Viewshaft Overlay Contours [i]
	Stockade Hill Viewshaft Overlay – 8m height area
	Stockade Hill Viewshaft [i]

Controls

	Key Retail Frontage	} Building Frontage Control
	General Commercial Frontage	
	Adjacent to Level Crossings	
	General	} Vehicle Access Restriction Control
	Motorway Interchange Control	
	Centre Fringe Office Control	
	Height Variation Control	
	Parking Variation Control	
	Level Crossings With Sightlines Control	
	Arterial Roads	
	Business Park Zone Office Control	

	Hazardous Facilities	} Emergency Management Area Control
	Infrastructure	
	Macroinvertebrate Community Index	
	Flow 1 [rp]	} Stormwater Management Area Control
	Flow 2 [rp]	
	Subdivision Variation Control	
	Indigenous Vegetation 749.7 ha	} Kawau Island Rural Subdivision SEAs Control
	Freshwater Wetland 14.6 ha	
	Surf Breaks [rcp]	
	Cable Protection Areas Control [rcp]	
	Coastal Inundation 1 per cent AEP Plus 1m Control	

Designations

	Designations
--	--------------

	Airspace Restriction Designations
--	-----------------------------------

Auckland Unitary Plan Operative in part (15th November 2016) Property Summary Report

Address

306 Pebble Brook Road Wainui 0994

Legal Description

Lot 1 DP 59502

Appeals

Modifications

Zones

Special Purpose - Quarry Zone

Precinct

Controls

Controls: Macroinvertebrate Community Index - Native

Controls: Macroinvertebrate Community Index - Rural

Overlays

Natural Resources: High-Use Stream Management Areas Overlay [rp]

Natural Resources: Significant Ecological Areas Overlay - SEA_T_6454, , Terrestrial

Designations