

Ground Floor
1: 250 A1; 1: 500 @ A3

CLIENT: Willis Bond
 STRUCTURAL ENGINEER: Dunning Thornton Consultants
 SERVICES ENGINEER: Aurecon
 FIRE ENGINEER: Holmes Fire & Safety

KEY:

- Core
- Lobby
- Service Loading
- Egress
- Retail
- Tenancy
- End of Trip
- Service



No. 1
 Description: WORK IN PROGRESS
 Resource: General
 Date: 26.02.2022
 21.07.2022

105 AMRITSAR STREET
 WELLINGTON 6035
 PO BOX 3364
 WELLINGTON 6140
 NEW ZEALAND
 TEL 64 4 499 1727
 FAX 64 4 499 1960

a t h f i e l d
a r c h i t e c t s
l i m i t e d

110 Jervois Quay
 Ground Floor Plan
 1: 250 A1; 1: 500 @ A3

16-10
 RC_1.01-



Level 1 Plan
1: 250 A1; 1: 500 @ A3

CLIENT: Willis Bond
 STRUCTURAL ENGINEER: Dunning Thornton Consultants
 SERVICES ENGINEER: Aurecon
 FIRE ENGINEER: Holmes Fire & Safety

KEY:

- Core
- Egress
- Office



No. 1
 Description: WORK IN PROGRESS
 Resource: General
 Date: 26.02.2022
 21.07.2022

105 AMRITSAR STREET
 WELLINGTON 6035
 PO BOX 3364
 WELLINGTON 6140
 NEW ZEALAND
 TEL 64 4 499 1727
 FAX 64 4 499 1960

a t h f i e l d
a r c h i t e c t s
l i m i t e d

110 Jervois Quay
 Level 1 Plan
 1: 250 A1; 1: 500 @ A3

16-10
 RC_1.02-



Level 2 Plan
1: 250 A1; 1: 500 @ A3

CLIENT: Willis Bond
 STRUCTURAL ENGINEER: Dunning Thornton Consultants
 SERVICES ENGINEER: Aurecon
 FIRE ENGINEER: Holmes Fire & Safety

KEY:

- Core
- Egress
- Office



No.	Description	Date
1	Resource Consent	26.02.2022

105 AMRITSAR STREET
 WELLINGTON 6035
 PO BOX 3364
 WELLINGTON 6140
 NEW ZEALAND
 TEL 64 4 499 1727
 FAX 64 4 499 1960

a t h f i e l d
a r c h i t e c t s
l i m i t e d

110 Jervois Quay
 Level 2 Plan
 1: 250 A1; 1: 500 @ A3

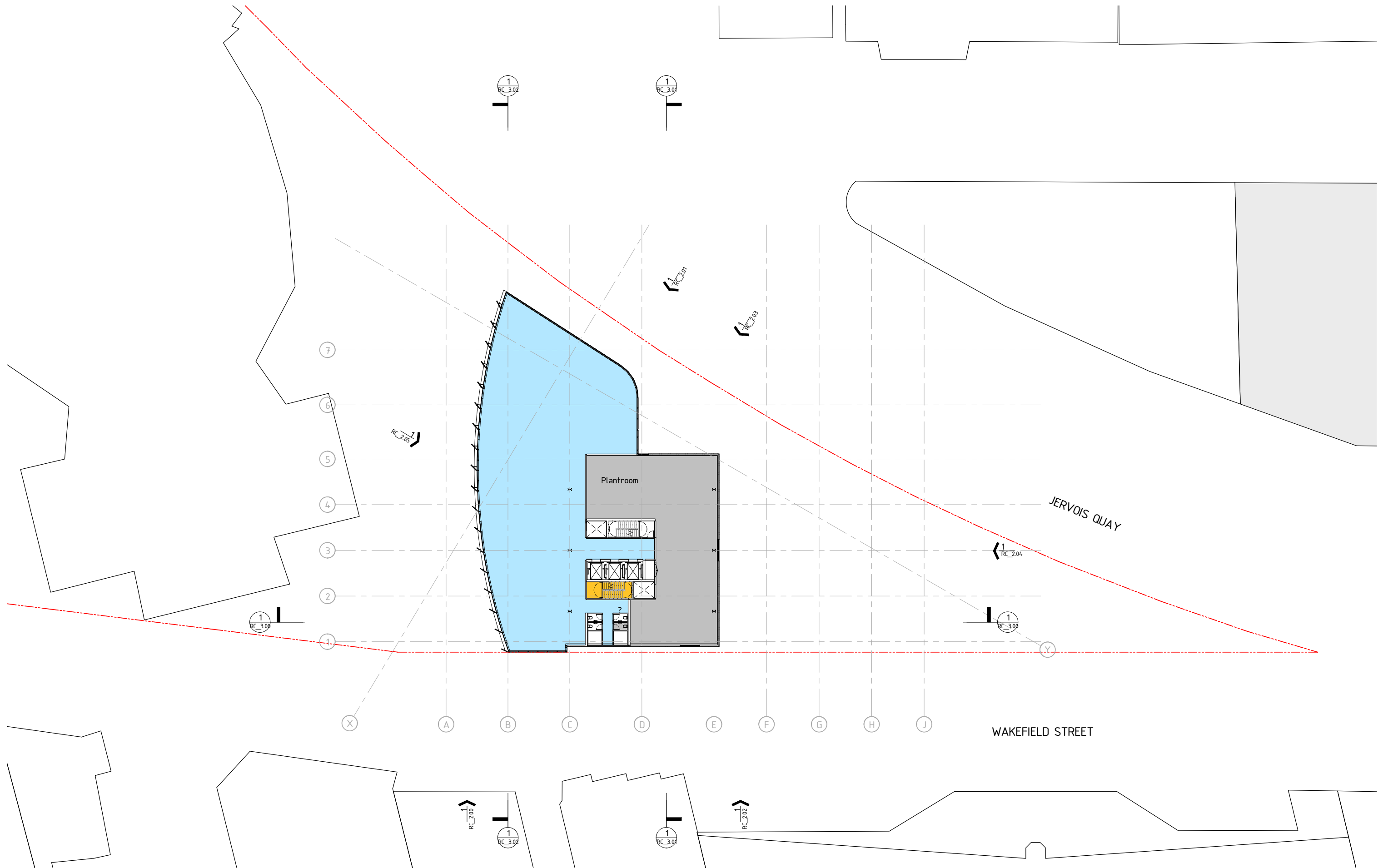

Level 8 Plan
 1: 250 A1; 1: 500 @ A3

CLIENT: Willis Bond
 STRUCTURAL ENGINEER: Dunning Thornton Consultants
 SERVICES ENGINEER: Aurecon
 FIRE ENGINEER: Holmes Fire & Safety

KEY:

- Egress
- Office
- Service



No. 1
 Description: WORK IN PROGRESS
 Resource: General
 Date: 26.02.2022
 21.07.2022

105 AMRITSAR STREET
 WELLINGTON 6035
 PO BOX 3364
 WELLINGTON 6140
 NEW ZEALAND
 TEL 64 4 499 1727
 FAX 64 4 499 1960

a t h f i e l d
a r c h i t e c t s
l i m i t e d

110 Jervois Quay
 Level 8 Plan
 1: 250 A1; 1: 500 @ A3

16-10
 RC_1.09-



RC - South Elevation
 1: 250 A1; 1: 500 @ A3

CLIENT: Willis Bond
 STRUCTURAL ENGINEER: Dunning Thornton Consultants
 SERVICES ENGINEER: Aurecon
 FIRE ENGINEER: Holmes Fire & Safety

KEY:

No.	Description	Date
1	Resource: Complete	26.02.2022

WORK IN PROGRESS
 21.07.2022

105 AMRITSAR STREET
 WELLINGTON 6035
 PO BOX 3364
 WELLINGTON 6140
 NEW ZEALAND
 TEL 64 4 499 1727
 FAX 64 4 499 1960

a t h f i e l d
a r c h i t e c t s
l i m i t e d

110 Jervois Quay
 South Elevation
 1: 250 A1; 1: 500 @ A3

16-10

RC_2.02-