



Digital Title Plan - DP 388374

Survey Number DP 388374
Surveyor Reference 87641LT.nzt
Surveyor Gary Jackson Blyth
Survey Firm Fraser Thomas Ltd (Auckland)
Surveyor Declaration I Gary Jackson Blyth, being a person entitled to practise as a licensed cadastral surveyor, certify that -
(a) The surveys to which this dataset relates are accurate, and were undertaken by me or under my direction in accordance with the Cadastral Survey Act 2002 and the Surveyor-General's Rules for Cadastral Survey 2002/2;
(b) This dataset is accurate, and has been created in accordance with that Act and those Rules.
Declared on 17/09/2007.

Survey Details

Dataset Description SURVEY OF LOTS 1 - 3 BEING A SUBDIVISION OF PART ALLOTMENT 17 PARISH OF MARAETAI
Status Deposited
Land District North Auckland
Submitted Date 17/09/2007
Survey Class Class I Cadastral Survey
Survey Approval Date 27/09/2007
Deposit Date 05/02/2008

Territorial Authorities

Manukau City

Comprised In

CT NA1004/267

Created Parcels

Parcels	Parcel Intent	Area	CT Reference
Lot 1 Deposited Plan 388374	Fee Simple Title	12.6459 ha	353601
Lot 2 Deposited Plan 388374	Fee Simple Title	16.7436 ha	353602
Lot 3 Deposited Plan 388374	Vesting on Deposit for Road	1.0147 ha	
Total Area		30.4042 ha	

DP 388374

Adjoining Owners Details

Appellation	C.T	Physical Address	Registered Owners	Address for Service
Lot 1006 DP 19656	NA1693/20	107 Beachlands Rd	Peter Samual Batten Ann Lynette Batten Danielle Ann St. Clare Steven Norman Danielle Ann St Clare Norman	-
Lot 1062 DP 20517	NA8D/681	1 Karaka Rd	David Walter Snowden Linda Shirley Perkins	-
Lot 1115 DP 20517	NA2072/47	2 Karaka Rd	Henry Royston Ethelstone Glynis Betty Ethelstone	-
Pt Lot 1126 DP 20517	NA2049/42	-	Beachlands Estate Limited Directors: Dean William Hurlstone Clive Philip Jury	76 Airfield Rd Takanini Auckland
Lot 2 DP 325925	104913	830 Whitford-Maraetai Rd	Greenacres Properties Limited Directors: David Gordon Lee Helen Susanne Lee	c/- Ross Melville Pkf Level 5 50 Anzac Avenue Auckland

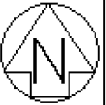

T 1/3

Land District: North Auckland

SURVEY OF LOTS 1 - 3 BEING A SUBDIVISION OF PART ALLOTMENT 17
PARISH OF MARAETAI

Surveyor: Gary Jackson Blyth
Firm: Fraser Thomas Ltd (Auckland)

Digital Title Plan
DP 388374

Digitally Generated Plan
Generated on: 11/02/2008 1:08pm Page 3 of 5

Deposited on: 5/02/2008



Diag. B

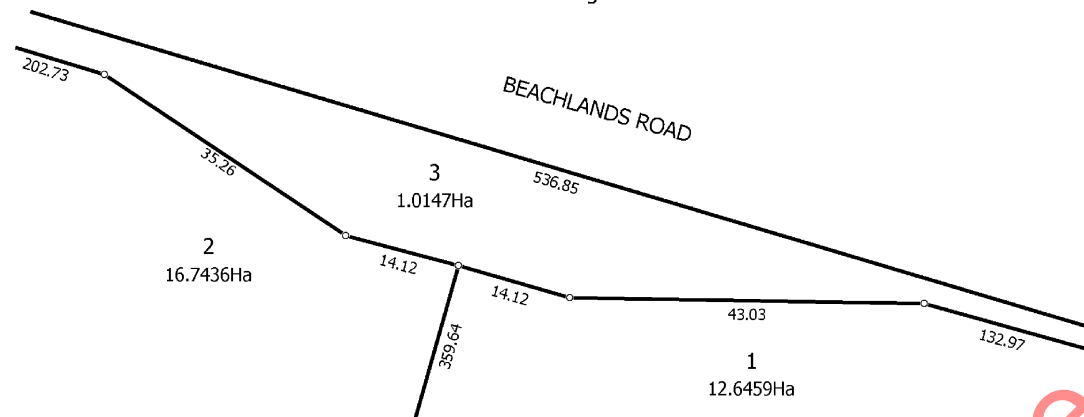

Diag. A



Diag. C

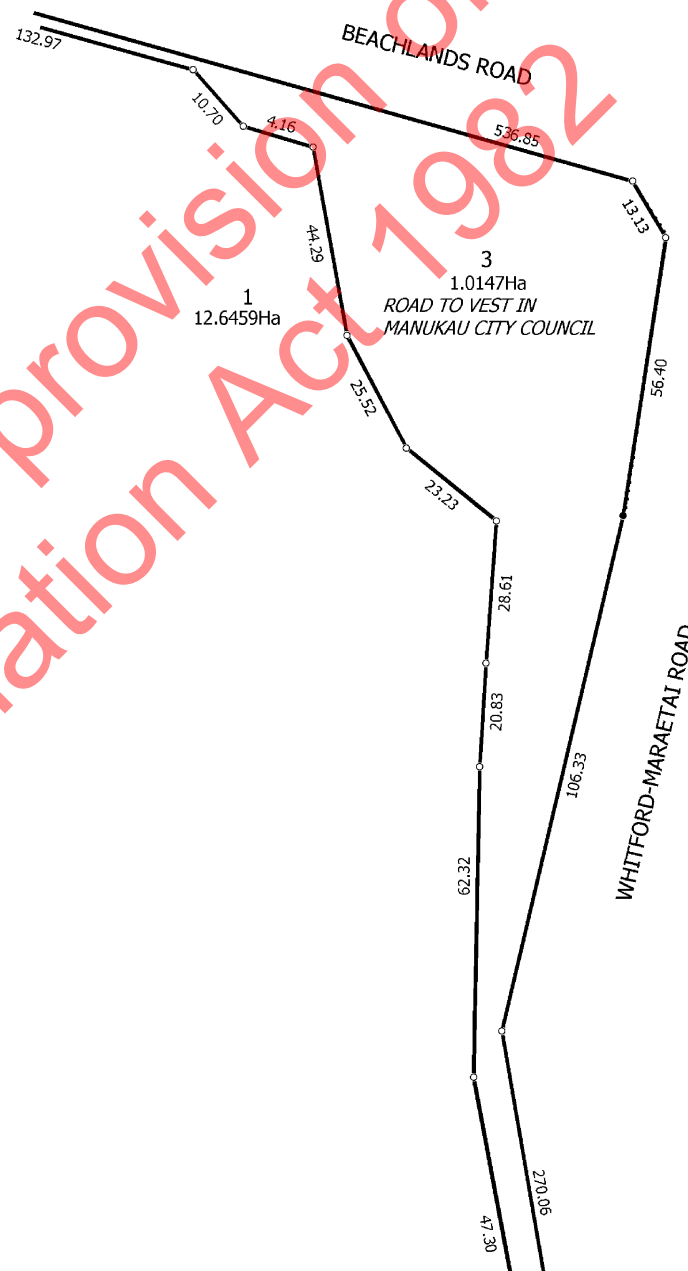

Land District: North Auckland

SURVEY OF LOTS 1 - 3 BEING A SUBDIVISION OF PART ALLOTMENT 17
PARISH OF MARAETAI

Surveyor: Gary Jackson Blyth
Firm: Fraser Thomas Ltd (Auckland)

Digital Title Plan
DP 388374

Deposited on: 5/02/2008

Digitally Generated Plan
Generated on: 11/02/2008 1:08pm Page 4 of 5

T 2/3

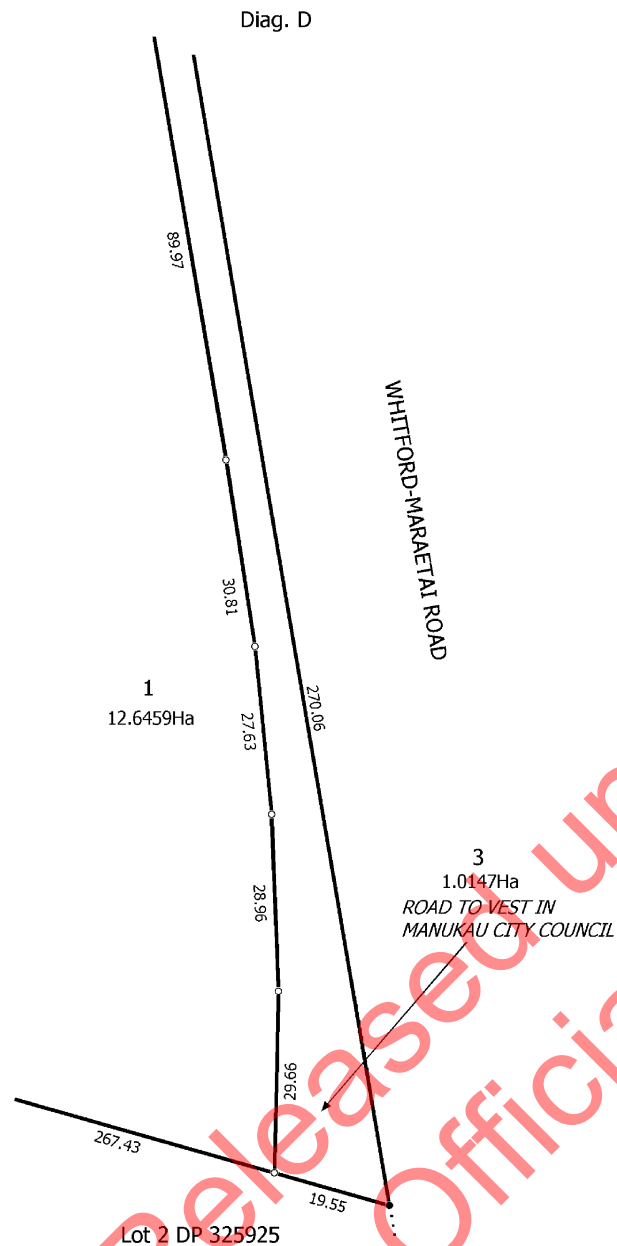
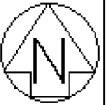

T 3/3

Land District: North Auckland

SURVEY OF LOTS 1 - 3 BEING A SUBDIVISION OF PART ALLOTMENT 17
PARISH OF MARAETAI

Surveyor: Gary Jackson Blyth
Firm: Fraser Thomas Ltd (Auckland)

Digital Title Plan
DP 388374

Digitally Generated Plan
Generated on: 11/02/2008 1:08pm Page 5 of 5

Deposited on: 5/02/2008