

**ATTACHMENT 2A - DOC LAND  
Land Notices**

**Forests (West Coast Accord) Act 2000  
Conservation Act 1987**

**Declaring Land to be Held for  
Conservation Purposes**

Under section 8 (1) (a) of the Forests (West Coast Accord) Act 2000, the Minister of Finance and the Minister for State-Owned Enterprises jointly declare that the land described in the Schedule is held under the Conservation Act 1987 for conservation purposes.

This notice shall take effect on 1 July 2001.

**Schedule**

***Nelson Land District—Buller District***

889.3421 hectares, being Sections 1, 2, 3, 4, 5, and 6, S.O. 15149.

***Westland Land District—Grey District***

64.2520 hectares, being Sections 1 and 2, S.O. 12134.

1084.4500 hectares, being Section 1, S.O. 12143.

185.2320 hectares, being Sections 1, 2, 3 and 4, S.O. 12159.

132.0200 hectares, being Section 1, S.O. 12242.

***Westland Land District—Westland District***

15.5500 hectares, being Section 1, S.O. 12027.

60.9650 hectares, being Section 1, S.O. 12032.

177.2400 hectares, being Section 1, S.O. 12094.

349.5190 hectares, being Section 1, S.O. 12102.

192.7700 hectares, being Section 1, S.O. 12117.

832.4000 hectares, being Sections 1, 2, 3 and 4, S.O. 12167.

251.5912 hectares, being Sections 1, 2 and 3, S.O. 12135.

809.0000 hectares, being Sections 1 and 2, S.O. 12041.

82.9600 hectares, being Section 1, S.O. 12165.

127.2300 hectares, being Sections 1 and 2, S.O. 12241.

Dated at Wellington this 26th day of June 2001.

DR MICHAEL CULLEN, Minister of Finance.

MARK BURTON, Minister for State-Owned Enterprises.

(File: DOC HK LMT 0045)

ln4456

**Declaring Land to be Held for Conservation  
Purposes as Conservation Park to be Part of  
Victoria Conservation Park**

Under section 8 (1) (a) of the Forests (West Coast Accord) Act 2000, the Minister of Finance and the Minister for State-Owned Enterprises jointly declare that the land described in the Schedule is held under the Conservation Act 1987 for conservation purposes as a conservation park subject to that Act and to be part of Victoria Conservation Park.

This notice shall take effect on 1 July 2001.

**Schedule**

***Nelson Land District—Buller District***

427.5160 hectares, being Section 1, S.O. 15051.

1471.8030 hectares, being Sections 1, 2 and 3, S.O. 14992.

217.4100 hectares, being Section 1, S.O. 14981.

***Nelson Land District—Tasman District***

1374.8570 hectares, being Sections 1, 2 and 3, S.O. 15148.

1301.9100 hectares, being Sections 1, 2, 3, and 4, S.O. 15133.

1371.0000 hectares, being Section 1, S.O. 15015.

Dated at Wellington this 26th day of June 2001.

DR MICHAEL CULLEN, Minister of Finance.

MARK BURTON, Minister for State-Owned Enterprises.

(File: DOC HK LMT 0045)

ln4457

**Declaring Land to be Held for Conservation  
Purposes as an Ecological Area**

Under section 8 (1) (a) of the Forests (West Coast Accord) Act 2000, the Minister of Finance and the Minister for State-Owned Enterprises jointly declare that the land described in the Schedule is held under the Conservation Act 1987 for conservation purposes and as an ecological area subject to that Act to be known as the Bell Hill-Granite Hill Ecological Area, to protect a bird-rich sequence of podocarp forest on valley floors, hard beech forest on slopes and hardwood forest on ridges on Old Man Gravels.

This notice shall take effect on 1 July 2001.

**Schedule**

***Westland Land District—Grey District***

***Bell Hill-Granite Hill Ecological Area***

6916.8600 hectares, being Sections 1 and 2, S.O. 12109.

Dated at Wellington this 26th day of June 2001.

DR MICHAEL CULLEN, Minister of Finance.

MARK BURTON, Minister for State-Owned Enterprises.

***Explanatory Note:***

Ecological areas are held for conservation purposes to protect indigenous intrinsic natural values and resources, ecological and evolutionary systems and in particular to protect values of scientific interest.

(File: DOC HK LMT 0045)

ln4459

**Declaring Land to be Held for Conservation  
Purposes, to be Part of Victoria Conservation Park  
and to be an Ecological Area**

Under section 8 (1) (a) of the Forests (West Coast Accord) Act 2000, the Minister of Finance and the Minister for State-Owned Enterprises jointly declare that the land described in the Schedule is held under the Conservation Act 1987 for conservation purposes as a conservation park subject to that Act, as part of Victoria Conservation Park and as an ecological area to be known as Station Creek Ecological Area, to protect extensive tall beech forest and important wildlife habitat at low altitude in the Rotoroa Ecological District.

This notice shall take effect on 1 July 2001.

**Schedule**

***Nelson Land District—Tasman and Buller Districts***

9081.7337 hectares, being Sections 1 and 2, S.O. 15019 and Sections 1, 2, 3, 4 and 5, S.O. 15048.

Dated at Wellington this 26th day of June 2001.

DR MICHAEL CULLEN, Minister of Finance.

MARK BURTON, Minister for State-Owned Enterprises.

***Explanatory Note:***

Ecological areas are held for conservation purposes to protect indigenous intrinsic natural values and resources, ecological and evolutionary systems and in particular to protect values of scientific interest.

(File: DOC HK LMT 0045)

ln4460

**Declaring Land to be Held for Conservation Purposes as Ecological Areas and to be Part of Existing Ecological Areas**

Under section 8 (1) (a) of the Forests (West Coast Accord) Act 2000, the Minister of Finance and the Minister for State-Owned Enterprises jointly declare that the land described in the Schedule is held under the Conservation Act 1987 for conservation purposes and as ecological areas subject to that Act and to be part of the ecological areas named in the Schedule, to be managed to protect the scientific values specified in this notice.

This notice shall take effect on 1 July 2001.

**Schedule**

**Nelson Land District—Buller District**

*Addition to Orikaka Ecological Area to protect areas of low-altitude forests poorly represented in the Buller and Reefton Ecological Districts and important roaroa/great spotted kiwi and other forest bird habitat.*

6467.0000 hectares, being Section 1, S.O. 15014.

**Westland Land District—Westland District**

*Addition to Kakapohahi Ecological Area to protect wetlands, pakihi, regenerating forest and significant wildlife habitat in the Hari Hari Ecological District.*

429.9900 hectares, being Sections 1 and 2, S.O. 12090.

*Addition to Doctor Hill Ecological Area is to protect vegetation and landforms representative of the Hōkitika Ecological District, including mixed podocarp forest, altitudinal vegetation sequences and important wildlife habitat.*

933.2650 hectares, being Section 1, S.O. 12133 and Sections 2, 3 and 4, S.O. 12165.

Dated at Wellington this 26th day of June 2001.

DR MICHAEL CULLEN, Minister of Finance.

MARK BURTON, Minister for State-Owned Enterprises.

**Explanatory Note:**

Ecological areas are held for conservation purposes to protect indigenous intrinsic natural values and resources, ecological and evolutionary systems and in particular to protect values of scientific interest.

(File: DOC HK LMT 0045)

104461

**Declaring Land to be Held for Conservation Purposes, to be Part of Victoria Conservation Park and to be Part of an Existing Ecological Area**

Under section 8 (1) (a) of the Forests (West Coast Accord) Act 2000, the Minister of Finance and the Minister for State-Owned Enterprises jointly declare that the land described in the Schedule is held under the Conservation Act 1987 for conservation purposes and to be a conservation park subject to that Act, to be part of Victoria Conservation Park and to be an ecological area and to be part of the Big River Ecological Area to protect beech forest on Old Man Gravels within the area and to protect important lowland forest within the North Westland Wildlife Corridor.

This notice shall take effect on 1 July 2001.

**Schedule**

**Nelson Land District—Buller District**

1104.4900 hectares, being Sections 1 and 2, S.O. 15022.

Dated at Wellington this 26th day of June 2001.

DR MICHAEL CULLEN, Minister of Finance.

MARK BURTON, Minister for State-Owned Enterprises.

**Explanatory Note:**

Ecological areas are held for conservation purposes to protect indigenous intrinsic natural values and resources,

ecological and evolutionary systems and in particular to protect values of scientific interest.

(File: DOC HK LMT 0045)

104462

**Declaring Land to be Held for Conservation Purposes, to be Part of Victoria Conservation Park, to be Wildlife Management Areas and to be Part of the Existing Wildlife Management Areas**

Under section 8 (1) (a) of the Forests (West Coast Accord) Act 2000, the Minister of Finance and the Minister for State-Owned Enterprises jointly declare that the land described in the Schedule is held under the Conservation Act 1987 for conservation purposes as conservation park, to be part of Victoria Conservation Park and to be part of the wildlife management areas named in the Schedule.

This notice shall take effect on 1 July 2001.

**Schedule**

**Nelson Land District—Buller District**

*Addition to Merrijigs Wildlife Management Area*

61.5450 hectares, being Section 1, S.O. 15023.

*Addition to Coal Creek Wildlife Management Area*

3560.0000 hectares, being part of Section 2, S.O. 15016 (shown as "B" on S.O. 301643).

Dated at Wellington this 26th day of June 2001.

DR MICHAEL CULLEN, Minister of Finance.

MARK BURTON, Minister for State-Owned Enterprises.

(File: DOC HK LMT 0045)

104454

**Declaring Land to be Held for Conservation Purposes as Wildlife Management Area and to be Part of the Adjoining Wildlife Management Area**

Under section 8 (1) (a) of the Forests (West Coast Accord) Act 2000, the Minister of Finance and the Minister for State-Owned Enterprises jointly declare that the land described in the Schedule is held under the Conservation Act 1987 for conservation purposes and as a wildlife management area subject to that Act and to be part of the Granville Wildlife Management Area.

This notice shall take effect on 1 July 2001.

**Schedule**

**Westland Land District—Grey District**

1406.7300 hectares, being Section 1, S.O. 12034.

Dated at Wellington this 26th day of June 2001.

DR MICHAEL CULLEN, Minister of Finance.

MARK BURTON, Minister for State-Owned Enterprises.

(File: DOC HK LMT 0045)

104455

**Forests (West Coast Accord) Act 2000 Reserves Act 1977**

**Declaring Land to be Held as Scenic Reserve and Become Part of an Existing Scenic Reserve**

Under section 8 (1) (b) of the Forests (West Coast Accord) Act 2000, the Minister of Finance and the Minister for State-Owned Enterprises jointly declare that the land described in the Schedule is held under the Reserves Act 1977, classified as a scenic reserve for the purposes of section 19 (1) (a) of that Act and further, the land shall be part of the Upper Buller Gorge Scenic Reserve.

This notice shall take effect on 1 July 2001.

**ATTACHMENT 2B - CROWN LAND**



**RECORD OF TITLE  
UNDER LAND TRANSFER ACT 2017  
GAZETTE NOTICE**

Search Copy



  
R. W. Muir  
Registrar-General  
of Land

**Identifier** 318036  
**Land Registration District** Westland  
**Date Registered** 27 October 2006 09:00 am

**Prior References**  
7088557.1

---

<b>Type</b>	Fee Simple	<b>Instrument</b>	GN 7088557.1
<b>Area</b>	15580.3972 hectares more or less		
<b>Legal Description</b>	Reserve 1672		
<b>Purpose</b>	Provisional State Forest		
<b>Registered Owners</b>	Her Majesty the Queen		

---

**Interests**

GN 7088557.1 Gazette

Cpy - 01/01, Pgs - 006, 30/10/06, 14:23

Title Diagram Gazette

Cpy - 01/01, Pgs - 005, 30/10/06, 14:40



DocID: 211894142

Humb. 56.

1283

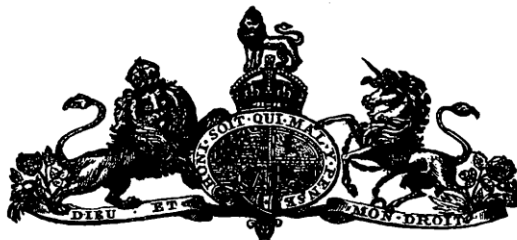

THE  
NEW ZEALAND GAZETTE.

Published by Authority.

WELLINGTON, THURSDAY, MAY 8, 1919.

*Lands set apart as Provisional State Forests.*

[L.S.] LIVERPOOL, Governor-General.  
A PROCLAMATION.

BY virtue and in exercise of the powers and authorities conferred upon me by section thirty-four of the War Legislation and Statute Law Amendment Act, 1918, I, Arthur William de Brito Savile, Earl of Liverpool, the Governor-General of the Dominion of New Zealand, acting by and with the advice and consent of the Executive Council of the said Dominion, do hereby set apart the Crown lands described in the Schedule hereto as and for provisional State forests.

SCHEDULE.

WESTLAND LAND DISTRICT.

ALL that area of Crown land in Blocks XIII, XIV, and XV, Mawheraiti Survey District, and Blocks II, III, IV, VII, and VIII, Ahaura Survey District, in the Westland Land District, being Reserve 1694, containing by admeasurement 14,300 acres, more or less. Commencing at the south-eastern corner of Section 31, and proceeding along the eastern boundary of that section to the southern boundary of Section 81; thence along that boundary across a road, and along the southern and south-eastern boundaries of Section 2698, across a road, along the south-western boundary of Section 2699, across a road, and along the south-western, southern, and eastern boundaries of Section 2700 to a road; thence along the south-eastern side of the said road to the southern boundary of Section 158; thence along that boundary and the western, southern, and eastern boundaries of Section 3366 to the south-western boundary of Section 2905, and along that boundary to the south-western boundary of Section 2179, and by that boundary to the left bank of the Waipuna Creek; thence across the said creek and along its right bank to a road and along the south-western side of the said road to the north-western boundary of Section 2821; thence along the said boundary and the western and south-western boundaries of the said section, the latter produced to the most northerly corner of Section 189; thence along the north-westerly boundaries of that section and Section 170 to the southern boundary of Block XV, Mawheraiti Survey District; thence along that boundary to the south-western corner of the said block, and along the eastern boundary of Block II, Ahaura Survey District, 10000 links; thence due east to the western boundary of Section 10, Block IV, of the said survey district, and along that boundary and the

south-western boundary of Section 9, across a road, and generally along the south-western boundaries of Sections 5, 7, 6, and the south-western and southern boundaries of Section 5 to its south-eastern corner; thence due south to the southern boundary of Block IV, Ahaura Survey District, and along that block boundary, 5200 links; thence due south, 19000 links; thence in a north-westerly direction to the south-western corner of Block III of the said survey district, and along the western boundary of that block to the northern side of the Orwell Creek Road; thence along the said roadside to a point 10000 links west of the said western boundary of Block III, Ahaura Survey District; thence due north to the southern boundary of Block XIV, Mawheraiti Survey District, and along that block boundary and the southern boundary of Block XIII and the northern boundary of Section 3043 of the said survey district to the point of commencement. As the same is delineated on sheet 47, roll plan 450, deposited in the Head Office, Department of Lands and Survey, at Wellington.

Excepting therefrom the Township of Granville.

All that area of Crown land in Blocks X, XIII, XIV, and XV, Waiho Survey District, and Block I, Mount Cook Survey District, in the Westland Land District, being Reserve No. 1697, containing 13,500 acres, more or less. Commencing at a point on the south-eastern boundary of Section 2570, 600 links from the south-western corner of the said section, and proceeding due south 7600 links; thence in a south-westerly direction to the north-eastern corner of Reserve 928; thence along the eastern boundary of the said reserve and the eastern and southern boundaries of Section 2419, the latter produced to the left bank of the Omeoas River; thence along the said river-bank to a point in line with the northern boundary of the said Reserve 928; thence due east 1600 links; thence due south 8000 links; thence to the south-eastern corner of Reserve 338, and across the Main South Road to its southern side; thence along the said roadside to the north-eastern corner of Section 842, and along the eastern and southern boundaries of that section to the north-western corner of Block I, Mount Cook Survey District; thence along the western boundary of the said block to the right bank of the Waiho River, and along the said river-bank and the northern side of the Fox Glacier to the western boundary of Block II of the said survey district; thence along the said western and the northern boundaries of that block to the western boundary of Reserve 1461; thence along the said reserve boundary to Docherty's Creek, and along the left bank of the said creek to a point in line with the south-eastern boundary of Section 2570; thence

A

to and along the said boundary to point of commencement. As the same is delineated on sheet 37, roll plan 450, deposited in the Head Office, Department of Lands and Survey, at Wellington.

All that area of Crown land in Blocks VIII and XII, Mawheranui Survey District, and Blocks V, VI, IX, X, XI, XIII, XIV, and XV, Ahaura Survey District, in the Westland Land District, being Reserve 1695, containing by admeasurement 17,460 acres, more or less. Commencing at the north-eastern corner of Section 2565, and proceeding along the northern and western boundaries of that section, the latter produced, and the right bank of Nelson Creek; thence along the said creek-bank to a point in line with the eastern boundary of Section 23, Block VIII, Mawheranui Survey District; thence to and along the said eastern and the northern boundary of the said section produced to the said right bank of Nelson Creek; thence again along the said creek-bank to its confluence with Gow's Creek, and along the left bank of Gow's Creek to the western boundary of Block V, Ahaura Survey District; thence along the said block-boundary, 14800 links; thence in an east-south-easterly direction passing through the intersection of Blocks VI, VII, X, and XI, Ahaura Survey District, 68000 links; thence south-south-easterly to the northern boundary of Block XV of the said survey district, and along the said northern boundary to the north-eastern corner of the said block, and thence along the eastern boundary of the said Block XV, 6500 links; thence due west to the right bank of Nelson Creek; thence due north to the northern boundary of Block XIII of the said survey district, and along that boundary and the northern boundary of Block XIV of the said Ahaura Survey District to the south-western corner of Block XI; thence along the western boundary of that block, 5600 links; thence in an easterly direction to the right bank of the left-hand branch of Nelson Creek; thence along the said creek-bank to a point opposite the eastern boundary of Section 2565, and to and along the said section boundary to the point of commencement. As the same is delineated on sheet 47, roll plan 450, deposited in the Head Office, Department of Lands and Survey, at Wellington.

All that area of Crown land in Block XII, Gillespie's Survey District, in the Westland Land District, being Reserve 1696, containing by admeasurement 6,238 acres, more or less. Commencing at the south-eastern corner of the said Block XII, and proceeding along its southern, western, and northern boundaries, and along the eastern boundary of the said Block XII to the western shore of Lake Gibbs; thence along the said shore to the eastern boundary of the said block, and along that block boundary to the point of commencement. As the same is delineated on sheet 37, roll plan 450, deposited in the Head Office, Department of Lands and Survey, at Wellington.

All that area of Crown land in Blocks III, IV, V, VI, VII, VIII, IX, X, XI, and XV, Waiwhero Survey District, and Block I, Mawheranui Survey District, in the Westland Land District, being Reserve 1693, containing by admeasurement 53,650 acres, more or less. Commencing at the south-eastern corner of Section 2998, and proceeding along the eastern boundary of the said section produced to the left bank of Fagin's Creek; thence along the said creek-bank to a point in line with the eastern boundary of Section 3362, and thence by the eastern boundary of said section and that line produced across Granite Creek; thence along the right bank of Granite Creek, 2000 links; thence due north to the eastern boundary of Section 3175, and along that boundary and the southern and eastern boundaries of Section 3317, across a road reserve, Canoe Creek, and a road reserve, and along the eastern boundaries of Sections 3313 and 3312 to the northern boundary of Block V, Waiwhero Survey District; thence along the northern boundaries of that block and Block VI of the said survey district to the south-western corner of Block III, Waiwhero Survey District; thence along the western and northern boundaries of that block to the left bank of the Porarua River, and by said river to the north-western corner of Block IV, Waiwhero Survey District, and along the northern boundary of that block; thence along the northern boundary of Block I, Mawheranui Survey District, 6000 links; thence in a south-easterly direction to the southern boundary of the said Block I, and along the said southern boundary to the south-western corner of the said Block I, 14300 links; thence along the eastern boundary of Block VIII, Waiwhero Survey District, to the northern boundary of Section 2991, and along that boundary produced to the right bank of Big River, and along the left bank of that river to the southern boundary of the said block; thence along that boundary to the north-eastern corner of Block XI, Waiwhero Survey District; thence along the eastern boundary of that block, and along the eastern boundary of Block XV of the said survey district, 8500 links; thence due west to the western boundary of the said Block XV, and along that boundary to the south-eastern corner of Block

X; thence along the southern boundary of the said Block X, and along the southern boundary of Block IX, Waiwhero Survey District; thence due north by a line, 17600 links, to the southern boundary of Section 2998, and thence along the said southern boundary to the point of commencement. As the same is delineated on sheet 47, roll plan 450, deposited in the Head Office, Department of Lands and Survey, at Wellington.

All that area of Crown land comprising the whole of the Survey Districts of Awarua, Macfarlane, Barn Bay, Cascade, and Smoothwater, together with the whole of Block XVI, Hapuka Survey District, Blocks I, II, III, V, VI, VII, IX, X, XI, XIII, XIV, and XV, Arawata Survey District, and Blocks I, II, III, V, VI, VII, IX, X, XI, XIII, XIV, and XV, Jackson Survey District, and Blocks II, III, IV, V, VI, VII, VIII, XI, XII, XV, and XVI, and part of Blocks X and XIV, Gorge River Survey District, in the Westland Land District, being Reserve 1692, containing 413,600 acres, more or less. As the same is delineated on sheet 66, roll plan 450, deposited in the Head Office, Department of Lands and Survey, at Wellington.

Excepting therefrom Arawata Township, Town of Waitoto, Lake Ellery, Lake Mary, Lake Bux, Lake Clarke, Lake Leep, Lake Day, and part of Lake Nisson; and Sections 3, 4, 5, 29, 30, 290, 326, 527, 528, 530, 531, 532, 533, 534, 535, 539, 562, 2115, 2117, 2118, and 2119; Native Reserve 752, Native reserve (20 acres), and Native reserve (33 acres and 38 perches), Block I, Arawata Survey District; Native Reserve 755, Block III, Arawata Survey District; Sections 35, 37, 38, 39, 40, 41, 43, 44, 45, 47, 48, 51, 541, 548, 569, 590, and E.E.R. 169, Block VI, Arawata Survey District; Section 2236, Block X, Arawata Survey District; and Section 2530, Block XI, Cascade Survey District.

All that area of Crown land in Block IV, Arawata Survey District, in the Westland Land District, being Reserve 1691, containing by admeasurement 3,200 acres, more or less. Commencing at the north-eastern corner of Block IV, Arawata Survey District, and proceeding along the northern boundary of the said block to the Waitoto Lagoon; thence along the said lagoon and the Waitoto River to a point in line with the north-eastern boundary of a ferry reserve; thence to and along the said boundary and the south-eastern boundary of said reserve to the Waitoto River, and thence along the right bank of the said river to a point in line with the south-eastern boundary of Section 404; thence to and along the said boundary to the north-eastern corner of said section; thence due east by a right line to the eastern boundary of said Block IV; thence due north to the point of commencement. As the same is delineated on sheet 31, roll plan 450, deposited in the Head Office, Department of Lands and Survey, at Wellington.

All that area of Crown land in Blocks IX and XIII, Okuru Survey District, in the Westland Land District, being Reserve 1690, containing by admeasurement 1,550 acres, more or less. Commencing at the most southerly corner of Section 849, and proceeding along the south-western boundary of the said section produced to the sea-coast; thence along the sea-coast to the western boundary of Block XIII; thence due south along the said boundary, 4600 links; thence due east to the left branch of the Hapuka River; thence along the left bank of the said branch and the main Hapuka River to a point in line with the south-eastern boundary of Section 849; thence to and along the said boundary to the point of commencement. As the same is delineated on sheet 31, roll plan 450, deposited in the Head Office, Department of Lands and Survey, at Wellington.

All that area of Crown land in Blocks XII and XVI, Okuru Survey District, Blocks XIII, XIV, XV, and XVI, Mataketake Survey District, Block XIII, Clarke Survey District, Blocks I, II, III, and IV, Governor's Pass Survey District, and Block I, Haast Pass Survey District, in the Westland Land District, being Reserve 1688, containing by admeasurement 50,000 acres, more or less. Commencing at the most southerly corner of Reserve 175, and proceeding along the south-eastern boundary of the said reserve produced to the Haast River; thence along the left bank of the said river to a point in line with the north-western boundary of Reserve 174; thence to and along the said boundary and the south-western and south-eastern boundaries of the said reserve, the latter produced to the Haast River; thence again along the left bank of the said river to the eastern boundary of Block XIII, Clarke Survey District; thence along the said boundary, the eastern boundary of Block I, Haast Pass Survey District, across the Burke River to the north-western boundary of Section 819; thence along the north-western and south-western boundaries of said section to the eastern boundary of Block I, Haast Pass Survey District; thence along the said boundary and the southern boundaries of said block and Blocks IV, III, II, and I of Governor's Pass Survey District, the western boundary of said Block I, the southern boundary of Block XVI, the western boundaries of Blocks

XVI and XII, Okuru, to the south-western boundary of Section 2519; thence along the said boundary, across a road reserve and the south-western boundaries of Sections 2520 and 2521, across a road reserve and the southern and eastern boundaries of Section 2522, the latter produced to the Haast River; thence along the left bank of the said river to a point in line with the western boundary of Section 2625; thence to and along said boundary and the southern boundary of the said section and the southern and eastern boundaries of Section 2626, the latter produced to the Haast River; thence along the said river to a point in line with the north-western boundary of Section 2585; thence by said boundary and the south-western boundaries of Sections 2585 and 2586 and the southern and eastern boundaries of Section 2587, the latter produced to the Haast River; thence again along the left bank of the Haast River to a point in line with the north-western boundary of Reserve 175; thence to and along said boundary and the south-western boundary of said reserve to the point of commencement. As the same is delineated on sheet 31, roll plan 450, deposited in the Head Office, Department of Lands and Survey, at Wellington.

All that area of Crown land in Blocks X, XI, XIII, XIV, XV, XVI, Arnot Survey District, Blocks I, II, III, IV, V, VI, VII, IX, X, XI, XII, XIII, XIV, XV, XVI, Matakake Survey District, Block XII, Okuru Survey District, and Block XIII, Clarke Survey District, in the Westland Land District, being Reserve 1688, containing by admeasurement 88,000 acres, more or less. Commencing at the north-western corner of Section 2528 and proceeding easterly along the northern boundary of said section and Section 880; thence along the north-eastern and south-eastern boundaries of Section 880 to the northern boundary of Education Endowment Reserve 121; thence along the northern, eastern, south-eastern, and south-western boundaries of said reserve to the south-eastern corner of Section 2667; thence along the north-eastern boundaries of said section and Section 2666 to its most northerly corner; thence along the north-western boundary of said section, across a road reserve, and along the north-western boundaries of Sections 2664, 2658, 2657, 2654, and 2653, the latter produced to the Haast River; thence along the right bank of the Haast River to the eastern boundary of Block XIII, Clarke Survey District; thence by the said boundary and the northern boundary of said block, the eastern and northern boundaries of Block XII, Matakake Survey District, the eastern boundary of Block VII, Matakake Survey District and the southern and eastern boundaries of Block IV to the Moeraki River; thence along the left bank of the said river to Ferry Reserve 235; thence along the south-western boundary of the said section; thence to and along the northern boundary of Block IV, Matakake Survey District to the western boundary of a national endowment area; thence by the said boundary to the mouth of the Moeraki River; thence along the sea-coast to the mouth of the Waits River; thence along the left bank of the said river to a point in line with the south-western boundary of Reserve 328; thence to and along the said boundary and the eastern boundary of said reserve to the northern boundary of Block I, Matakake Survey District; thence along the said northern boundary and the western and southern boundaries of said block to the north-western boundary of Education Endowment Reserve 121; then along the said boundary and the northern boundary of said reserve and the western boundary of Section 2528 to the point of commencement. As the same is delineated on sheet 31, roll plan 450, deposited in the Head Office, Department of Lands and Survey, at Wellington.

Save and excepting thereout a national-endowment area of 3,100 acres and all roads and tracks.

All that area of Crown land in Block VIII, Otumotu Survey District, Blocks I, II, III, V, VI, VII, VIII, IX, X, XI, XII, XIV, XV, XVI, Abbey Rocks Survey District, and Block XIII, Mount Douglas Survey District, in the Westland Land District, being Reserve 1687, containing 65,000 acres, more or less. Commencing at the most westerly corner of Section 905, and proceeding along the south-western boundaries of Sections 905 and 1733, the latter produced along a national endowment boundary to the western boundary of Section 2712; thence along the western, southern, and eastern boundaries of said section to the Paringa River; thence along the left bank of the said river to the eastern boundary of Block XII, Abbey Rocks Survey District; thence along said boundary to the north-west corner of Block XIII, Mount Douglas Survey District; thence by the northern, eastern, and southern boundaries of the said block and the southern boundary of Block XVI, Abbey Rocks Survey District, to the Moeraki River; thence along the right bank of the Moeraki River to the Main South Road; thence across the said road and again by the right bank of the said river to a point in line with the southern boundary of Native Reserve 348; thence to and along the said boundary and the eastern boundary of said reserve to its most northerly

corner; thence due west to the shores of Lake Moeraki; thence by the shores of Lake Moeraki and again by the right bank of the Moeraki River to the sea-coast; thence along the sea-coast to a point in line with the western boundary of Section 1834; thence to and along the said boundary and the southern boundary of the said section to a road reserve, and along that reserve to a point in line with the southern boundary of Section 1954; thence across the said road reserve to and along the southern boundary and the eastern boundary of the said section to the most southerly corner of Section 1952; thence along the south-easterly boundaries of Sections 1952, 1821, across a road reserve and a creek, and again a road reserve, and thence along the south-eastern, the north-eastern, and north-western boundaries of Section 1833, and the north-eastern and north-western boundaries of Section 1952, and the eastern boundary of Section 1834 produced to the sea-coast; thence along the sea-coast to the northern boundary of Block II, Abbey Rocks Survey District; thence along the northern boundaries of Blocks II and III, Abbey Rocks Survey District, to the north-western boundary of Section 884; thence along the western and southern boundaries of said section produced to the Paringa River; thence along the left bank of the said river to a point in line with the western boundary of Section 1493; thence to and along the western and south-western boundaries of said section to a road reserve; thence along the western side of said road reserve to a point in line with the south-western boundary of Section 1577; thence across the said road reserve to and along the south-western boundary of Section 1577 to the most northerly corner of Section 905; thence along the north-western boundary of the said section to the point of commencement. As the same is delineated on sheet 32, roll plan 450, deposited in the Head Office, Department of Lands and Survey, at Wellington.

Save and excepting Lakes Raseelas and Paringa, and Reserves 330 and 331, and all roads and tracks.

All that area of Crown land in Blocks III, IV, and VIII, Abbey Rocks Survey District, and Block I, Mount Douglas Survey District, in the Westland Land District, being Reserve 1686, containing by admeasurement 9,420 acres, more or less. Commencing at the most northerly corner of Native Reserve 319, proceeding along the north-easterly and south-eastern boundaries of said reserve, the latter produced to the Paringa River; thence along the right bank of the said river to the northern side of the Main South Road; thence along the said roadside to the boundary of Block VIII, Abbey Rocks Survey District; thence along the said eastern boundary and 7000 links along the eastern boundary of Block IV, Abbey Rocks Survey District; thence along a national endowment reserve boundary to the northern boundary of Block I, Mount Douglas Survey District; thence due west along the said northern boundary and the northern boundaries of Blocks IV and III, Abbey Rocks Survey District, to the Paringa River; thence along the right bank of the said river to a point in line with the north-western boundary of Native Reserve 319; thence to and along the said boundary to the point of commencement. As the same is delineated on sheet 32, roll plan 450, deposited in the Head Office, Department of Lands and Survey, at Wellington.

All that area of Crown land in Blocks VII and XI, Bruce Bay Survey District, in the Westland Land District, being Reserve 1685, containing by admeasurement 940 acres, more or less. Commencing at the north-western corner of Section 890, and proceeding along its western boundary produced to the Makawhio River; thence along the right bank of the said river to a point in line with the northern boundary of Native Reserve 786; thence to and along the said northern boundary produced to the sea-coast; thence along the sea-coast to a point in line with the south-western boundary of Native Reserve 780; thence along the said boundary and the south-eastern and north-eastern boundaries of the said reserve, the latter produced to the sea-coast; thence to Big Rock Creek, and along the right bank of the said creek to the Manakiaua River; thence by the left bank of the said river to the west side of Hunt's Beach Road; thence by the said roadside to the north-eastern boundary of Section 890; and thence along the said boundary to the point of commencement. As the same is delineated on sheet 32, roll plan 450, deposited in the Head Office, Department of Lands and Survey, at Wellington.

All that area of Crown land in Block IV, Bruce Bay Survey District, and Blocks I and V, Karangarua Survey District, in the Westland Land District, being Reserve 1684, containing by admeasurement 1,325 acres, more or less. Commencing at the south-western corner of Block I, Karangarua Survey District, and proceeding in a south-easterly direction to the most westerly corner of Section 908; thence along the north-eastern boundaries generally of Sections 908 and 1982, Block V, Karangarua Survey District; thence along the left

bank of the said river to a point in line with the south-eastern boundary of Ferry Reserve 232; thence to and along the said boundary to the most southerly corner of said reserve; thence due south to the southern boundary of Block IV, Bruce Bay; thence due east to the point of commencement. As the same is delineated on sheet 32, roll plan 450, deposited in the Head Office, Department of Lands and Survey, at Wellington.

All that area of Crown land in Blocks I, II, III, V, VI, VII, IX, X, and XI, Karangarua Survey District, in the Westland Land District, being Reserve 1683, containing by admeasurement 39,500 acres, more or less. Commencing at the north-western corner of Block I, Karangarua Survey District, and proceeding south along the western boundary of said block to the Karangarua River; thence along the right bank of the said river to a point in line with the western boundary of Section 909; thence to and along the western and the north-western boundary of said section, across a road reserve, and again along the said north-western boundary and the north-western boundaries of Sections 913, 914, 915, the eastern boundary of Section 915, across Cook Road to Karangarua Road, along the north-eastern boundary of Reserve 337; thence by the south-eastern boundaries of the said reserve and Sections 917, 918, 912, and the eastern side of Copeland Road and the eastern boundary of Section 2574 to its south-east corner; thence by a right line to the north-east corner of Section 2575, and along the northern boundary of said section produced to the Karangarua River; thence by the right bank of the said river to the southern boundary of Block IX, Karangarua Survey District; thence by the southern boundaries of said Block IX, the southern boundary of Block X, the southern and eastern boundaries of Block XI, the eastern boundary of Block VII, and the eastern boundary of Block III, all in the Karangarua Survey District, to Cook River; thence along the left bank of the said river to the northern boundary of Block II, Karangarua Survey District; and thence due west to the point of commencement. As the same is delineated on sheet 32, roll plan 450, deposited in the Head Office, Department of Lands and Survey, at Wellington.

All that area of Crown land in Block XIII, Gillespie's Survey District, in the Westland Land District, being Reserve 1682, containing by admeasurement 500 acres, more or less. Commencing on the right bank of Ometamata River at its mouth, and proceeding north along the sea-coast to the mouth of Cook River; thence along the left bank of the said river to a national-endowment-reserve boundary; thence due west to the Ometamata River; and thence along the right bank of the said river to the point of commencement. As the same is delineated on sheet 32, roll plan 450, deposited in the Head Office, Department of Lands and Survey, at Wellington.

All that area of Crown land in Blocks XV and XVI, Wataroa Survey District, and Blocks I, II, III, IV, V, VII, VIII, and VIII, Waitangitona Survey District, in the Westland Land District, being Reserve 1681, containing by admeasurement 51,800 acres, more or less. Commencing at the south-west corner of Block V, Waitangitona Survey District, and proceeding due east along the southern boundaries of said block and Blocks VI, VII, and VIII of the said survey district to the south-eastern corner of the said Block VIII, Waitangitona Survey District; thence due north along the eastern boundaries of Blocks VIII and IV of the said survey district, and for 16200 links along the eastern boundary of Block XVI, Wataroa Survey District; thence due west to the western boundary of the said block; thence due south to the south-eastern corner of Block XV, Wataroa Survey District; thence along the southern boundary of the said block to and across the Wataroa River; thence along the west bank of the said river to a point in line with the south-western boundary of Ferry Reserve 1244; thence to and along the said south-western boundary and across a road reserve to the eastern boundary of the Township of Rohutu; thence along the said eastern boundary to its south-eastern corner; thence along the southern boundary of Scenic Reserve 1195 to the Waitangitona River; thence along the right bank of the said river and the left bank of a creek to a point in line with the eastern boundary of Section 2814; thence along the eastern boundary of said section, across a road reserve, Gaunt Creek, and again a road reserve, and thence along the south-eastern boundary of Section 2815 and line produced across Darnley Creek; thence along the left bank of the said creek and the left bank of the Waitangitona River to a point in line with the southern boundary of Section 2532; thence to and along the said boundary and along the south-west boundaries generally of Sections 2532, 2181, and Scenic Reserve 1225, to the northern boundary of Block I, Waitangitona Survey District; thence along the said boundary to the north-west corner of the said block; thence south along the western boundaries of Blocks I and V of the said survey district to the point of commencement. As the same is delineated on sheet 33, roll plan 450, deposited

in the Head Office, Department of Lands and Survey, at Wellington.

Excepting therefrom Sections 2183 and 3169. All that area of Crown land in Blocks X, XI, XII, XIII, XIV, XV, and XVI, Poerua Survey District, in the Westland Land District, being Reserve 1680, containing by admeasurement 32,150 acres, more or less. Commencing at the north-western corner of Block X, Poerua Survey District, and proceeding south along the western boundary of the said block, 17750 links; thence due west to the western boundary of Block IX of the said survey district; thence along the western boundary of the said Block IX to its south-western corner, and along the western boundary of Block XIII, 15500 links; thence due east to the left bank of the Lambert River; thence along the left bank of the said river to its junction with the Wanganui River; thence along the left bank of the said Wanganui River to the northern boundary of Block XI, Poerua Survey District; thence due west to the point of commencement. As the same is delineated on sheet 33, roll plan 450, deposited in the Head Office, Department of Lands and Survey, at Wellington.

All that area of Crown land in Block XIII, Wanganui Survey District, Block IV, Wataroa Survey District, and Block I, Poerua Survey District, in the Westland Land District, being Reserve 1679, containing by admeasurement 2,380 acres, more or less. Commencing at the north-western corner of Section 2246, and proceeding along its western boundary and across a road reserve to the northern boundary of Section 2250; thence along the said northern boundary across a road reserve, and along the northern boundary of Section 2249, across a road reserve, and again by the said northern boundary to a point in line with the north-eastern boundary of Section 2829; thence to and along that boundary, across a road reserve, and along the north-eastern boundary of Section 2830 to the northern boundary of Block IV, Wataroa Survey District; thence along the said northern boundary to its north-east corner, and along the northern boundary of Block I, Poerua Survey District, for 4000 links; thence in a north-easterly direction by a right line to the most westerly corner of Section 2267; thence by the south-western boundary of said section across Haddock Road, and by the western boundary of Section 169 and the northern boundaries of Sections 2247 and 2246, to the point of commencement. As the same is delineated on sheet 33, roll plan 450, deposited in the Head Office, Department of Lands and Survey, at Wellington.

All that area of Crown land in Blocks X, XI, and XV, Waimea Survey District, in the Westland Land District, being Reserve 1678, containing by admeasurement 6,300 acres, more or less. Commencing at the south-eastern corner of Section 3258 and proceeding along the eastern boundary of that section to the boundary of Section 3230; thence along the south-western boundary of said section for 1000 links; thence due south to the northern boundary of Block XV, Waimea Survey District; thence due east along said boundary to the north-eastern corner of said Block XV, Waimea Survey District; thence due south along the eastern boundary to the south-eastern corner of said Block XV, Waimea Survey District; thence due west for 17500 links; thence due north 10500 links; thence due west 7500 links to the western boundary of Block XV, Waimea Survey District; thence along said boundary to its north-western corner; thence west along the southern boundary of Block X, Waimea Survey District, to the east side of the Stafford-Chesterfield track; thence along the east side generally of said track to the south-western corner of Section 3258; thence along the southern boundary of said section to the point of commencement. As the same is delineated on sheet 48, roll plan 450, deposited in the Head Office, Department of Lands and Survey, at Wellington.

Save and excepting thereout the Township of Goldsborough, Sections 2012, 1457, 1579, 1456, Callaghan's School-site, Reserve 137, and all roads and tracks.

All that area of Crown land in Blocks VI, VII, X, XIII, and XIV, Otira Survey District, in the Westland Land District, being Reserve 1677, containing by admeasurement 8,450 acres, more or less. Commencing at the south-western corner of Block XIII, Otira Survey District, and proceeding along its southern boundary to the left bank of the Rolleston River; thence along the said river bank to the eastern boundary of Block XIII, Otira Survey District; thence by a right line to the north-east corner of railway reserve; thence by the northern and western boundary of the said Grey-mouth-Otira Railway Reserve to the right bank of Kelly's Creek; thence along the said creek bank to a point in line with the western boundary of Section 802; thence to and along the said boundary and the northern boundary of the said section to the northern and western boundaries of Section 2038, and again along the Grey-mouth-Otira Railway Reserve to the south-western corner of Section 3166, and

along the north-western boundary of that section, and again by the said railway reserve to the eastern boundary of Section 2007; thence along that boundary and the eastern boundary of Section 3337, and again along the eastern boundary of the said Section 2007 to its south-eastern corner; thence due east 15600 links; thence due south 4000 links; thence south-west 31,400 links; thence due south to the northern boundary of Block XIV, Otira Survey District; thence along the said block boundary and the northern and eastern boundaries of Block XIII, Otira Survey District, to the point of commencement. As the same is delineated on sheet 49, roll-plan 450, deposited in the Head Office, Department of Lands and Survey, at Wellington.

Excepting therefrom Reserve No. 1105.

All that area of Crown land in Blocks VI, VII, VIII, IX, X, and XI, Turiwhate Survey District, in the Westland Land District, being Reserve 1676, containing by admeasurement 14,700 acres, more or less. Commencing at the south-western corner of Block X, Turiwhate Survey District, and proceeding in a north-easterly direction to the south-western corner of Block VIII, Turiwhate Survey District; thence along the southern boundary of the said block 18900 links; thence due north 7200 links; thence north-west to the southern boundary of Section 2396; thence 2200 links along the said southern boundary to the most westerly corner of said section, and 800 links along the north-western boundary of the said section, and again in a north-westerly direction to a point on the western boundary of Block VIII of the Turiwhate Survey District, 14800 links north of the south-western corner of the said Block VIII, Turiwhate Survey District; thence north-east to the Seven-mile Track, and along the southern side of that track to the south-eastern boundary of Section 2046, and along that boundary and the south-eastern boundaries of Sections 3302 and 1591, and across a road reserve to the Taipo River, and again a road reserve to the most easterly corner of Section 2081; thence along the southern boundary of that section and the eastern, southern, and western boundaries of Section 3191, and the southern boundaries of Section 2974, the latter produced to Griffin's Creek; thence along the right bank of the said creek to a point in line with the southern boundary of Section 3066; thence along that boundary produced across Harrington Creek, and along the left bank of the said creek to the south-eastern boundary of Section 2056; thence along that boundary and the eastern boundary of Section 2981, and along the said eastern boundary and the southern boundary of the said section to its most westerly corner; thence south-easterly 2400 links; thence south-westerly to the north-eastern boundary of Section 2204 at a point distant 1000 links from the north-eastern corner of the said section; thence along the said boundary and the south-easterly and south-westerly boundaries of the said section, the latter for 2400 links, again in a south-westerly direction to the northern boundary of Section 3069, and along the said northern boundary and the south-eastern boundary of the said section to the eastern boundary of Reserve 145; thence along the said reserve boundary to the southern boundary of Block IX, Turiwhate Survey District, and along that boundary to the point of commencement. As the same is delineated on sheet 49, roll plan 450, deposited in the Head Office, Department of Lands and Survey, at Wellington.

All that area of Crown land in Blocks V and IX, Turiwhate Survey District, in the Westland Land District, being Reserve 1675, containing by admeasurement 1220 acres, more or less. Commencing at Trig. N.D. on the north-eastern boundary of Reserve 145, and proceeding in a south-easterly direction along the said boundary 15000 links; thence in a north-easterly direction on bearing of about 55° 30', 9300 links; thence in a north-westerly direction to the western boundary of Block V, Turiwhate Survey District, 24200 links; thence along the said block boundary 5400 links to the north-eastern boundary of Reserve 145, and along the said boundary to the point of commencement. As the same is delineated on sheet 49, roll plan 450, deposited in the Head Office, Department of Lands and Survey, at Wellington.

All that area of Crown land in Blocks XII and XVI, Ahaura Survey District, and Block IV, Kopara Survey District, in the Westland Land District, being Reserve 1674, containing by admeasurement 9,050 acres, more or less. Commencing at the point of intersection of the western boundary of Block XII, Ahaura Survey District, with the left bank of the Ahaura River, then proceeding due south along the said western boundary and the western boundaries of Block XVI, Ahaura Survey District, and Block IV, Kopara Survey District, to the shores of Lake Ahaura; thence south-easterly and south-westerly along the shores of the said lake to the western boundary of Block IV, Kopara Survey District; thence due east for 18000 links; thence by a right line in a north-easterly direction to a point 4400 links due west of the north-eastern corner of the said Block IV, Kopara Survey

District; thence westerly along the northern boundary of said Block IV, Kopara Survey District, 5600 links; thence due north to the Ahaura River; thence by the left bank of the said river to a point in line with the southern boundary of Section 1, Block XII, Ahaura Survey District; thence to and along the said southern boundary produced to the Ahaura River; thence along the left bank of the said river to point of commencement. As the same is delineated on sheet 34, roll plan 450, deposited in the Head Office, Department of Lands and Survey, at Wellington.

All that area of Crown land in Blocks XI, XII, and XVI, Mount Bonar Survey District, and Blocks IX, X, XIII, and XIV, Whitcombe Pass Survey District, in the Westland Land District, being Reserve 1673, containing by admeasurement 15,000 acres, more or less. Commencing at the north-eastern corner of Block XI, Mount Bonar Survey District, and proceeding due west to the Main South Road; thence generally along the east side of the said road to the Wanganui River; thence by the right bank of the said river to the eastern boundary of Block XIV, Whitcombe Pass Survey District; thence due north to the north-eastern corner of the said block; thence along the eastern boundary of Block X for 5000 links; thence due west to the western boundary of Block IX, Whitcombe Pass Survey District; thence by a right line to point of commencement. As the same is delineated on sheet 48, roll plan 450, deposited in the Head Office, Department of Lands and Survey, at Wellington.

All that area of Crown land in Blocks III, IV, VII, and VIII, Mount Bonar Survey District, Blocks I, II, V, and VI, Whitcombe Pass Survey District, and Block XIV, Totara Survey District, in the Westland Land District, being Reserve 1672, containing by admeasurement 38,500 acres, more or less. Commencing at the south-eastern corner of Block VI, Whitcombe Pass Survey District, and proceeding north along the eastern boundaries of Blocks VI and II to the Kakaputahi River; thence by the left bank of the said river to a point in line with the south-eastern boundary of Section 2291; thence to and along the said boundary and the southern boundaries of said section and Section 2292 to the western boundary of Block XIV, Totara Survey District; thence along the eastern boundary of the said block and the northern boundary of Block I, Whitcombe Pass Survey District, to Section 932; thence along the eastern boundaries of Sections 932 and 933 to the south-eastern corner of the latter section; thence from the said corner by a right line to the south-east corner of Section 2456; thence along the southern boundary of said section generally by the western boundaries of Sections 2456, 2455, 2429, across a road reserve, and 2428 to the northern boundary of Block IV, Mount Bonar Survey District; thence along the said northern boundary and the northern boundary of Block III, of the said survey district, to Scenic Reserve 1191; thence along the eastern and southern boundaries of said reserve to the Main South Road; thence along the east side of the said road to the north-west corner of Reserve 363; thence along the northern, eastern, and southern boundaries of the said reserve, and again by the said Main South Road to the north-eastern corner of Section 2346, and along the eastern boundaries generally of Section 2346 produced to Evans Creek; thence along the right bank of Evans Creek to a point in line with the eastern boundary of Section 2348; thence to and along the eastern boundary of said section across Karnbach Road, and along the eastern and southern boundary of Section 2349 to a point in line with the eastern boundary of Reserve 363A; thence across a road and along the said eastern and southern boundaries of the said section to the Main South Road, and along the eastern side of that road to the southern boundary of Block VII, Mount Bonar Survey District; thence along the southern boundary of that block and Block VIII, of the said survey district, and Blocks V and VI, Whitcombe Pass Survey District, to the point of commencement. As the same is delineated on sheet 48, roll plan 450, deposited in the Head Office, Department of Lands and Survey, at Wellington.

All that area of Crown land in Blocks XII, XI, XV, and XVI, of the Waitaha Survey District, in the Westland Land District, being Reserve 1671, containing by admeasurement 2,320 acres, more or less. Commencing at the south-western corner of Section 2193 and proceeding along the south-eastern boundary of said section, the south-eastern boundary of Scenic Reserve 1189, and the south-western boundary of Section 935 to the northern boundary of Block XVI, Waitaha Survey District; thence due west along the said block boundary 4000 links; thence by a right line to a point 7500 links due north of the south-west corner of Scenic Reserve 1191; thence by the eastern boundary of said Scenic Reserve to the south-eastern corner of Scenic Reserve 1190; thence by the south-eastern, north-eastern, and north-western boundaries of said Reserve 1190 and the north-eastern boundary of Scenic Reserve 1191 to the north-east corner of said reserve; thence along the northern boundary of said reserve produced 4500 links; thence by a right line to



**ATTACHMENT 2C - MCLEAN COMPANY LIMITED LAND**



**RECORD OF TITLE  
UNDER LAND TRANSFER ACT 2017  
FREEHOLD  
Search Copy**



**Identifier** **306023**  
**Land Registration District** **Westland**  
**Date Issued** 04 July 2008

**Prior References**  
WS8A/449

---

<b>Estate</b>	Fee Simple
<b>Area</b>	229.8670 hectares more or less
<b>Legal Description</b>	Section 1-4 Survey Office Plan 11859 and Lot 2 Deposited Plan 376096

**Registered Owners**  
McLean Company Limited

---

**Interests**

Subject to Section 11 Crown Minerals Act 1991  
Subject to Part IV A Conservation Act 1987  
Appurtenant to Sections 1-3 SO 11859 and Lot 2 DP 376096 is a right of way and a right to transmit electricity and telecommunications specified in Easement Certificate 104918 - 7.6.1996 at 11:00 am  
Subject to a right of way and a right to transmit electricity and telecommunications over Section 1 SO 11859 marked B on DP 3319 specified in Easement Certificate 104918 - 7.6.1996 at 11:00 am  
Mining Permit embodied in Register CT WS7C/107 - 28.1.1998 at 11:00 am (affects part Section 2 SO 11859)  
6325276.2 Mortgage to Rabobank New Zealand Limited - 25.2.2005 at 9:00 am  
Subject to Section 241(2) Resource Management Act 1991 (affects DP 376096)  
10454827.1 Variation of Mortgage 6325276.2 - 3.6.2016 at 4:27 pm  
11310674.1 CAVEAT BY WESTPOWER LIMITED - 7.12.2018 at 10:37 am

---

Transaction Id  
Client Reference jmathieson004

Search Copy Dated 30/04/24 2:30 pm, Page 1 of 4  
Register Only

Identifier 306023

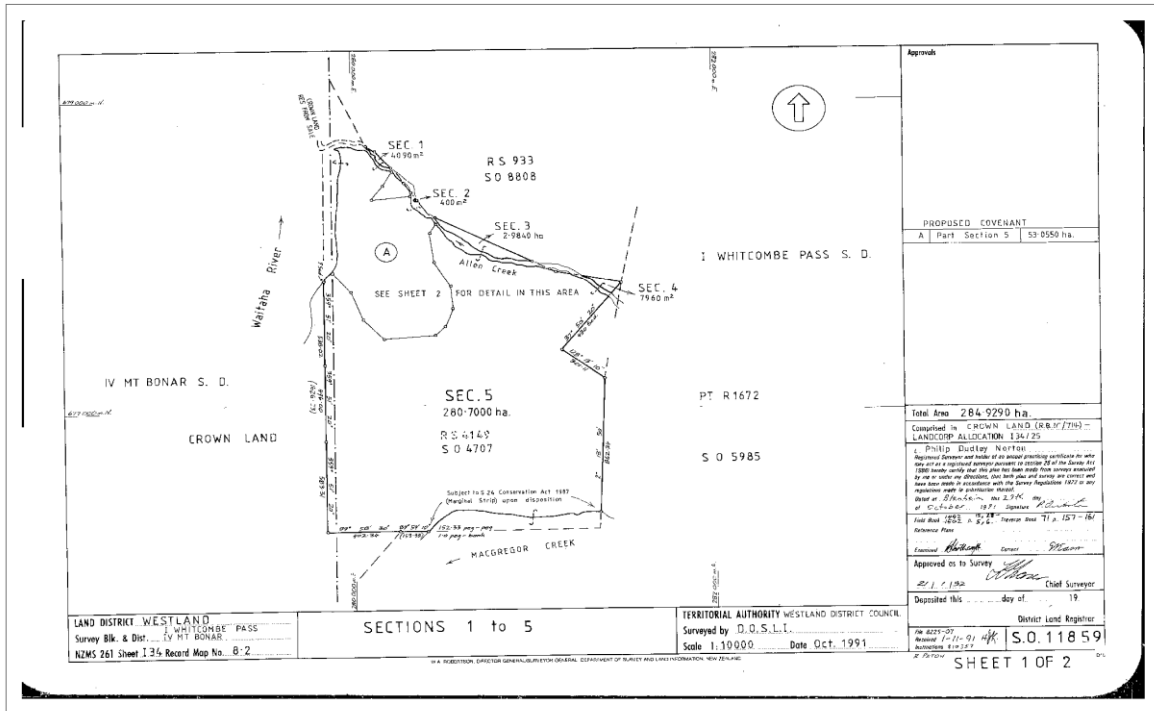

Identifier 306023

