

Appendix One



**RECORD OF TITLE
UNDER LAND TRANSFER ACT 2017
FREEHOLD
Search Copy**



R. W. Muir
Registrar-General
of Land

Identifier **NA114A/611**
Land Registration District **North Auckland**
Date Issued 11 September 1997

Prior References
NA79C/558

Estate Fee Simple
Area 2744 square metres more or less
Legal Description Lot 1 Deposited Plan 183125
Registered Owners
Viaduct Harbour Holdings Limited

Interests

C966339.1 Conservation Covenant pursuant to Section 77 Reserves Act 1977 - 12.3.1996 at 2:35 pm
D193360.2 Consent Notice pursuant to Section 221(1) Resource Management Act 1991 - 11.9.1997 at 3.31 pm (DP 183125)
Subject to a pedestrian right of way over part marked G and a support right over parts marked I and J and to a party wall right over part marked K on DP 183125 specified in Easement Certificate D193360.4 - 11.9.1997 at 3.31 pm
Appurtenant hereto is a party wall right specified in Easement Certificate D193360.4 - 11.9.1997 at 3.31 pm
The easements specified in Easement Certificate D193360.4 are subject to Section 243 (a) Resource Management Act 1991
Subject to a light and air right over parts marked F and H on DP 183125 created by Transfer D193360.5 - 11.9.1997 at 3.31 pm
Appurtenant hereto is a support right over part Common Property created by Transfer D520806.1 - produced 5.7.2000 at 2.32 pm and entered 14.7.2000 at 9.00 am (affects Lease D219070.1)
10012950.7 Mortgage to ASB Bank Limited - 15.4.2015 at 3:52 pm
11214756.1 Lease in renewal of Lease D219070.1 Term 20 years commencing 11.09.2017 (right of renewal) CT 873335 issued - 21.12.2018 at 2:08 pm
12056662.1 Variation of Lease 11214756.1 - 21.4.2021 at 3:44 pm





**RECORD OF TITLE
UNDER LAND TRANSFER ACT 2017
FREEHOLD
Search Copy**



R. W. Muir
Registrar-General
of Land

Identifier **NA128C/787**
Land Registration District **North Auckland**
Date Issued 07 June 2000

Prior References

NA21C/73 NA34B/1461

Estate	Fee Simple
Area	4730 square metres more or less
Legal Description	Lot 5 Deposited Plan 63972 and Lot 1 Deposited Plan 78340

Registered Owners

Precinct Properties Holdings Limited

Interests

The provisions of the Auckland Harbour Board Central Area Properties Redevelopment Act 1965 are applicable hereto
Appurtenant hereto is a right of way specified in Easement Certificate A593556 - 22.10.1971 at 10.33 am (affects part formerly CT NA21C/73)

Appurtenant hereto is a right of way and a drainage right specified in Easement Certificate 621087.3 - 10.8.1976 at 9.34 am (affects part formerly CT NA34B/1461)

Subject to an electricity right (in gross) over parts marked B and C on DP 90196 in favour of The Auckland Electric Power Board created by Transfer 859774.1 - 7.7.1980 at 2.20 pm

Appurtenant hereto is a right of way specified in Easement Certificate D047202.1 - 19.9.1996 at 3.50 pm (affects part formerly CT NA34B/1461)

Subject to a right of way over parts marked B, C, D and E and to a projection right over part marked H on DP 173192 specified in Easement Certificate D047202.1 - 19.9.1996 at 3:50 pm

Subject to a right of way (in gross) over parts marked C and D and to a support right over parts marked D and F on DP 173192 in favour of The Auckland City Council created by Transfer D047202.3 - 19.9.1996 at 3.50 pm

Subject to a right of way (in gross) over parts marked B and E on DP 173192 in favour of The Auckland City Council created by Transfer D047202.4 - 19.9.1996 at 3.50 pm

Appurtenant hereto is a right of way specified in Easement Certificate D230984.1 - 23.12.1997 at 1.18 pm

D554743.1 CERTIFICATE PURSUANT TO SECTION 37 BUILDING ACT 1991 - 3.11.2000 AT 12.39 PM

D617734.1 Covenant pursuant to Section 108 Resource Management Act 1991 by The Auckland City Council - 29.6.2001 at 2.23 pm

Subject to an electricity easement (in gross) for electricity cables and access over parts marked B, C and E and for electricity purposes over part marked D on DP 313894 in favour of Vector Limited created by Transfer 6582569.2 - 22.9.2005 at 9:00 am

9431593.1 Mortgage to (now) Public Trust - 27.6.2013 at 2:34 pm

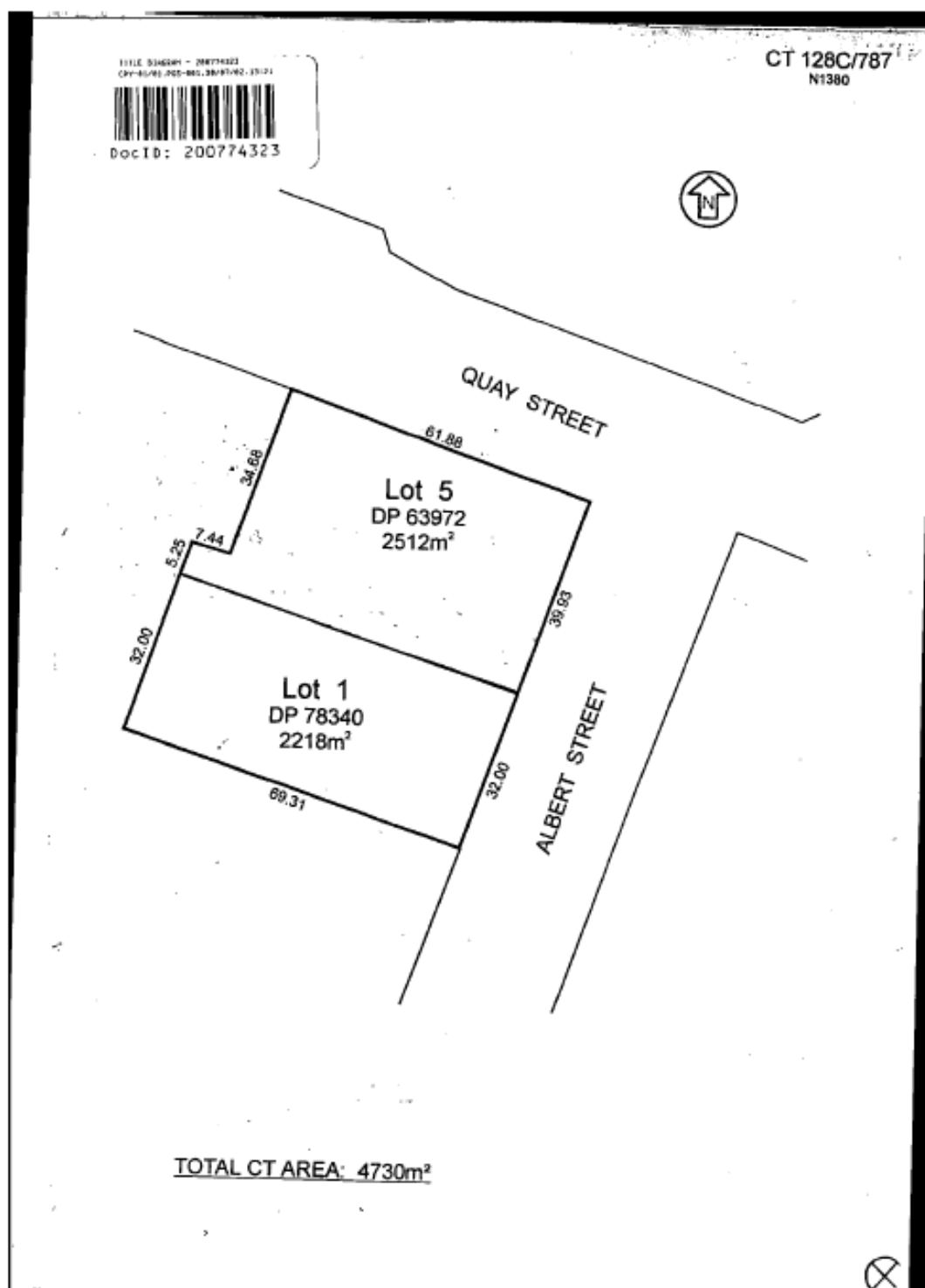



**RECORD OF TITLE
UNDER LAND TRANSFER ACT 2017
FREEHOLD
Search Copy**



R. W. Muir
Registrar-General
of Land

Identifier NA33C/37
Land Registration District North Auckland
Date Issued 28 November 1975

Prior References

NA14D/449	NA19A/1182	NA757/62
NA757/63	NA761/64	NA761/8

Estate Fee Simple
Area 3704 square metres more or less
Legal Description Lot 7 Deposited Plan 77037

Registered Owners

Precinct Properties Holdings Limited

Interests

The provisions of Auckland Harbour Board Central Area Properties Redevelopment Act 1965 apply to parts
Subject to a right of way over parts marked A & B and to drainage rights over part marked B on Plan 78340 specified in Easement Certificate 621087.3 - 10.8.1976 at 9.34 am
Subject to an electricity right (in gross) over parts marked A, D, E and F on Plan 90196 in favour of the Auckland Electric Power Board created by Transfer 859774.1 - 7.7.1980 at 2.20 pm
Subject to a right of way over part marked A on Plan 78340 and to a projection right over part marked G on Plan 173192 specified in Easement Certificate D047202.1 - 19.9.1996 at 3.50 pm
Subject to a right of way over parts marked A & B on Plan 78340 specified in Easement Certificate D230984.1 - 23.12.1997 at 1.18 pm
Subject to an electricity easement (in gross) over part marked A on DP 313894 in favour of Vector Limited created by Transfer 6582553.2 - 22.9.2005 at 9:00 am
7871831.3 Partial Surrender of the right of way specified in Easement Certificate D230984.1 - 9.7.2008 at 9:00 am
9431593.1 Mortgage to (now) Public Trust - 27.6.2013 at 2:34 pm

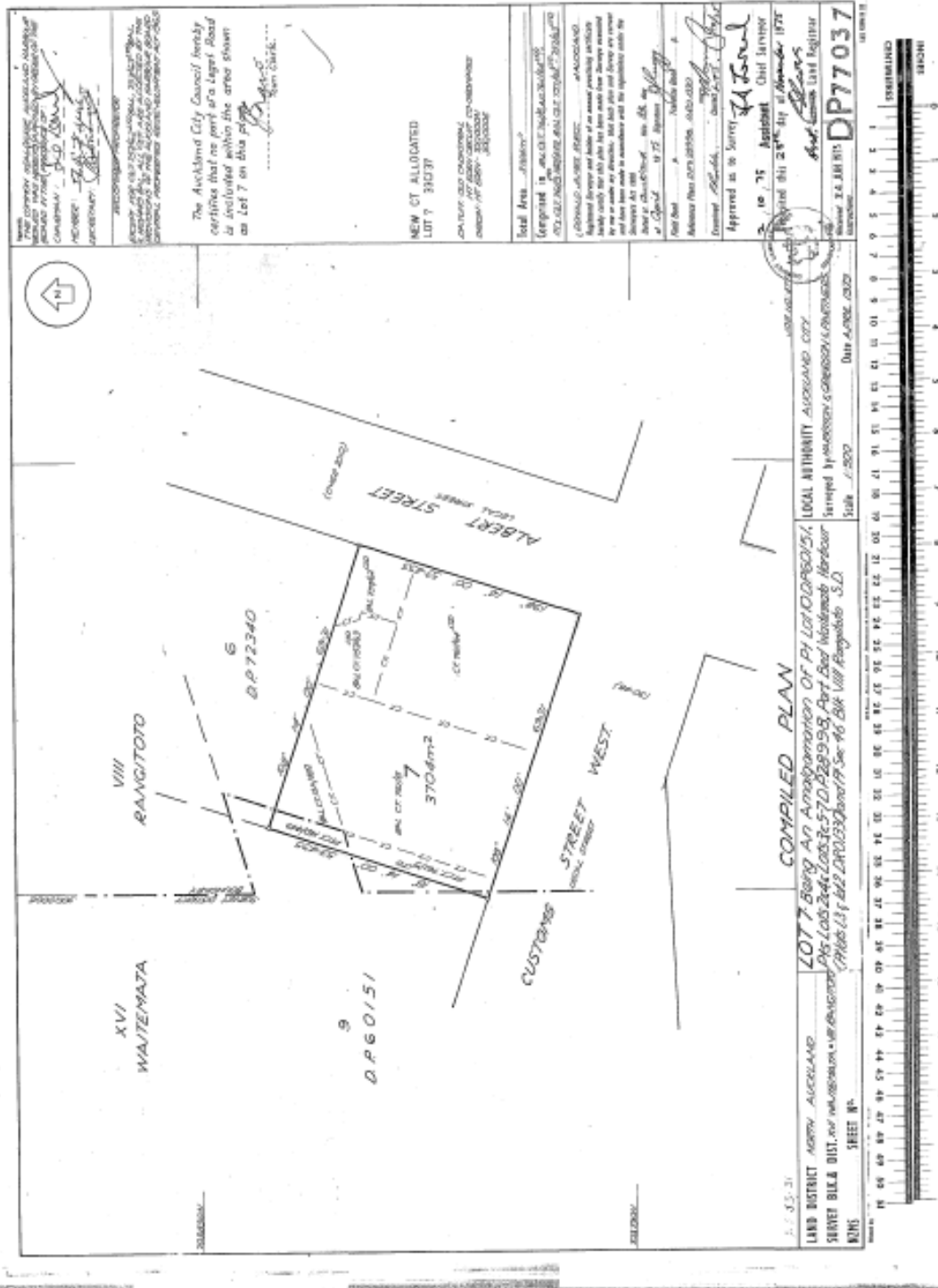



**RECORD OF TITLE
UNDER LAND TRANSFER ACT 2017
FREEHOLD
Search Copy**





R. W. Muir
Registrar-General
of Land

Identifier NA15A/424
Land Registration District North Auckland
Date Issued 26 July 1968
Prior References
NA14D/449 NA489/83 NA761/9

Estate Fee Simple
Area 6442 square metres more or less
Legal Description Lot 9 Deposited Plan 60151
Registered Owners
Auckland Council

Interests

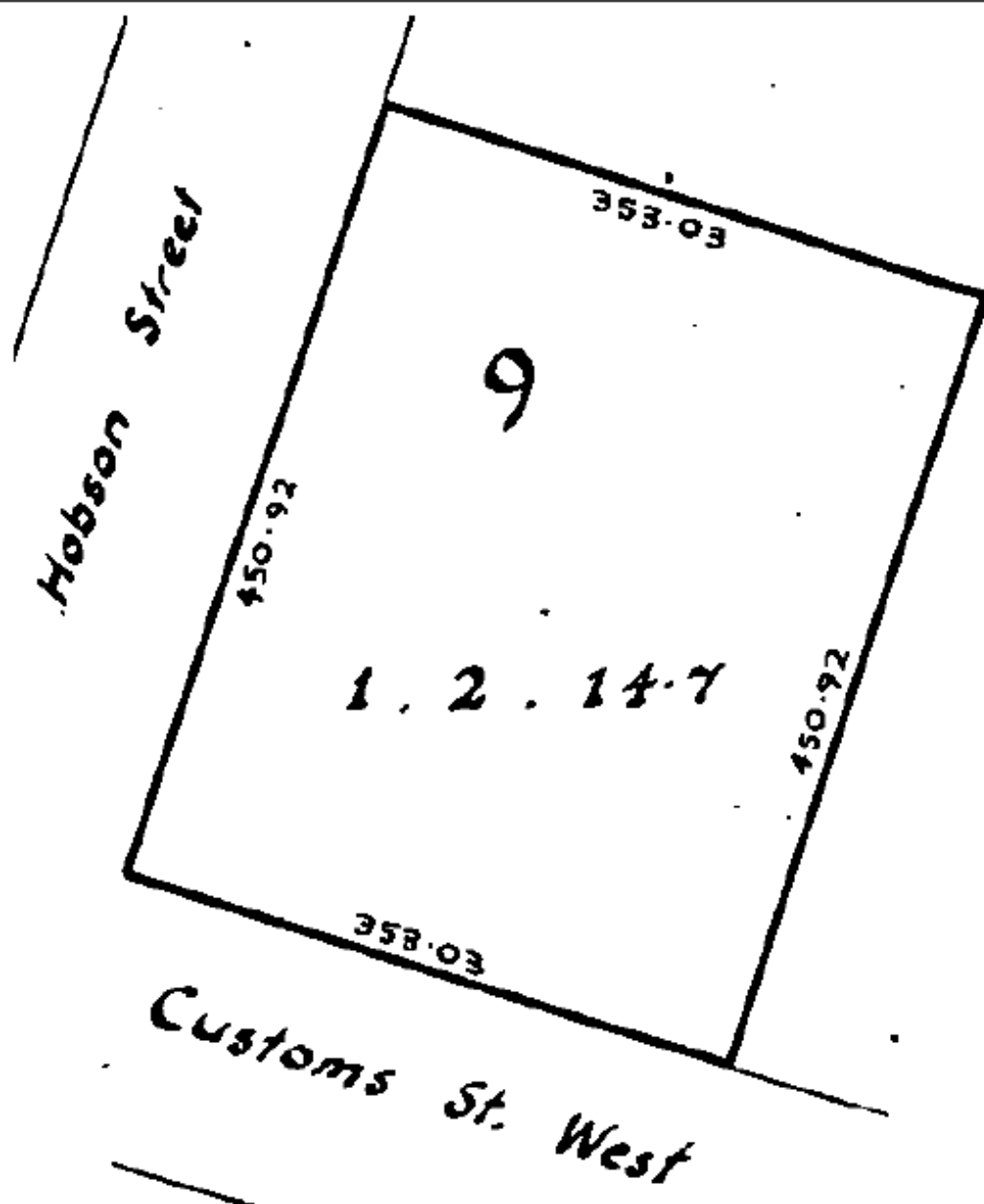
Appurtenant hereto are rights of way and projection, power cable and power transmission rights specified in Easement Certificate D047202.1 - 19.9.1996 at 3:50 pm
6461509.2 Covenant pursuant to Section 108(2)(d) Resource Management Act 1991 - 16.6.2005 at 9:00 am
11837911.1 Lease in renewal of Lease 8077373.1 Term 21 years commencing on 15.1.2020 (right of renewal) Record of Title 962310 issued - 11.9.2020 at 4:49 pm



Appendix Two

Below are a range of photos the Project, further images can be located at the Eke Panuku website:
<https://www.ekepanuku.co.nz/news/downtown-car-park-redevelopment/>

Views from Waitematā Harbour:



Spacious internal courtyards, seamlessly connecting to Britomart (through Commercial Bay) and the Viaduct:



Greater unity between the city centre and waterfront (called the "harbour edge stitch") seen below:

