



RECORD OF TITLE
UNDER LAND TRANSFER ACT 2017
FREEHOLD
Search Copy



R.W. Muir
Registrar-General
of Land

Identifier **CB29B/842**
Land Registration District **Canterbury**
Date Issued 26 September 1986

Prior References
CB785/57

Estate Fee Simple
Area 5893 square metres more or less
Legal Description Lot 2 Deposited Plan 49363
Registered Owners
Daresbury Limited

Interests

Subject to water rights granted by Deed of Easement 89850 (140 D 448)
446683 Transfer creating the following easements

Type	Servient Tenement	Easement Area	Dominant Tenement	Statutory Restriction
Sewage, water and soil	Lot 18 Deposited Plan 17795 - CT CB646/1	Part	Lot 2 Deposited Plan 49363 - herein	

452841 Transfer creating the following easement

Type	Servient Tenement	Easement Area	Dominant Tenement	Statutory Restriction
Right of way	Lot 2 Deposited Plan 49363 - herein	A DP 49363	Lot 26 Deposited Plan 18233 - CT CB706/67	

643354.3 Transfer creating the following easements in gross - 26.9.1986 at 11.15 am

Type	Servient Tenement	Easement Area	Grantee	Statutory Restriction
Right of way	Lot 2 Deposited Plan 49363 - herein	D DP 49363	The Christchurch Drainage Board	

The Right of way created by Transfer 643354.3 is subject to Section 309 (1) (a) Local Government Act 1974

643354.4 Easement Certificate specifying the following easements - 26.9.1986 at 11.15 am

Type	Servient Tenement	Easement Area	Dominant Tenement	Statutory Restriction
Drain sewage	Lot 3 Deposited Plan 49363 - CT CB29B/843	-	Lot 2 Deposited Plan 49363 - herein	
Right of way right to drain sewage & water right to convey water, power and telephonic communications	Lot 2 Deposited Plan 49363 - herein	A & B DP 49363	Lot 1 Deposited Plan 49363 - CT CB29B/841	

The easements specified in Easement Certificate 643354.4 when created will be subject to Section 309 (10) (a) Local Government Act 1974

Land Covenant in Transfer A383165.1 - 18.12.1998 at 11.11 am

6821621.1 CERTIFICATE PURSUANT TO SECTION 77 BUILDING ACT 2004 THAT THIS COMPUTER REGISTER
IS SUBJECT TO THE CONDITION IMPOSED UNDER SECTION 75(2) (ALSO AFFECTS CB29B/843) - 10.4.2006
at 9:00 am

7079450.1 Covenant pursuant to Section 108(2)(d) Resource Management Act 1991 - 20.10.2006 at 9:00 am

12238324.3 Mortgage to Tessera Nominees Limited - 15.9.2021 at 3:44 pm

Appurtenant hereto is a right of way created by Easement Instrument 12659289.9 - 1.2.2023 at 1:01 pm

. & S FORM N93

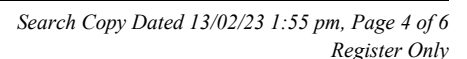

LAND TRANSFER ACT 1952

REC'D FORM N. 31

Land Transfer Office

Received.....

Title Reference ALL 178/127 Pt. 80

665/26

310 Referred to L. T. Surveyor.....

Deposited this 11th day of February 1958

of Canterbury

Land District and Registrar

RICCARTON EXT. N° 60

FENDALTON RD (M. H. 200)

Widened 25' 8" by C.T. 45/10

Crown Grant Road Originally 30' wide Made New 62' 11" 1/2 by D.P. 17795

Widened 27' 9" by Trans. 84

37800 N.

MAIN NORTH RAILWAY

DEEDS 7/6 3/8 73/12/89 C. 45469

Waimairi S.M.

Diagram not to scale

19904
IFN
ITS
A 676
25/10/1958

Plan of
Subdivision of Lots 8, 10, 11 & 12 D.P. 17795,
being Pt. R.S. 80

Comprised in..... C.T. 178/127 & C.T. 665/26

PC. Canc.

Survey Block & District Blk XI Christchurch S.D.

Land District Canterbury Local Body Waimairi County Council

Scale 80 lbs to an inch Surveyed by J. L. Davis & Son Date 23rd April '58

Michael John Wood Registered Surveyor and holder of an annual practicing certificate, do solemnly and sincerely declare that this plan has been made from surveys executed by me; that both plan and survey are correct, and have been made in accordance with the regulations under the Surveyors Act, 1936.

And I make this solemn declaration, conscientiously believing the same to be true and by virtue of the Oaths & Declarations Act 1957.

Declared at Christchurch this 23rd day of April 1958.

Before me.....

Justice of the Peace, (or Solicitor, or Magistrate)

Approved as to Survey

R. E. Schmitt
Chief Surveyor

Received 19/5/58

Reference plans D.P. 17795

Field book..... 171 p. 98

Traverse book..... 135 p. 139

Examined by W. J. Jones 16/6/58

Recorded 16/6/58

Corrected 16/6/58 L. T. Surveyor

Total Area 1. 1. 12.8

Approved

James David John
Applicant or Registered Owner

This space reserved for plan numbers

D P 19964

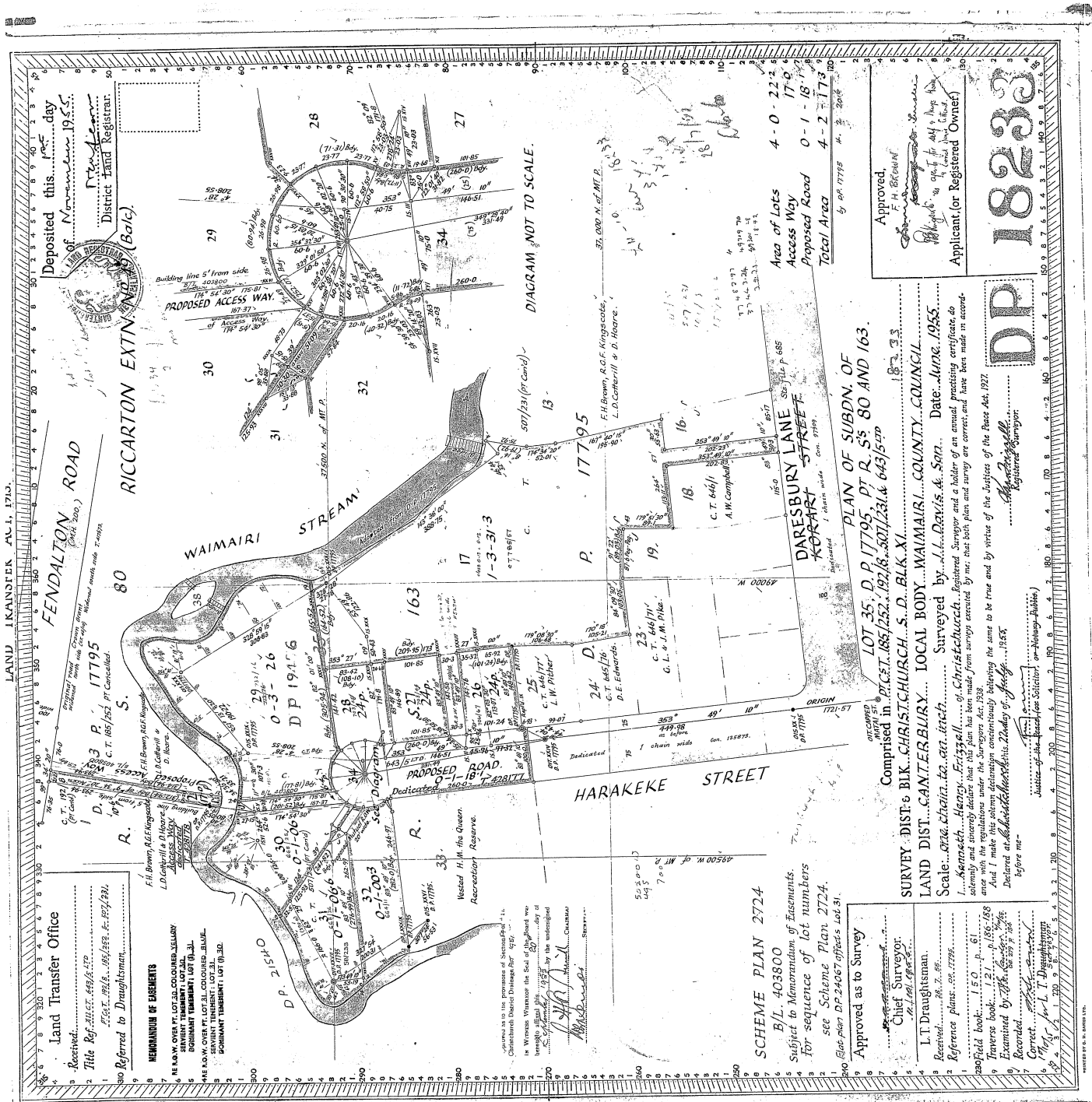



RECORD OF TITLE
UNDER LAND TRANSFER ACT 2017
FREEHOLD
Search Copy



R.W. Muir
Registrar-General
of Land

Identifier **CB29B/843**
Land Registration District **Canterbury**
Date Issued 26 September 1986

Prior References
CB785/57

Estate Fee Simple
Area 898 square metres more or less
Legal Description Lot 3 Deposited Plan 49363
Registered Owners
Daresbury Limited

Interests

Subject to water rights granted by Deed of Easement 89850 (140 D 448)
446683 Transfer creating the following easements

Type	Servient Tenement	Easement Area	Dominant Tenement	Statutory Restriction
Sewage, water and soil	Lot 18 Deposited Plan 17795 - CT CB646/1	Part	Lot 3 Deposited Plan 49363 - herein	

643354.4 Easement Certificate specifying the following easements - 26.9.1986 at 11.15 am

Type	Servient Tenement	Easement Area	Dominant Tenement	Statutory Restriction
Drain sewage	Lot 3 Deposited Plan 49363 - herein	Herein	Lot 2 Deposited Plan 49363 - CT CB29B/842	

The easements specified in Easement Certificate 643354.4 are subject to Section 309 (1) (a) Local Government Act 1974

6821621.1 CERTIFICATE PURSUANT TO SECTION 77 BUILDING ACT 2004 THAT THIS COMPUTER REGISTER IS SUBJECT TO THE CONDITION IMPOSED UNDER SECTION 75(2) (ALSO AFFECTS CB29B/842) - 10.4.2006 at 9:00 am

7079450.1 Covenant pursuant to Section 108(2)(d) Resource Management Act 1991 - 20.10.2006 at 9:00 am

12238324.3 Mortgage to Tessera Nominees Limited - 15.9.2021 at 3:44 pm

Appurtenant hereto is a right of way created by Easement Instrument 12659289.9 - 1.2.2023 at 1:01 pm

1. & S FORM N93

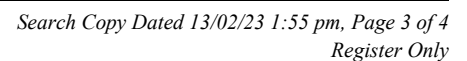

Search Copy Dated 13/02/23 1:55 pm, Page 4 of 4
Register Only