

Released under the provision of  
the Official Information Act 1982



DESIGN DRIVERS	_L101
MASTERPLAN	_ L102
STREETSCAPE LAYOUT AREA 1	_ L103
STREETSCAPE LAYOUT AREA 2	_ L104
STREETSCAPE PLANTING PLAN & SCHEDULE AREA 1	_ L105
STREETSCAPE PLANTING PLAN & SCHEDULE AREA 2	_ L106
RIPARIAN ZONE PLANITNG PLAN	_L107

*DRAFT LANDSCAPE DESIGN STRATEGY*  
BRIGHAM CREEK ROAD AND TRIG ROAD  
NEIL CONSTRUCTION LTD

SEPT 2021  
113758

DESIGN DRIVERS

STREETSCAPE

Attention to the quality and detail of these streets is critical to achieve landscape characteristics and consistency. The typologies define street character and the role of hierarchy of each street in the overall network.

At maturity, trees should reach a scale that is appropriate for the width and proportion of the street, and the height of the building frontage to the street. Growing conditions (including the size of the tree pit) should be optimised for all street trees to ensure successful establishment and growth. The spacing of trees should be minimised to achieve an avenue effect contributing to a high amenity urban environment.

The Road 1 provides a priority cycle and pedestrian route of high amenity, connecting recreational spaces within the precinct, including future parks and stream corridors, and connections to commuter cycling routes.

Road 1,2 & 3 are proposed to provide key connections through the site and between arterial routes, which will provide for pedestrian and cycle transport routes through the light industrial zone.



RIPARIAN MARGINS, WATERCOURSES & RAINGARDENS

Incorporating water sensitive design by using natural systems and processes for stormwater management to minimise adverse effects and protect and enhance the values and functions of natural ecosystems. The Stormwater facilities are to be appropriate to the scale of the proposed development. Maximising localised water collection, minimizing stormwater run- off by maximizing on-site management and disposal of stormwater.

Tree management within the riparian margin shall be carried out in accordance with the Tree3 LTD Arboricultural Report dated 13 April 2021





LEGEND

- A** EXISTING STREETS
- B** BRIDGE OVER STREAM/WETLAND
- C** RIPARIAN MARGIN
- D** STREAM
- E** RAINGARDEN DEVICE
- F** PUBLIC CYCLEWAY/FOOTPATH
- G** WETLAND
- H** PROPOSED BUSINESS LIGHT INDUSTRIAL
- I** PROPOSED RESIDENTIAL ZONE
- J** PROPOSED FUTURE AUCKLAND COUNCIL PROPOSED SPORTS PARK
- K** 1.4M BOUNDARY FENCE (SEMITRANSSPARENT)
- L** ACCESS TO PARK
- M** 3.5M SHARED PATH TO TRIG ROAD
- FUTURE ACCESS



NEIL CONSTRUCTION  
BRIGHAM CREEK RD & TRIG RD  
WHENUAPAI

L102  
MASTERPLAN

DATE  
01.09.2021

SCALE  
1:1250 @ A1, 1:2500 @ A3

DRAWN BY  
YY

CHECKED BY  
MR

REVIEWED BY  
MR

ISSUED TO MFE  
NOT FOR CONSTRUCTION

THIS DRAWING AND ITS CONTENT ARE SUBJECT TO  
COPYRIGHT AND SHALL ONLY BE USED WITH THE  
PERMISSION OF SOLA LANDSCAPE ARCHITECTS

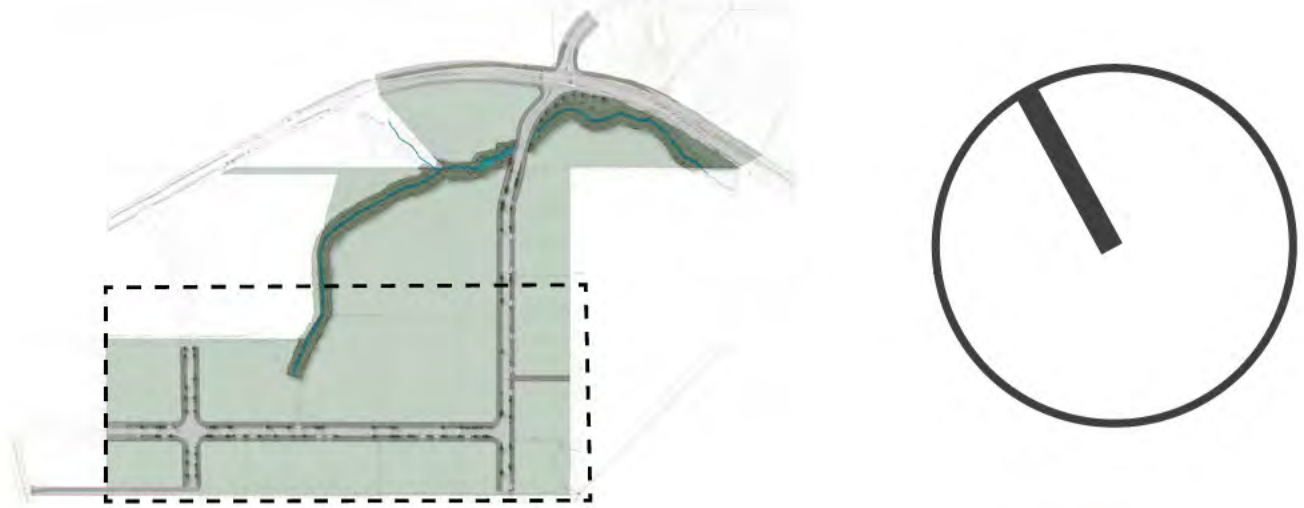

- LEGEND**
- A** STREET TREES
  - B** STREET LIGHT (INDICATIVE)
  - C** STREET GARDEN
  - D** RAINGARDEN
  - E** GRASS BERM
  - F** RIPAIRAN ZONE

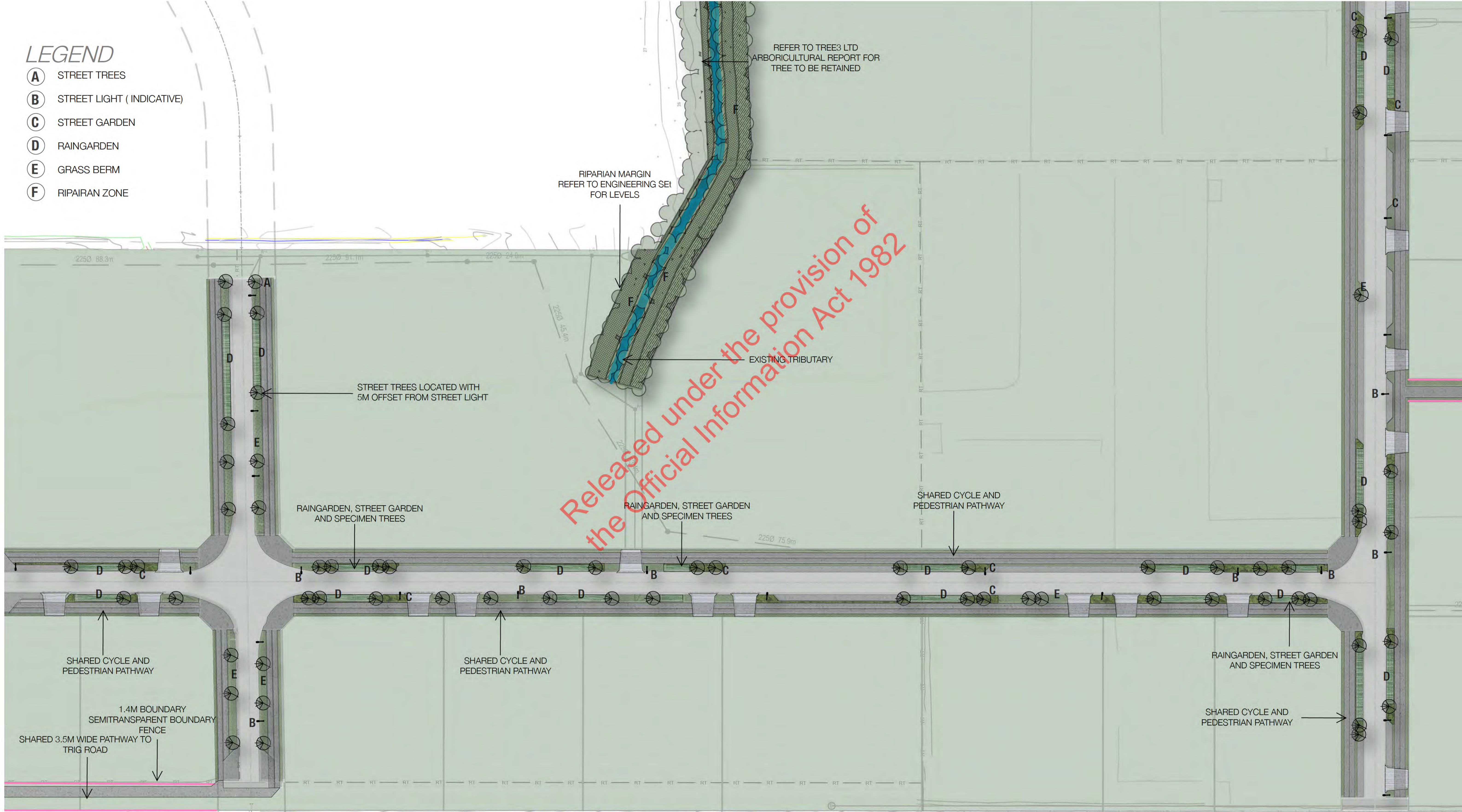

NEIL CONSTRUCTION  
BRIGHAM CREEK RD & TRIG RD  
WHENUAPAI

L103  
STREETSCAPE LAYOUT AREA 1

DATE  
01.09.2021

SCALE  
1:500 @ A1, 1:1000 @ A3

DRAWN BY  
YY

CHECKED BY  
MR

REVIEWED BY  
MR

ISSUED TO MFE  
NOT FOR CONSTRUCTION

THIS DRAWING AND ITS CONTENT ARE SUBJECT TO  
COPYRIGHT AND SHALL ONLY BE USED WITH THE  
PERMISSION OF SOLA LANDSCAPE ARCHITECTS

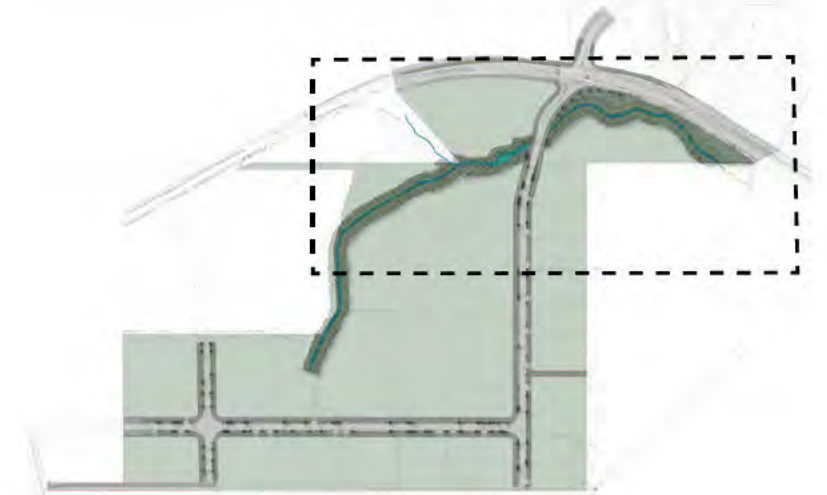

LEGEND

- A STREET TREES
- B STREET LIGHT (INDICATIVE)
- C STREET GARDEN
- D RAINGARDEN
- E GRASS BERM
- F RIPARIAN ZONE

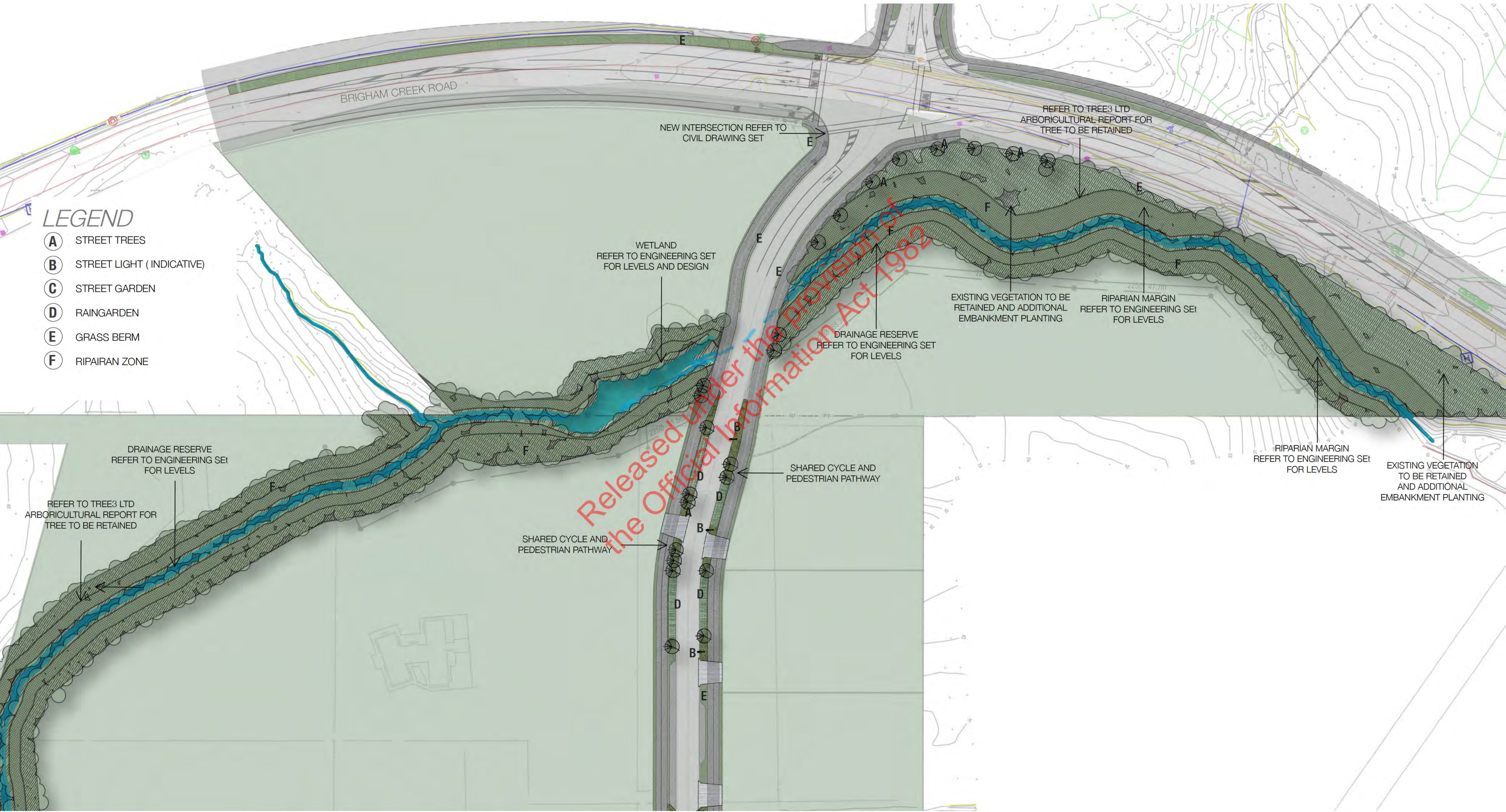

STREETSCAPE PLANTING AREA 1

STREET TREES PALETTE

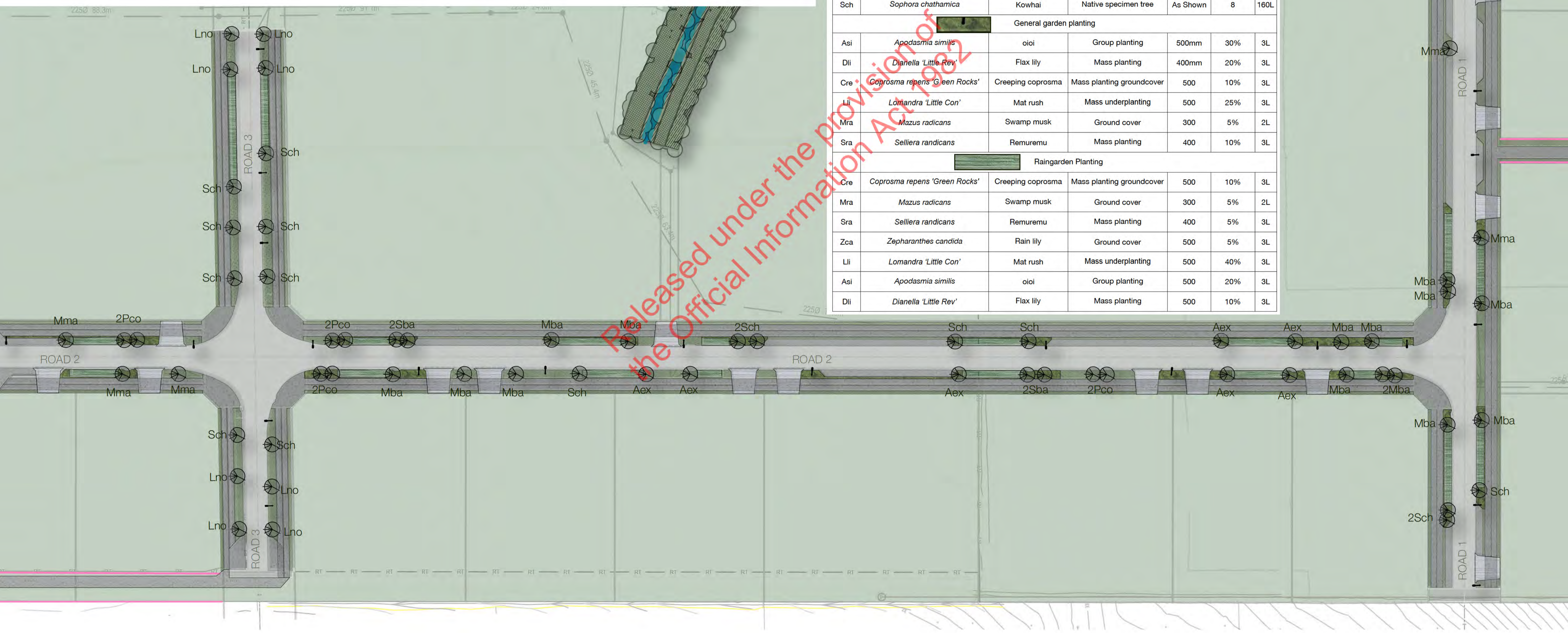

Brigham Creek & Trig Road, Whenuapai						
Streetscape Planting						
Code	Botanical Name	Common Name	Notes	Spacing (MM)	Quantity	Size
Road 1 Trees						
Pto	Podocarpus totara 'Aurea'	Golden Totara	Native specimen tree	As Shown	12	160L
Mma	Metrosideros excelsa 'Maori Princess'	Pohutukawa	Native specimen tree	As Shown	16	160L
Sch	Sophora chathamica	Kowhai	Native specimen tree	As Shown	3	160L
Mba	Metrosideros bartlettii	Bartlett's rātā	Native specimen tree	As Shown	6	160L
Road 2 Trees						
Aex	Alectryon excelsus	Titoki	Native specimen tree	As Shown	7	160L
Mba	Metrosideros bartlettii	Bartlett's rātā	Native specimen tree	As Shown	10	160L
Mma	Metrosideros excelsa 'Maori Princess'	Pohutukawa	Native specimen tree	As Shown	3	160L
Pco	Planchonella costata	Tawapou	Native specimen tree	As Shown	8	160L
Sch	Sophora chathamica	Kowhai	Native specimen tree	As Shown	5	160L
Sba	Strebulus banksii	Ewekuri	Native specimen tree	As Shown	4	160L
Road 3 Trees						
Lno	Laurelia novae-zelandiae	Pukatea	Native specimen tree	As Shown	8	160L
Sch	Sophora chathamica	Kowhai	Native specimen tree	As Shown	8	160L
General garden planting						
Asi	Apodasmia similis	oioi	Group planting	500mm	30%	3L
Dli	Dianella 'Little Rev'	Flax lily	Mass planting	400mm	20%	3L
Cre	Coprosma repens 'Green Rocks'	Creeping coprosma	Mass planting groundcover	500	10%	3L
Lli	Lomandra 'Little Con'	Mat rush	Mass underplanting	500	25%	3L
Mra	Mazus radicans	Swamp musk	Ground cover	300	5%	2L
Sra	Selliera radicans	Remuremu	Mass planting	400	10%	3L
Raingarden Planting						
Cre	Coprosma repens 'Green Rocks'	Creeping coprosma	Mass planting groundcover	500	10%	3L
Mra	Mazus radicans	Swamp musk	Ground cover	300	5%	2L
Sra	Selliera radicans	Remuremu	Mass planting	400	5%	3L
Zca	Zepharanthes candida	Rain lily	Ground cover	500	5%	3L
Lli	Lomandra 'Little Con'	Mat rush	Mass underplanting	500	40%	3L
Asi	Apodasmia similis	oioi	Group planting	500	20%	3L
Dli	Dianella 'Little Rev'	Flax lily	Mass planting	500	10%	3L



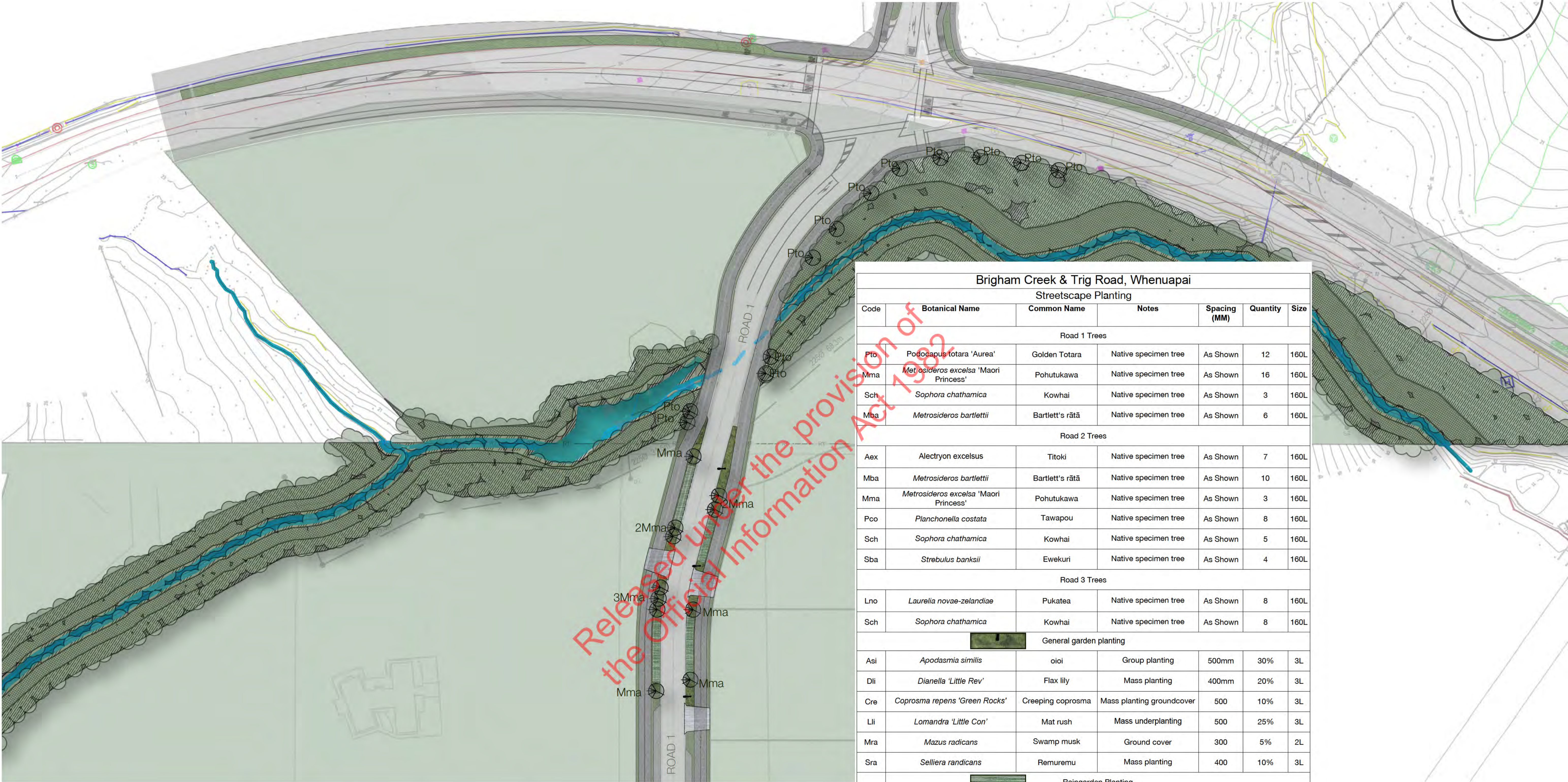

STREET TREES PALETTE



Podocarpus totara 'aurea' (Pto)



Metrosideros "Maori Princess" (Mma)



Alectryon excelsus (Aex)



Sophora chathamica (SCH)



Metrosideros bartlettii (Mba)





Laurelia novae-zealandiae (Lno)

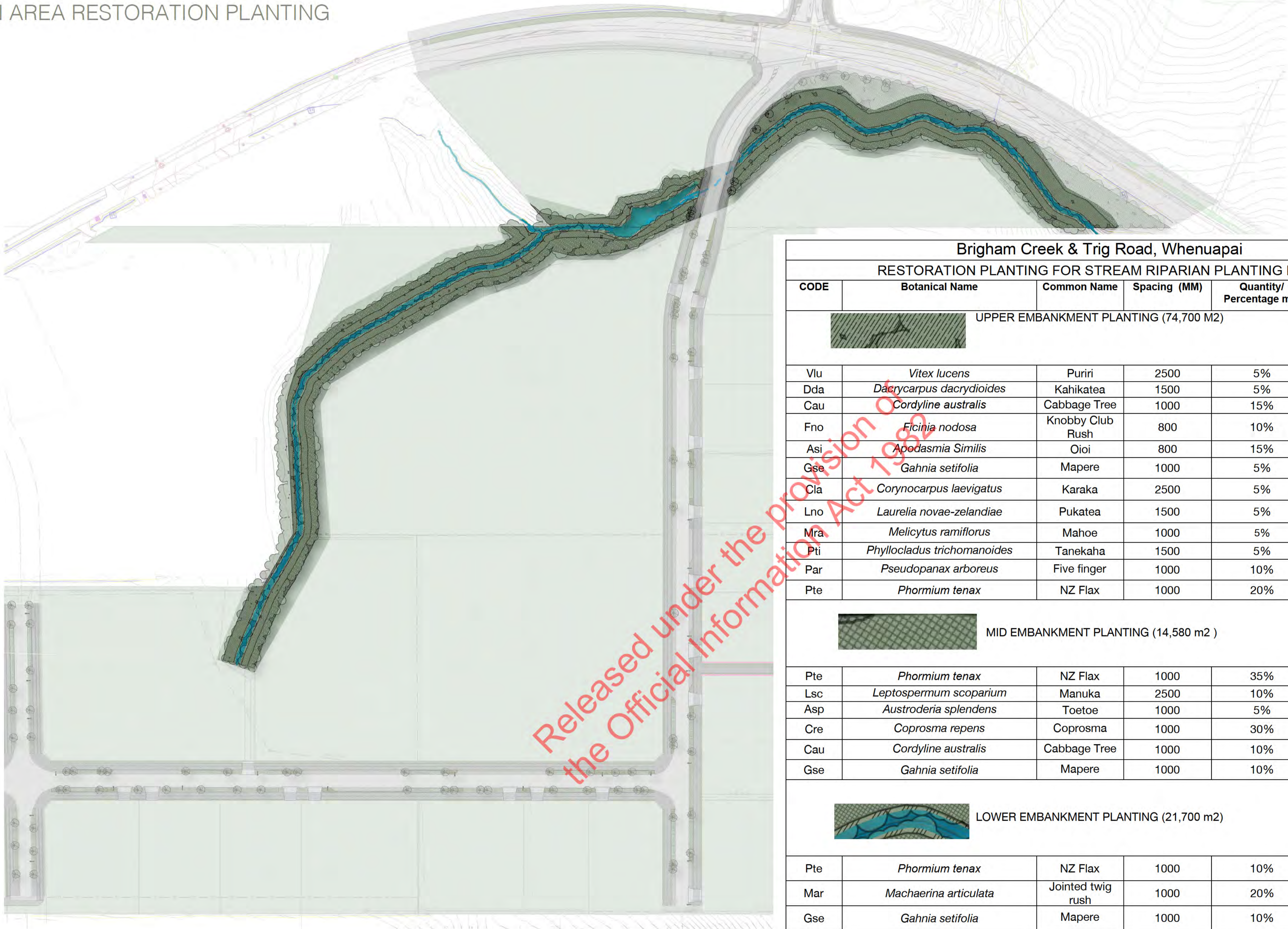

Planchonella costata (Pco)

Brigham Creek & Trig Road, Whenuapai						
Streetscape Planting						
Code	Botanical Name	Common Name	Notes	Spacing (MM)	Quantity	Size
Road 1 Trees						
Pto	Podocarpus totara 'Aurea'	Golden Totara	Native specimen tree	As Shown	12	160L
Mma	Metosideros excelsa 'Maori Princess'	Pohutukawa	Native specimen tree	As Shown	16	160L
Sch	Sophora chathamica	Kowhai	Native specimen tree	As Shown	3	160L
Mba	Metrosideros bartlettii	Bartlett's rātā	Native specimen tree	As Shown	6	160L
Road 2 Trees						
Aex	Alectryon excelsus	Titoki	Native specimen tree	As Shown	7	160L
Mba	Metrosideros bartlettii	Bartlett's rātā	Native specimen tree	As Shown	10	160L
Mma	Metrosideros excelsa 'Maori Princess'	Pohutukawa	Native specimen tree	As Shown	3	160L
Pco	Planchonella costata	Tawapou	Native specimen tree	As Shown	8	160L
Sch	Sophora chathamica	Kowhai	Native specimen tree	As Shown	5	160L
Sba	Strebulus banksii	Ewekuri	Native specimen tree	As Shown	4	160L
Road 3 Trees						
Lno	Laurelia novae-zealandiae	Pukatea	Native specimen tree	As Shown	8	160L
Sch	Sophora chathamica	Kowhai	Native specimen tree	As Shown	8	160L
General garden planting						
Asi	Apodasmia similis	oioi	Group planting	500mm	30%	3L
Dli	Dianella 'Little Rev'	Flax lily	Mass planting	400mm	20%	3L
Cre	Coprosma repens 'Green Rocks'	Creeping coprosma	Mass planting groundcover	500	10%	3L
Lli	Lomandra 'Little Con'	Mat rush	Mass underplanting	500	25%	3L
Mra	Mazus radicans	Swamp musk	Ground cover	300	5%	2L
Sra	Selliera radicans	Remuremu	Mass planting	400	10%	3L
Raingarden Planting						
Cre	Coprosma repens 'Green Rocks'	Creeping coprosma	Mass planting groundcover	500	10%	3L
Mra	Mazus radicans	Swamp musk	Ground cover	300	5%	2L
Sra	Selliera radicans	Remuremu	Mass planting	400	5%	3L
Zca	Zepharanthes candida	Rain lily	Ground cover	500	5%	3L
Lli	Lomandra 'Little Con'	Mat rush	Mass underplanting	500	40%	3L
Asi	Apodasmia similis	oioi	Group planting	500	20%	3L
Dli	Dianella 'Little Rev'	Flax lily	Mass planting	500	10%	3L

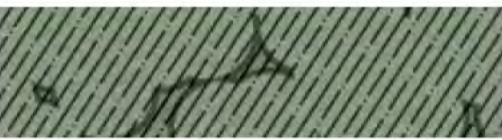

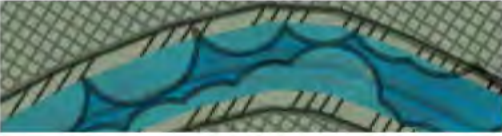
Brigham Creek & Trig Road, Whenuapai					
RESTORATION PLANTING FOR STREAM RIPARIAN PLANTING PLAN					
CODE	Botanical Name	Common Name	Spacing (MM)	Quantity/ Percentage mix	Size
<div> UPPER EMBANKMENT PLANTING (74,700 M2)</div>					
Vlu	<i>Vitex lucens</i>	Puriri	2500	5%	5L
Dda	<i>Dacrycarpus dacrydioides</i>	Kahikatea	1500	5%	3L
Cau	<i>Cordyline australis</i>	Cabbage Tree	1000	15%	1L
Fno	<i>Ficinia nodosa</i>	Knobby Club Rush	800	10%	1L
Asi	<i>Apodasmia similis</i>	Oioi	800	15%	1L
Gse	<i>Gahnia setifolia</i>	Mapere	1000	5%	5L
Cla	<i>Corynocarpus laevigatus</i>	Karaka	2500	5%	5L
Lno	<i>Laurelia novae-zelandiae</i>	Pukatea	1500	5%	5L
Mra	<i>Melicytus ramiflorus</i>	Mahoe	1000	5%	5L
Pti	<i>Phyllocladus trichomanoides</i>	Tanekaha	1500	5%	5L
Par	<i>Pseudopanax arboreus</i>	Five finger	1000	10%	1L
Pte	<i>Phormium tenax</i>	NZ Flax	1000	20%	1L
<div> MID EMBANKMENT PLANTING (14,580 m2 )</div>					
Pte	<i>Phormium tenax</i>	NZ Flax	1000	35%	1L
Lsc	<i>Leptospermum scoparium</i>	Manuka	2500	10%	1L
Asp	<i>Austroderia splendens</i>	Toetoe	1000	5%	1L
Cre	<i>Coprosma repens</i>	Coprosma	1000	30%	1L
Cau	<i>Cordyline australis</i>	Cabbage Tree	1000	10%	1L
Gse	<i>Gahnia setifolia</i>	Mapere	1000	10%	1L
<div> LOWER EMBANKMENT PLANTING (21,700 m2)</div>					
Pte	<i>Phormium tenax</i>	NZ Flax	1000	10%	1L
Mar	<i>Machaerina articulata</i>	Jointed twig rush	1000	20%	1L
Gse	<i>Gahnia setifolia</i>	Mapere	1000	10%	1L
Cvi	<i>Carex Virgata</i>	Swamp Sedge	800	20%	1L
Cle	<i>Carex lessoniana</i>	Sedge	1000	20%	1L
Gla	<i>Gahnia lacera</i>	Cutty Grass	1000	20%	1L

- NOTE:
- 1. ALL LANDSCAPE BATTERS ALONGSIDE WATERCOURSES ARE TO HAVE BIODEGRADABLE COCOA MATTING MEMBRANE PRODUCT FOR SOIL STABILISATION. REFER TO CATOBOLAM FOR DETAILS.
  - 2. REFER TO TREE3 LTD ARBORICULTURAL REPORT (13 APRIL 2021) FOR EXISTING TREES TO BE RETAINED
  - 3. REFER TO ECOLOGICAL REPORT FOR STREAM ASSESSMENT AND MITIGATION MEASURES